

Western boundary of Range IX South Middle District

beginning at the southwest corner at a post the south  
west corner of Section 4 on the 9<sup>th</sup> Range run due on the  
line notes of the same — and runs South —

South

2<sup>nd</sup> Mile South

115<sup>th</sup> To Wakatombas 56 links wide morning 210<sup>th</sup> E —  
50, 00 to 210<sup>th</sup> of the same 50 links wide morning 210<sup>th</sup> E  
00, 00 post a post where a white Oak 22 miles distant has  
200<sup>th</sup> E 14 links and a white Oak 20 miles distant has  
200<sup>th</sup> W 12 links —

2<sup>nd</sup> Mile South

20, 00 own built land would with white Oak  
00, 00 East end post a post where on Elm 10 miles west  
has 242<sup>nd</sup> W 25 links & a cherry 10 miles distant  
has 244<sup>th</sup> E 8 links distant timber mostly Cherry  
timber — very good soil —

2<sup>nd</sup> Mile South

40, 00 on hill by land post a post in corner of Section 10  
& the third Section in the north Range & distant 24  
& the 3<sup>rd</sup> Town in the tenth Range where a white  
Oak 15 miles distant has 242<sup>nd</sup> W 26<sup>th</sup> and a  
white Oak 12 miles distant has 235<sup>th</sup> E 25 links  
has marker in place —

00, 00 post a post where a white Oak 6 miles distant  
has 230<sup>th</sup> E 50 links distant and on the about 20  
3 miles distant has 234<sup>th</sup> W 40 links much less  
soil —

## West boundary of Town VIII Range IX South Middle District

South

3,150

a stream 3 tanks measuring West

0,00

a white Oak 33 inches diameter on the line

40,50

a ledge of rocks extending East &amp; West

00,00

white Oak to a black Oak 10 inches diameter measured

for the mile post timber white Oak poor soil

1<sup>st</sup> Mile South5<sup>th</sup> Mile South

00,00

two white Oak post corner to Greens 2 1/2

meters of 10 - where a white Oak 90 inches

across the line 8 1/2 ft 25 birds distant one end

highway 10 inches diameter bears 135° E 37 inches

distant three marshes four poles

Sept 20<sup>th</sup> 1797

From this East corner East

South boundary

East

5<sup>th</sup> Mile East

1103

a n highway 22 inches diameter on the line

42,50

a swampy corner with willow flags &amp;c

00,00

first a post on the swampy where an Oak 5 inches

diameter bears 100° E 90 birds distant and another 2

miles diameter bears 150° W 100 birds

2<sup>nd</sup> Mile East

02,70

to the other side of the swamp by way in a square

well to the white oak

00,00

on corner West to a swampy extending 100 ft

11,50 1/2

width

72,28

a red Oak on the line 30 inches diameter

00,00

a chestnut 24 inches diameter on the line

marked by mile post

South boundary of SOMM III. Range IX

East

3rd Mile East

33.50 a stream bluish soil runs N70°E  
 40.50 just a feet corner of sections N4°19'2" in Sec 2 &  
 N4°34' of Town 3 in the 9th Range when a large  
 23 miles diameter hole N45°E of Link's outlet and  
 a large hole 15 miles diameter hole N47°W 24 Link's  
 hole corner - muddling quality - timber white oak  
 and hick -  
 00.00 marked a black oak 24 miles diameter for mile just

4th Mile East

41.99 a white oak 24 miles diameter in the line  
~~00.00~~ marked a quarter 5 miles diameter for mile  
~~80.00\*~~ just

5th Mile East

10.20 a stream bluish soil runs S10°E  
 35.50 a stone quarry on either hand -  
 36.50 a white oak 42 miles diameter in the line  
 36.50 miles west line between 079 to Range 10 & when  
 36.50 south of the 02 corner just a feet from which  
 a white oak 25 miles diameter hole N45°E  
 24 Link's and a second hole 7 miles diameter  
 N41°E 12 Link's 2nd hole runs marked 4 miles  
 Sept 29th 1897

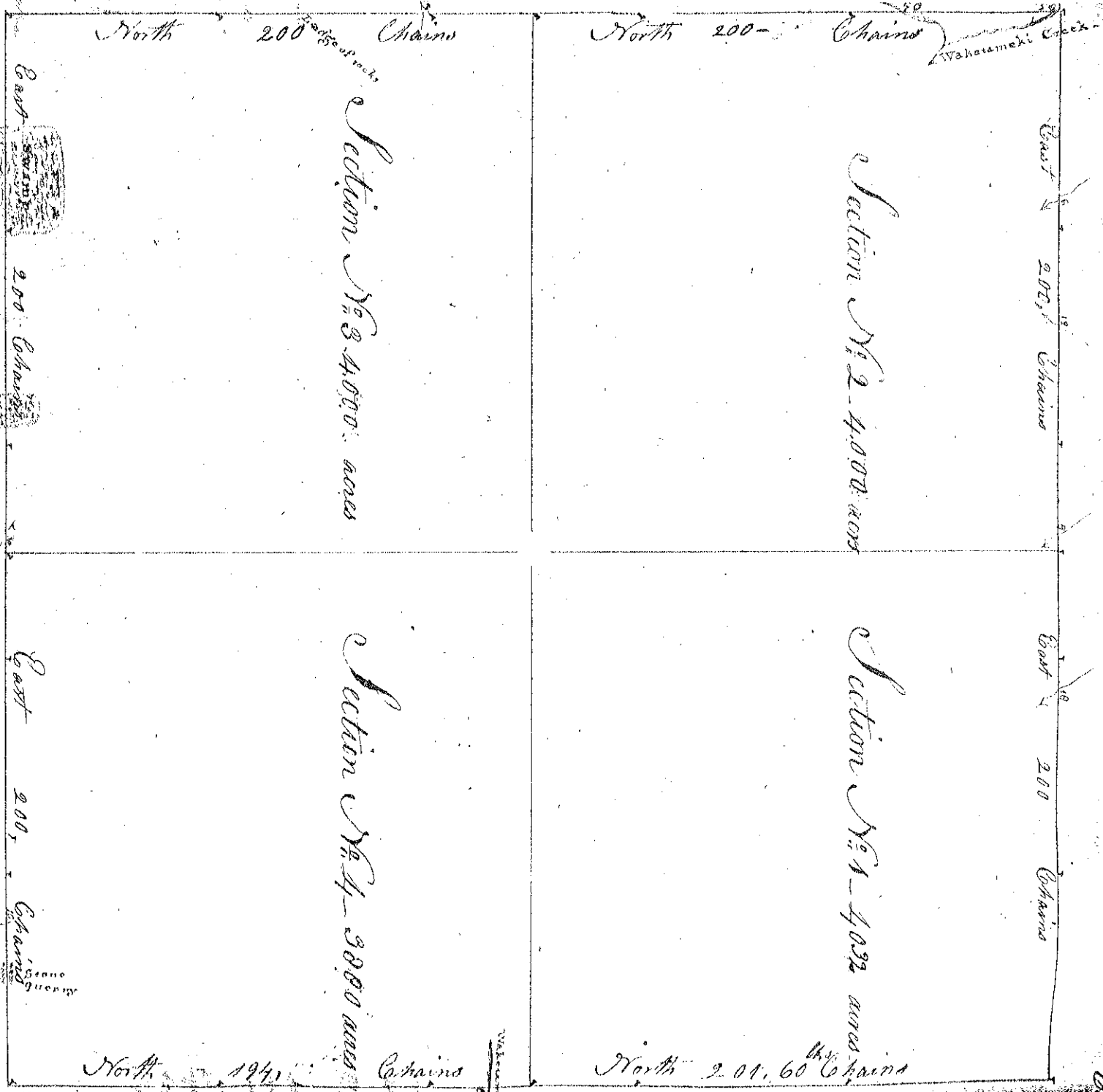

TOWNSHIP N. III RANGE N. IX