

DETOUR PLAN

DETOUR LIMITATIONS AND MAINTAINING TRAFFIC

THE CONTRACTOR SHALL BE RESPONSIBLE FOR ACCESS TO ALL PROPERTIES AT ALL TIMES. ACCESS SHALL BE MAINTAINED TO THE SATISFACTION OF THE CITY.

THE CONTRACTOR SHALL MAINTAIN ACCESS TO ALL PROPERTIES AT ALL TIMES. ACCESS SHALL BE MAINTAINED TO THE SATISFACTION OF THE CITY.

THE CONTRACTOR SHALL TAKE PRECAUTIONS TO AVOID PEDESTRIAN TRAFFIC FROM OPEN DITCHES, TRUCKS, OR CONSTRUCTION SITE HAZARDS BY PROVIDING AND FLASHING LIGHTS, AS NECESSARY, AND AS DIRECTED BY THE ENGINEER.

TWO-WAY LOCAL TRAFFIC SHALL BE MAINTAINED IN DESIGNATED AREAS AS DETAILED ON THE MAPS SHOWN ON THIS SHEET. THROUGH TRAFFIC SHALL BE MAINTAINED AS SHOWN. LIQUIDATED DAMAGES SHALL BE PAID IN ACCORDANCE WITH SECTION 108.07 OF THE CONSTRUCTION SPECIFICATIONS FOR EACH CALENDAR DAY THE ROAD IS CLOSED TO TRAFFIC BEYOND THE LIMIT SPECIFIED.

THE CONTRACTOR SHALL NOTIFY THE DISTRICT AND CITY OF ZANESVILLE SERVICE DIRECTOR IN WRITING SEVEN (7) DAYS IN ADVANCE OF THE DATE REQUIRED. THE CONTRACTOR SHALL INSTALL, MAINTAIN, AND REMOVE THE DETOUR SIGNING.

THE CONTRACTOR SHALL COVER EXISTING SIGNING WITH THE DESIGNATED DETOUR ROUTE, AS DIRECTED. PAYMENT FOR THE ABOVE, UNLESS OTHERWISE SPECIFIED, SHALL BE THE LUMP SUM BID PRICE FOR ITEM 614 - 1.

THE ENTIRE PORTION OF THIS CONTRACT (PAVING, CURBS, GUTTERS, ETC.) WHERE THE ROADWAY IS CLOSED SHALL BE COMPLETED WITHIN A SIXTY DAY TIME PERIOD. SIGNAL AND OTHER MISCELLANEOUS WORK THAT ONLY TRAFFIC MAY OCCUR PRIOR TO THIS SIXTY DAY TIME PERIOD SHALL BE COMPLETED PRIOR TO THIS SIXTY DAY TIME PERIOD. APPROPRIATE TRAFFIC CONTROL AS APPROPRIATE.

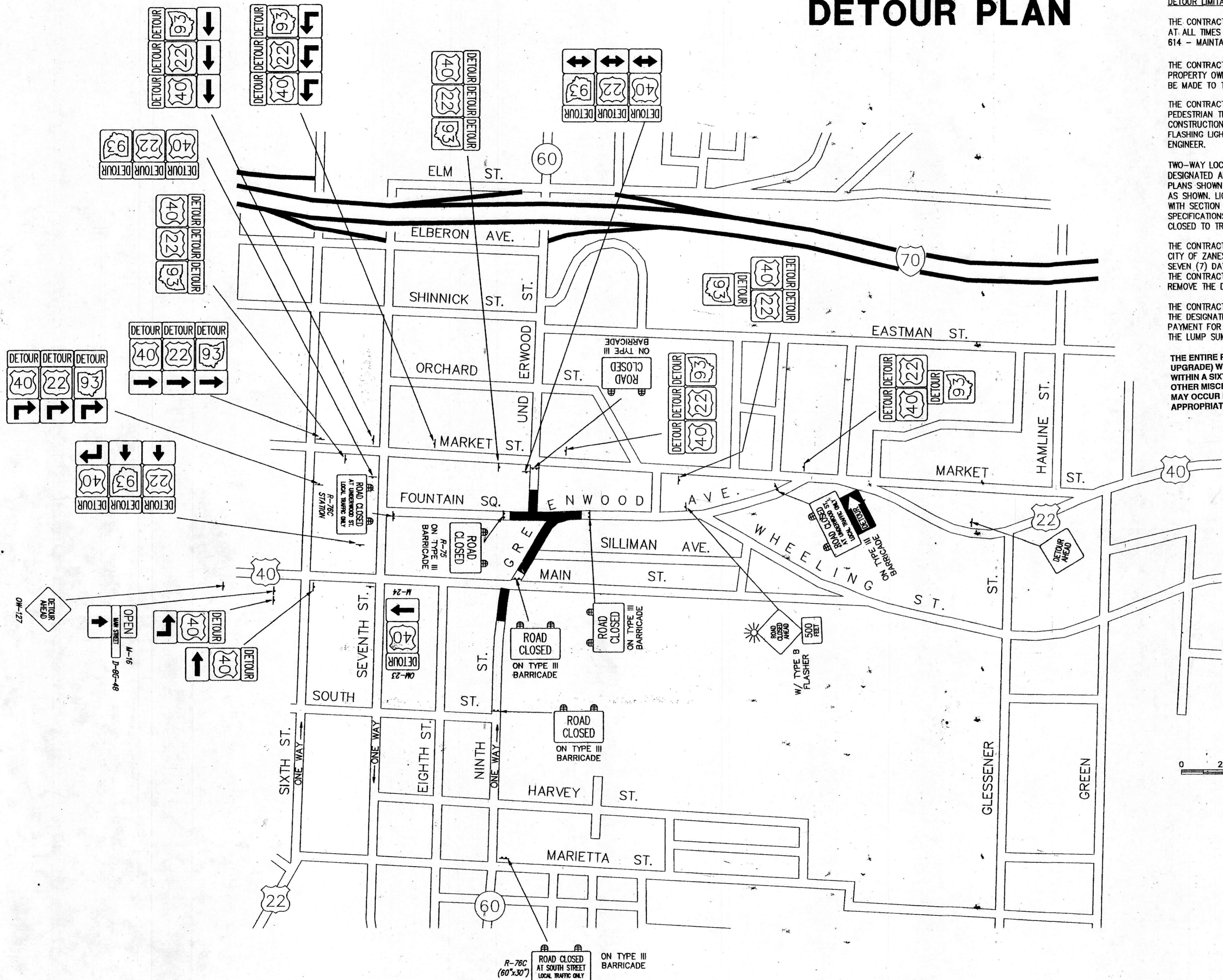

MAINTENANCE OF TRAFFIC

MUS-22-12.28

7
35