

02-20-09-01-004 B
02-30-10-03-006 B

Page 3 of 3

Description of Parcel # 3 (65.057 Acres)

A plat of the above-described survey has been submitted for file at the County Engineer's Office.

The above description prepared by Gregory A. Biedenbach, Ohio Registered Surveyor No. 7881, based on information obtained from an actual field survey of March 6, 2019. Said survey being subject to any facts that may be disclosed in a full and accurate title search.

Prior Deed: Official Records Volume 2823, Page 886.

OFFICE COPY
NOT RECORDABLE
March 6, 2019 *Gregory A. Biedenbach*
Date Gregory A. Biedenbach
Ohio Registered Surveyor
No. 7881.

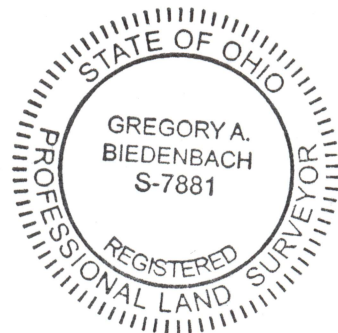

Cc: Survey File: GB-3173F

DESCRIPTION
APPROVED
By: *3/10/2019*