

lands presently owned by the Landings at ECHO Park LLC, (OR 2660-537), passing a railroad spike found at 36.86 feet;

Thence along the lines of said ECHO Park LLC lands, the following three courses;

- 1.) North 26 degrees 03 minutes 13 seconds East, 525.60 feet to an iron pin found, passing an iron pin found at 66.76 feet;
- 2.) North 63 degrees 56 minutes 24 seconds West, 350.14 feet to an iron pin found;
- 3.) North 49 degrees 26 minutes 22 seconds West, 99.99 feet to an iron pin found, on the south line of lands presently owned by Kendricks Property Management LLC, (OR 2683-723);

Thence along the lines of said Kendrick lands, the following three courses:

- 1.) North 36 degrees 04 minutes 55 seconds East, 116.32 feet to an iron pin found;
- 2.) North 32 degrees 47 minutes 16 seconds East, 80.80 feet to an iron pin found;
- 3.) North 39 degrees 20 minutes 40 seconds West, 403.53 feet to an iron pipe found on the south right of way line of St. Rte. 16;

Thence along said right of way line the following three courses:

- 1.) North 56 degrees 33 minutes 39 seconds East, 273.14 feet to an iron pin found;
- 2.) North 58 degrees 04 minutes 12 seconds East, 515.07 feet to a PK Nail found;
- 3.) North 37 degrees 39 minutes 56 seconds East, 134.85 feet to an iron pipe found on the northwest corner of said Ohio Power Lands, (DR 1085-586);

Thence along the lines of said Ohio Power lands the following two course:

- 1.) South 36 degrees 30 minutes 49 seconds East, 688.52 feet to a monument found on the section line, passing an iron pin found at 52.73 feet, and a monument at 678.65 feet;
- 2.) North 00 degrees 57 minutes 07 seconds East, 591.14 feet to the principal place of beginning, containing 47.674 acres, more or less, and being Part of Auditor's Parcel Number 10-04-04-16-002 +- 4.384 Acres, and All of Auditor's Parcel Numbers 10-04-06-01-007 +- 31.255 Acres, 10-04-05-15-000 +- 0.535 Acres, 10-04-07-09-001 +- 0.063 Acres, and 10-04-07-09-002 +- 11.437 Acres;

Subject to all legal recorded easements and right of ways.

Iron pins set are 5/8 inch rebars, 30 inches long, with plastic identification caps.

Bearings are based on the Ohio State Plane Coordinate System, NAD 83, South Zone, Grid North, as per G.P.S. observations.

This description is written based on a field survey completed December 1, 2023 by Jack D. Newcome, Reg. No. 7321

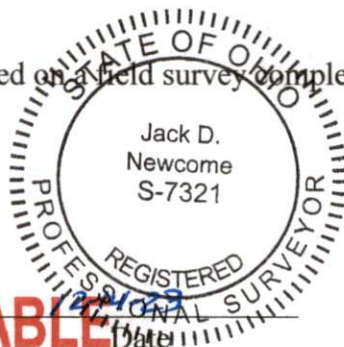

OFFICE COPY
Jack D. Newcome
Jack D. Newcome, Reg. No. 7321

NOT RECORDABLE

DESCRIPTION

APPROVED

By: *[Signature]*