

'76 MAR -2 AM 8 59

OHIO DEPARTMENTAL OR AGENCY TRANSFER
STATE OWNED LANDS

RECEIVED
DEPT. OF PUBLIC WORKS

~~XXXXXXXX~~ FILE NO. 0-40

KNOW ALL MEN BY THESE PRESENTS, That, Whereas, the OHIO DEPARTMENT OF ADMINISTRATIVE SERVICES, organized and existing under the laws of the State of Ohio, has heretofore, by virtue of various acts of the Ohio Legislature, been granted custody and control of canal lands located in the State of Ohio; and

WHEREAS, OHIO DEPARTMENT OF NATURAL RESOURCES has applied for the transfer of certain canal lands for public purposes;

NOW, THEREFORE, the OHIO DEPARTMENT OF ADMINISTRATIVE SERVICES, pursuant to Sections 123.681 and 123.682 of the Ohio Revised Code does hereby transfer and release to the OHIO DEPARTMENT OF NATURAL RESOURCES

for FISH PROPAGATION AND RECREATION purposes, its jurisdiction and control of the following described property owned by the State of Ohio:

Being that portion of the abandoned Ohio and Erie Canal lands located in Town 3 North, Range 7 West, Quarter Town 2, Cass Township, Muskingum County, State of Ohio, and more particularly described as follows:

Commencing for a point of beginning at the intersection of the North line of Muskingum County with the transit line of the G. F. Silliman Survey of the Ohio and Erie Canal Lands, said point designated as Canal Station 4293+60.68, said point being located North 89°-54'-46" East three hundred nineteen and ninety-six hundredths (319.96) feet, along the North line of Muskingum County from a "corner stone"; thence, with said transit line, South 60°-13' West three hundred sixty-four and fifty-seven hundredths (364.57) feet to an angle point; thence, South 69°-54' West two thousand one hundred ninety-eight and twenty-three hundredths (2198.23) feet to an angle point; thence, South 64°-02' West four hundred ten and ninety-two hundredths (410.92) feet to an angle point; thence, South 75°-09' West four hundred eighty-five and fifty-seven hundredths (485.57) feet to an angle point; thence, South 79°-29' West six hundred thirty-nine and thirty-eight hundredths (639.38) feet to an angle point; thence, South 88°-10' West three hundred sixteen and twenty-five hundredths (316.25) feet to an angle point; thence, South 59°-03' West twenty-four and forty hundredths (24.40) feet to a point at Canal Station 4338+00; thence, at right angles from the transit line, South 30°-57' East thirty and forty hundredths (30.40) feet to a point on the southerly canal property line at the intersection of the southerly right-of-way line of State Route 16, and being the true point of beginning; thence, along the southerly canal property line, South 61°-34'-10" West one hundred and ninety-seven thousandths (100.097) feet to a point; thence, South 56°-04'-24" West one hundred and one hundred thirty-five thousandths (100.135) feet to a point; thence, South 58°-18'-19" West one hundred and eight thousandths (100.008) feet to a point; thence, South 60°-28'-56" West one hundred and thirty-one thousandths (100.031) feet to a point; thence, South 62°-11'-54" West one hundred and one hundred fifty-one thousandths (100.151) feet to a point; thence, South 58°-45'-49" West one hundred and one thousandths (100.001) feet to a point; thence, South 56°-28'-25" West one hundred and one hundred one thousandths (100.001) feet to a point; thence, South 58°-28'-38" West one hundred and five thousandths (100.005) feet to a point; thence, South 46°-54'-59" West one hundred two and two hundred eighty-five thousandths (102.285) feet to a point; thence, South 70°-54'-36"

OHIO DEPARTMENTAL OR AGENCY TRANSFER
STATE OWNED LANDS

DESCRIPTION O-40 (CONTINUED):

feet to a point; thence, North $27^{\circ}-53'-26''$ West one hundred and three hundred nineteen thousandths (100.319) feet to a point; thence, North $21^{\circ}-35'-53''$ West one hundred and forty-five thousandths (100.045) feet to a point; thence, North $20^{\circ}-27'-15''$ West one hundred and one hundred twenty-five thousandths (100.125) feet to a point; thence, North $37^{\circ}-27'-41''$ West fourteen and nine hundred sixty-one thousandths (14.961) feet to a point; thence, North $01^{\circ}-19'-00''$ West ninety-seven and eight hundred ninety-three thousandths (97.893) feet to a point in the southerly right-of-way line of State Route 16, and crossing the transit line of the G. F. Silliman Survey at Canal Station 4373+02.76; thence, along the southerly right-of-way line of State Route 16, along the chord of a curve to the left with $D = 0^{\circ}-59'-23''$, North $81^{\circ}-32'-41''$ East one thousand four hundred twenty and eighty-five thousandths (1,420.085) feet to a point; thence, along a tangent, North $74^{\circ}-29'-02''$ East six hundred seventy-two and twenty-three thousandths (672.023) feet to a point; thence, along the chord of a curve to the right with $D = 1^{\circ}-00'-38''$, North $79^{\circ}-09'-13''$ East nine hundred seven and seven hundred eighty-four thousandths (907.784) feet to a point; thence, North $06^{\circ}-16'-45''$ West thirty and no thousandths (30.000) feet to a point; thence, along a tangent, North $84^{\circ}-09'-24''$ East seventy-seven and seven hundred ninety-two thousandths (77.792) feet to the true point of beginning, containing twenty-three and three hundred twenty-four thousandths (23.324) acres, more or less, excepting therefrom all existing highway easements, and further described as File No. O-40, as recorded in the files of the State Canal Land Authority, at Columbus, Ohio.

Further reference is made to Ohio and Erie Canal Plat Nos. 112 and 113, being plats of a part of the G. F. Silliman Survey of the Ohio and Erie Canal lands on file in the office of the Ohio Department of Administrative Services, Division of Public Works at Columbus, Ohio.

OFFICE COPY
NOT RECORDABLE

COSHOCTON CO.
MUSKINGUM CO.

VIRGINIA TWP.
CASS TWP.

TOBACCO HILL RD
Cemetery

Adams Mills

OFFICE COPY
NOT RECORDABLE

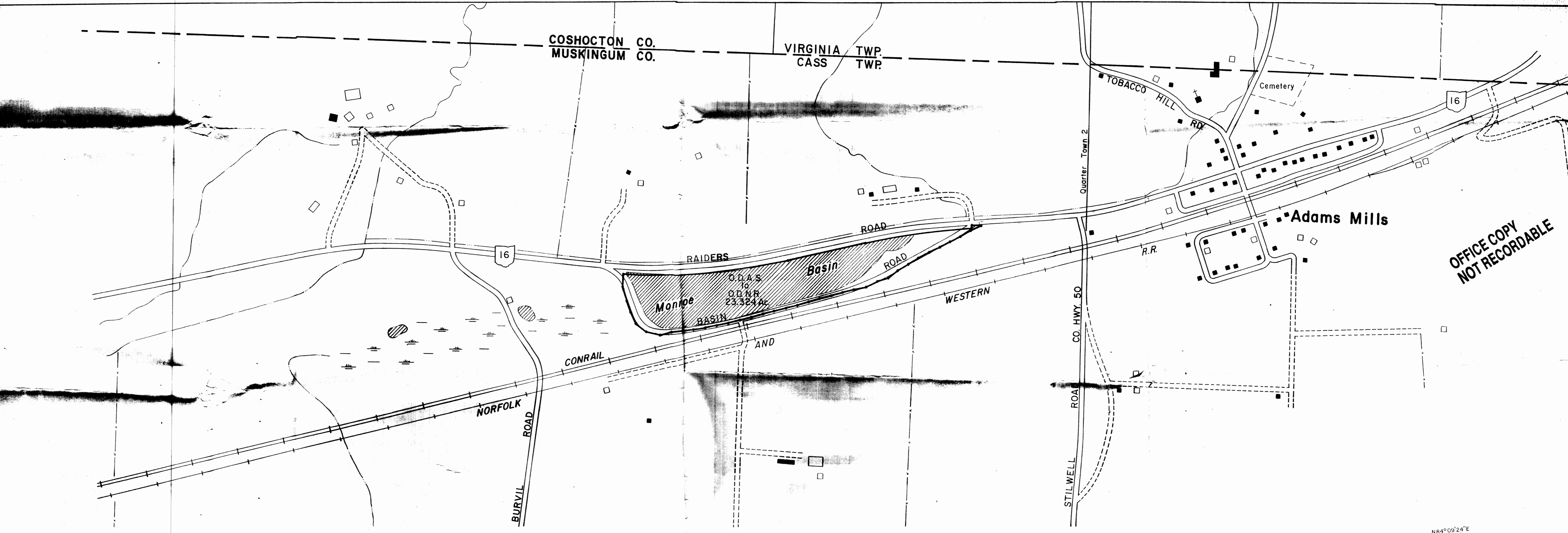

SCALE IN FEET
0 400 800
LOCATION MAP

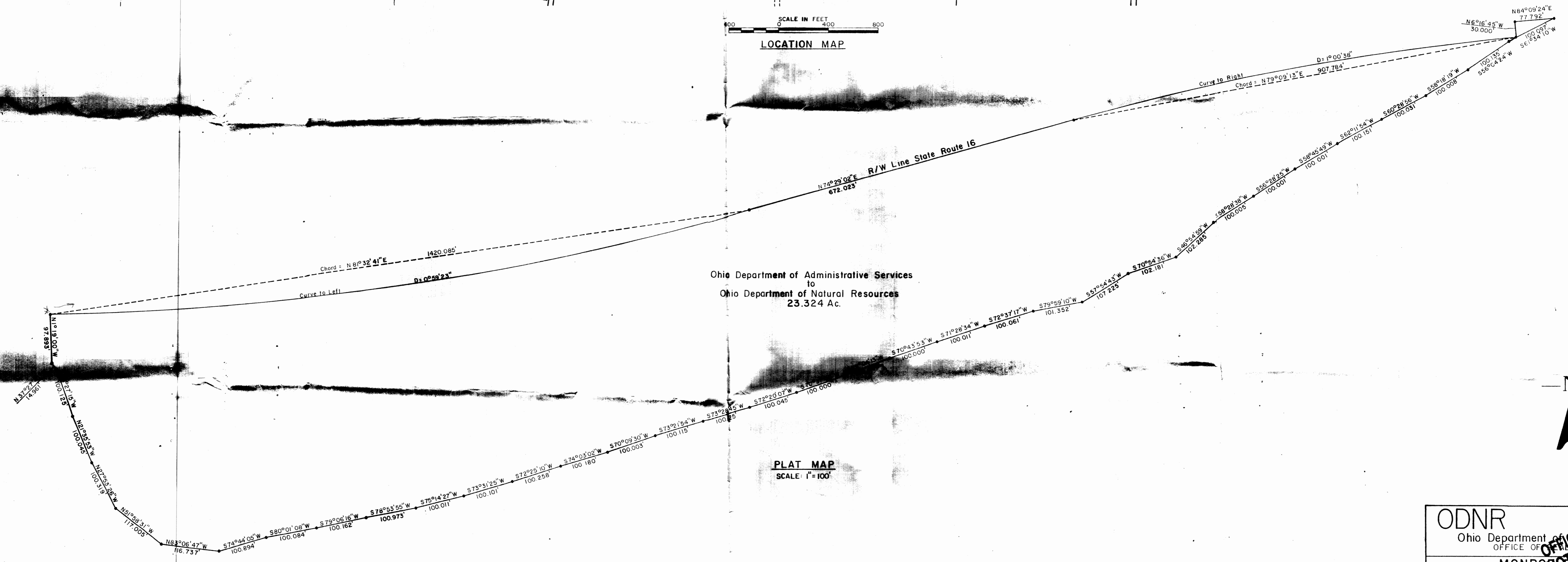

Ohio Department of Administrative Services
to
Ohio Department of Natural Resources
23.324 Ac.

PLAT MAP
SCALE: 1" = 100'

ODNR
Ohio Department of Natural Resources
OFFICE OF PUBLIC AFFAIRS

MONROE BASIN

DIVISION OF WILDLIFE

DRAWN BY: J. A. R. MUSKINGUM CO, CASS TWP. APPROVED BY:
DATE: JAN 22, 1991 QUARTER TOWN 2 REVISED BY: