



## Linn Engineering, Inc.

*Civil Engineering Consultants*

740-452-7434 • 1-800-991-7434 • FAX 740-452-5198

534 Market Street • P.O. Box 2086 • Zanesville, Ohio 43702-2086

OFFICE COPY  
NOT RECORDABLE

Situated in the State of Ohio, County of Muskingum, Township of Cass, bounded and described as follows:

Being a part of the Quarter Township 2, Township 3, Range 7, United States Military Lands, and being a part of lands now owned by Denny T. and Patricia L. Ross and David N. and Rita R. Ross as described in Muskingum County Official Record 1500, Page 953, and more particularly described as follows:

**TRACT THREE:** Beginning for reference at an iron pipe found at the northeast corner of Quarter Township 2 of Cass Township;  
thence along the east line of lands now owned by Gray Farm Partnership (DR 516-518) South 01 degrees 56 minutes 52 seconds West 1631.22 feet to a point on the south line of the Ohio Central Railroad;  
thence along the west line of lands now owned by P. Cox and Monroe Hill Farms, LP (OR 1617-469) and lands now owned by S. Little, Etal (DR 1130-134) and in the pavement of Stilwell Road (CR-50) South 01 degrees 49 minutes 22 seconds West 2583.54 feet to a point and the principal place of beginning;  
thence continuing along said Little's west line and the west line of Quarter Township 1 South 01 degrees 49 minutes 22 seconds West 440.35 feet to an iron pin set on the northeast corner of lands now owned by W.L. Ross, Etal (DR 1119-170);  
thence along said Ross' north line North 88 degrees 11 minutes 00 second West 268.13 feet to an iron pin found on said Ross' northwest corner, passing an iron pin found at 24.99 feet;  
thence along said Ross' west line South 11 degrees 23 minutes 37 seconds West 211.48 feet to an iron pin found on said Ross' southwest corner;  
thence along said Ross' south line South 88 degrees 09 minutes 15 seconds East 303.29 feet to a point in Stilwell Road and the west line of Quarter Township 1, passing an iron pin found at 278.29 feet;  
thence along said Little's west line and in the pavement of Stilwell Road South 01 degrees 49 minutes 22 seconds West 2725.26 feet to a point at the intersection with the centerline of Gene Cox Memorial Drive (CR-403), from which an iron pin set bears North 13 degrees 28 minutes 38 seconds West 57.40 feet;  
thence along the centerline of Gene Cox Memorial Drive, through lands now owned by Denny T. and Patricia L. Ross and David N. and Rita R. Ross (OR 1500-953), North 88 degrees 25 minutes 19 seconds West 1471.06 feet to a point on the east line of lands now owned by P. Cox and Monroe Hill Farms, LP (OR 1617-469);  
thence along said Cox and Monroe Hill Farm's east line North 02 degrees 01 minutes 14 seconds East 3385.63 feet to an iron pin set, passing an iron pin found at 13.08 feet;  
thence through said Denny T. and Patricia L. Ross and David N. and Rita R. Ross (OR 1500-953) lands South 87 degrees 58 minutes 46 seconds East 1459.38 feet to the principal place of beginning,

passing an iron pin set at 1439.91 feet;  
containing 112.32 acres, more or less, subject to all legal road right of ways and applicable easements, written or implied.

Iron pins set are 5/8 inch diameter by 30 inch long rebar with plastic identification caps.

Bearings are based on the west line of OR 1500-953 as bearing North 02 degrees 01 minutes 14 seconds East, as per previous survey by G.A. Stewart, dated August 8, 1985.

This description is written based on an actual field survey completed November 20, 2003 by Jack D. Newcome, Reg. No. 7321.

**OFFICE COPY  
NOT RECORDABLE**  
\_\_\_\_\_  
Jack D. Newcome, Reg. No. 7321      Date

Parcel No.

TRACT THREE: Part of      10-10-16-02-10-000 (112.32 ac.)

DESCRIPTION APPROVED  
FOR AUDITOR'S TRANSFER

BY ASB

11-26-2003

### BASIS OF BEARING

Bearings are based on the west line of OR 1500-953 as being N02°01'14"E, as per previous survey by G.A. Stewart, August 8, 1985.

### SITUATED IN

The State of Ohio, County of Muskingum Township of Cass, and being a part of Quarter Township 2, T3, R7, U.S.M.L.

### LEGEND

- Iron Pin Set, 5/8" rebar
- Iron Pin Found
- Iron Pipe Found

P. Cox & Monroe Hill Farms LP  
OR 1617-469

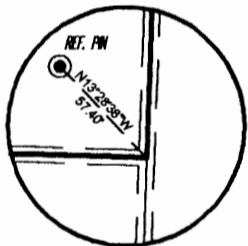

DETAIL

### REFERENCES

- OR 1500-953
- DR 516-518
- DR 708-311
- Tax Map 10-16
- Tax Map 10-25
- ODNR Monroe Basin Survey Map
- Former P.C.C. & S.L. Railroad Val. Map, sheets 91 & 92
- Former Wheeling and Lake Erie Railway Co. Val. Maps, sheets 112 & 113
- Survey of entire farm by G.A. Stewart dated August 8, 1985.

### PARCEL NO.

Part of: 10-10-16-02-10-000 (±112.32 ac.)

### GRAPHIC SCALE



( IN FEET )  
1 inch = 500 ft.

Project No.: 10-16-ROSS



Linn Engineering, Inc. 740-452-7434  
Civil Engineering Consultants  
P.O. Box 2088 Xenonville, Ohio 43702-2088

DESCRIPTION APPROVED  
FOR AUDITOR'S TRANSFER  
BY *[Signature]*  
11-26-2003

Denny T. & Patricia L. Ross  
and David N. & Rita R. Ross  
OR 1500-953  
Tract Three  
±112.32 Acres

N02°01'14"E 3385.63'  
3372.55'

13.08'

N88°25'19"W  
1471.06'

Gene Cox Memorial Drive  
(CR-403)

Denny T. & Patricia L. Ross  
and David N. & Rita R. Ross  
OR 1500-953  
Tract Four

Pipe Found at the Northeast  
Corner of Quarter Township 2,  
T3, R7, U.S.M.L.

S01°56'52"W  
1631.22'

S01°49'22"W  
2583.54'

P. Cox & Monroe Hill Farms LP  
OR 1617-469

S87°58'46"E 1459.38'  
1439.91'

19.47'

S01°49'22"W  
440.35'

N88°11'00"W  
243.14'

S11°23'37"W  
211.48'

W.L. Ross  
Etal  
DR 1119-170

24.99'

S88°09'15"E  
278.29'

25.00'

Stillwell Road  
(CR-50)

S. Little, Etal  
DR 1130-134

Quarter Township 2  
Quarter Township 1

S01°49'22"W  
2725.26'

SEE DETAIL

OFFICE COPY  
NOT RECORDABLE

Jack J. Newcomb  
Reg. Surveyor  
Date