



Linn Engineering, Inc.

Civil Engineering Consultants

740-452-7434 • 1-800-991-7434 • FAX 740-452-5198

534 Market Street • P.O. Box 2086 • Zanesville, Ohio 43702-2086

Situated in the State of Ohio, County of Muskingum, Township of Cass, bounded and described as follows:

Being a part of the Quarter Township 2, Township 3, Range 7, United States Military Lands, and being a part of lands now owned by Denny T. and Patricia L. Ross and David N. and Rita R. Ross as described in Muskingum County Official Record 1500, Page 953, and more particularly described as follows:

TRACT ONE: Beginning for reference at an iron pipe found at the northeast corner of Quarter Township 2 of Cass Township;

thence along the east line of lands now owned by Gray Farm Partnership (DR 516-518) South 01 degrees 56 minutes 52 seconds West 1631.22 feet to a point on the south line of the Ohio Central Railroad, and the principal place of beginning;

thence along the west line of lands now owned by P. Cox and Monroe Hill Farms, LP (OR 1617-469) and lands now owned by S. Little, Etal (DR 1130-134) and in the pavement of Stilwell Road (DR-50), South 01 degrees 48 minutes 40 seconds West 2583.54 feet to a point;

thence through lands now owned by Denny T. and Patricia L. Ross and David N. and Rita R. Ross (OR 1500-953), North 87 degrees 58 minutes 46 seconds West 1459.91 feet to an iron pin set on the east line of lands now owned by P. Cox and Monroe Hill Farms, LP (OR 1617-469), passing an iron pin set at 20.00 feet;

thence along said Cox and Monroe Hill Farm's east line North 02 degrees 01 minutes 14 seconds East 2136.12 feet to an iron pin set on the south line of said Ohio Central Railroad;

thence along the south line of said Ohio Central Railroad the following three courses:

- 1) North 76 degrees 23 minutes 18 seconds East 1350.01 feet to an iron pin set;
- 2) North 13 degrees 36 minutes 51 seconds West 40.00 feet to an iron pin set, from which a disturbed iron pin found bears North 66 degrees 49 minutes 47 seconds East 7.27 feet;
- 3) North 76 degrees 23 minutes 09 seconds East 167.36 feet to the principal place of beginning, passing an iron pin set at 136.97 feet, from which an iron pin found bears North 68 degrees 56 minutes 38 seconds East 10.61 feet;

containing 78.31 acres, more or less, subject to all legal road right of ways and applicable easements, written or implied.

Iron pins set are 5/8 inch diameter by 30 inch long rebar with plastic identification caps.

Bearings are based on the west line of OR 1500-953 as bearing North 02 degrees 01 minutes 14 seconds East, as per previous survey by G.A. Sawyer, dated August 8, 1988.

**OFFICE COPY
NOT RECORDABLE**

This description is written based on an actual field survey completed November 20, 2003 by Jack D. Newcome, Reg. No. 7321

Jack D. Newcome, Reg. No. 7321 Date

Parcel No.

TRACT ONE: Part of 10-10-16-02-10-000 (78.31 ac.)

DESCRIPTION APPROVED
FOR AUDITOR'S TRANSFER
BY AKS

11-26-2003

BASIS OF BEARING

Bearings are based on the west line of OR 1500-953 as being N02°01'14"E, as per previous survey by G.A. Stewart, August 8, 1985.

SITUATED IN

The State of Ohio, County of Muskingum Township of Cass, and being a part of Quarter Township 2, T3, R7, U.S.M.L.

Pipe Found at the Northeast Corner of Quarter Township 2, T3, R7, U.S.M.L.

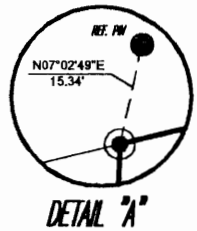

DETAIL "A"

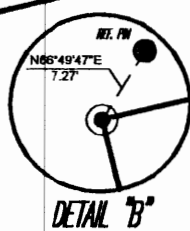

DETAIL "B"

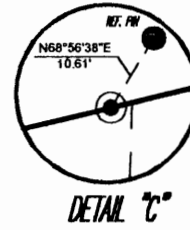

DETAIL "C"

LEGEND

- Iron Pin Set, 5/8" rebar
- Iron Pin Found
- Iron Pipe Found

P. Cox & Monroe Hill Farms LP
OR 1617-469

Denny T. & Patricia L. Ross
and David N. & Rita R. Ross
OR 1500-953
Tract One
±78.31 Acres

P. Cox & Monroe Hill Farms LP
OR 1617-469

DESCRIPTION APPROVED
FOR AUDITOR'S TRANSFER
BY *[Signature]*
11-26-2003

REFERENCES

- OR 1500-953
- DR 516-518
- DR 708-311
- Tax Map 10-16
- Tax Map 10-25
- ODNR Monroe Basin Survey Map
- Former P.C.C. & S.L. Railroad Val. Map, sheets 91 & 92
- Former Wheeling and Lake Erie Railway Co. Val. Maps, sheets 112 & 113
- Survey of entire farm by G.A. Stewart dated August 8, 1985.

PARCEL NO.

Part of: 10-10-16-02-10-000 (±78.31 ac.)

Jack Newcome
Reg. Surveyor No. 7321

Date

GRAPHIC SCALE



(IN FEET)
1 inch = 400 ft.

Project No.: 10-16-ROSS



Linn Engineering, Inc. 740-452-7434
Civil Engineering Consultants
P.O. Box 2086 Zanesville, Ohio 43702-2086

OFFICE COPY
NOT RECORDABLE