



Linn Engineering, Inc.

Civil Engineering Consultants

740-452-7434 • 1-800-991-7434 • FAX 740-452-5198

534 Market Street • P.O. Box 2086 • Zanesville, Ohio 43704-2086

OFFICE COPY
NOT RECORDABLE

Situated in the State of Ohio, County of Muskingum, Township of Cass, bounded and described as follows:

Being a part of the Quarter Township 2, Township 3, Range 7, United States Military Lands, and being a part of lands now owned by Denny T. and Patricia L. Ross and David N. and Rita R. Ross as described in Muskingum County Official Record 1500, Page 953, and more particularly described as follows:

TRACT FOUR: Beginning for reference at an iron pipe found at the northeast corner of Quarter Township 2 of Cass Township;

thence along the east line of lands now owned by Gray Farm Partnership (DR 516-518) South 01 degrees 56 minutes 52 seconds West 1631.22 feet to a point on the south line of the Ohio Central Railroad;

thence along the west line of Quarter Township 1 South 01 degrees 49 minutes 22 seconds West 5957.83 feet to a point at the intersection with the centerline of Gene Cox Memorial Drive (CR-403), from which an iron pin set bears South 28 degrees 56 minutes 22 seconds West 36.02 feet, and the principal place of beginning;

thence continuing along said line and in the pavement of Stilwell Road (CR-50) South 01 degrees 49 minutes 22 seconds West 1036.12 feet to a point;

thence through lands now owned by Denny T. and Patricia L. Ross and David N. and Rita R. Ross (OR 1500-953) the following six courses:

- 1) South 34 degrees 50 minutes 56 seconds West 220.71 feet to an iron pin set, passing an iron pin set at 53.20 feet;
- 2) South 08 degrees 55 minutes 35 seconds East 31.92 feet to an iron pin set;
- 3) South 79 degrees 31 minutes 25 seconds West 795.47 feet to an iron pin set;
- 4) South 84 degrees 31 minutes 19 seconds West 319.02 feet to an iron pin set;
- 5) South 80 degrees 19 minutes 32 seconds West 167.90 feet to an iron pin set;
- 6) North 78 degrees 49 minutes 34 seconds West 105.02 feet to an iron pin set on the east line of lands now owned by P. Cox and Monroe Hill Farms, LP (OR 1617-469);

thence along the Cox and Monroe Hill Farms east line North 02 degrees 01 minutes 15 second East 1472.65 feet to the centerline of said Gene Cox Memorial Drive (CR-403), passing an iron pin found at 1459.65 feet;

thence along the said centerline of Gene Cox Memorial Drive and through said Denny T. and Patricia L. Ross and David N. and Rita R. Ross lands South 88 degrees 25 minutes 19 seconds East 1471.06 feet to the principal place of beginning;

containing 46.25 acres, more or less, subject to all legal road right of ways and applicable easements, written or implied.

Iron pins set are 5/8 inch diameter by 30 inch long rebar with plastic identification caps.

Bearings are based on the west line of OR 1500-953 as bearing North 02 degrees 01 minutes 14 seconds East, as per previous survey by G.A. Stewart, dated August 8, 1985.

This description is written based on an actual field survey completed November 20, 2003 by Jack D. Newcome, Reg. No. 7321.

Jack D. Newcome, Reg. No. 7321 Date

Parcel No.

TRACT FOUR: Part of 10-10-16-02-10-000 (46.25 ac.)

DESCRIPTION APPROVED
FOR AUDITOR'S TRANSFER

BY ASB

12-1-2003

BASIS OF BEARING

Bearings are based on the west line of OR 1500-953 as being N02°01'14"E, as per previous survey by G.A. Stewart, August 8, 1985.

SITUATED IN

The State of Ohio, County of Muskingum Township of Cass, and being a part of Quarter Township 2, T3, R7, U.S.M.L.

Pipe Found at the Northeast Corner of Quarter Township 2, T3, R7, U.S.M.L.

Denny T. & Patricia L. Ross
and David N. & Rita R. Ross
OR 1500-953
Tract Three

Quarter Township 2
S01°49'22"W 5957.83'
Quarter Township 1
S01°56'52"W 1631.22'

P.O.B.

SEE "DETAIL"

Gene Cox Memorial Drive (CR-403)

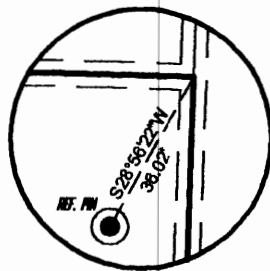

"DETAIL"

Denny T. & Patricia L. Ross
and David N. & Rita R. Ross
OR 1500-953
Tract Four
±46.25 Acres

S. Little, Etal
DR 1130-134

Stillwell Road (CR-50)

S34°50'56"W 220.71'
S08°55'35"E 31.92'

Denny T. & Patricia L. Ross
and David N. & Rita R. Ross
OR 1500-953
Tract Five

Denny T. & Patricia L. Ross
and David N. & Rita R. Ross
OR 1500-953
Tract Six

Muskingum River

Muskingum River

REFERENCES

- OR 1500-953
- DR 516-518
- DR 708-311
- Tax Map 10-16
- Tax Map 10-25
- ODNR Monroe Basin Survey Map
- Former P.C.C. & S.L. Railroad Val. Map, sheets 91 & 92
- Former Wheeling and Lake Erie Railway Co. Val. Maps, sheets 112 & 113
- Survey of entire farm by G.A. Stewart dated August 8, 1985.

DESCRIPTION APPROVED FOR AUDITOR'S TRANSFER BY *[Signature]* 12-7-2003

LEGEND

- Iron Pin Set, 5/8" rebar
- Iron Pin Found
- Iron Pipe Found

OFFICE COPY NOT RECORDABLE

PARCEL NO.

Part of: 10-10-16-02-10-000 (±46.25 ac.)

Jack D. Newcome
Reg. Surveyor No. 7321

Date

GRAPHIC SCALE



(IN FEET)
1 inch = 300 ft.

Project No.: ELBY-794



Linn Engineering, Inc. 740-452-7434
Civil Engineering Consultants
P.O. Box 2086 Zanesville, Ohio 43702-2086