

Dirk Cullins
1.033 Ac.
Part of Parcel No. 10-30-71-08-000

Situated in the State of Ohio, County of Muskingum, Township of Cass:
Being a part of Lot 22 in Quarter Township Three (3), Township Three (3), Range Eight (8) in the United States Military Land and part of property owned by Richard and Rose Cullins and Recorded in Deed Book 1023, Page 214 of the Muskingum County Deed Records bounded and described as follows:

Commencing at an iron pin found at the southwest corner of said Lot 22; thence S 87° 39' 51" E (the base of bearings for this description is the south line in Volume 1023, page 214) along the south line of Lot 22 and the south line of Cass Township 425.98 feet to an iron pin found; thence N 2° 20' 09" E to a point in the center of McIntire Lane and passing through an iron pin found at 70.69 feet; thence along the center of said McIntire Lane the following 3 courses and distances:

1 - N 69° 51' 14" E 23.53 feet to a point

2 - N 72° 40' 46" E 104.63 feet to a point

3 - N 75° 30' 38" E 168.38 feet to a point at the true place of beginning for the following described parcel; thence N 8° 01' 09" W along the east line of property owned by Charles and Tracy Henderson (Vol. 1127, pg. 149) 159.48 feet to an iron pin found and passing through an iron in found at 24.06 feet; thence N 77° 30' 11" E 331.66 feet to an iron pin set in the center of the old location of State Route 60 and passing through an iron pin set on the west right of way of said road at 293.70 feet; thence along the center of the old location of said road on a curve to the left having a radius 498.22 feet (the chord of which bears S 16° 06' 00" W 181.86 feet) an arc distance of 182.89 feet to an iron pin set at the intersection of said centerline with the centerline of McIntire Lane; thence along the center of said McIntire Lane and the north line of a 2.135 acre parcel owned by Kenneth and Derilyn Untied (Vol. 946, pg. 26) the following 2 courses and distances:

1 - S 83° 24' 12" W 70.10 feet to a point

2 - S 75° 30' 38" W 187.45 feet to the true place of beginning containing One and Thirty-three-thousandths (1.033) acres of which 0.1237 of an acre lies in the right of way of old State Route 60.

Part of Auditors Parcel No. 10-30-71-08-000.

Subject to all legal right of ways and easements on record.

All iron pins set are 5/8" x 30" rebar with plastic cap Graves No. 5792.

This description was written April 27, 2001 from a Field Survey by Richard Max Graves Registered Surveyor, No. 5792.

A 20 foot right of way is retained for a field drive along the entire west right of way line of old State Route 60.

DESCRIPTION APPROVED
FOR AUDITOR'S RECORDER
BY *[Signature]*
5-2-2001

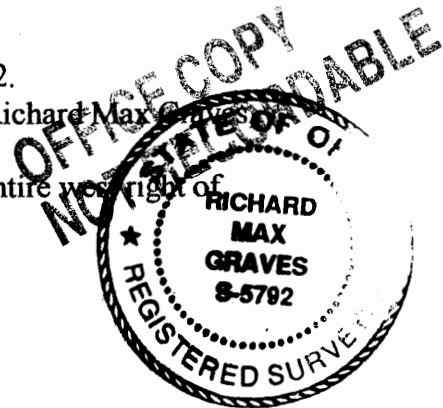



BASE OF BEARINGS IS VOL. 1023, Pg. 214
TRUE NORTH BY SUN OBSERVATION IS
CLOCKWISE $0^{\circ}08'50''$.

- IRON PIN FOUND
- $\frac{3}{8}$ " x 30" REBAR SET-CAPPED GRAVES #5792
- RR SPIKE FD.
- CONC. MON FD.

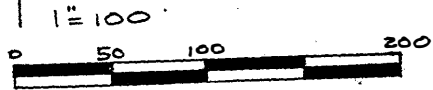

MAP SHOWING SURVEY OF 1.033 AC.
FOR DIRK CULLINS - PART OF PROPERTY
OWNED BY RICHARD & ROSE CULLINS
VOL. 1023, Pg. 214 IN LOT 22
QTR. TWP. 3, TWP. 3, RA. 8 USML
MUSKINGUM TWP. MUSKINGUM CO.,
OHIO

LOT 22, 3RD QTR. T.3, R.8

10-10-30-71-08-000
RICHARD & ROSE CULLINS
VOL. 1023, Pg. 214

1-033 AC.
PT. 10-10-30-71-08-000
20' EASEMENT
RETAINED

0.837 AC.
CHAS. & TRACY HENDERSON
VOL. 1127, Pg. 149

McINTIRE LANE

KENNTEH & DERILYN
UNTIED VOL. 946, P. 26
2.135 AC.

REFERENCE LIST

- VOL. 1023, Pg. 214
- VOL. 1127, Pg. 149
- VOL. 946, Pg. 26
- 1989 SURVEY OF J. MCINTIRE EST.
BY R.M. GRAVES #5792
- 1985 SURVEY OF K. UNTIED
BY W.J. BIEDENBACH #5718
- 1996 SURVEY 0.837 AC.
BY R.M. GRAVES #5792
- CASS TWP TAX SHEET 10-30
RESIDUAL QUAD. USGS

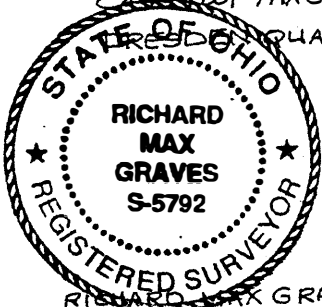

RICHARD MAX GRAVES
REGISTERED SURVEYOR S-5792
2925 KENLO WOODS
NASHPORT, OHIO 43830
APRIL 24, 2001

Richard Max Graves

NOT A TRUE COPY
NOT RECORDED

LOT 23
SEC. 4

LOT 22
SEC. 4

LOT LINE
SEC. LINE

CASS TWP.
MUSKINGUM TWP.

$S.87^{\circ}39'57''E.$
 $425.98'$

$N.2^{\circ}20'09''E.$
 $85.69'$

$N.69^{\circ}57'14''E.$
 $23.53'$

$N.72^{\circ}40'46''E.$
 $54.23'$

$N.11^{\circ}55'18''E.$
 $169.09'$

$N.75^{\circ}30'38''E.$
 $355.83'$

$N.8^{\circ}01'09''W.$
 $159.48'$

$25.02'$

$104.63'$

$50.4'$

$187.45'$

$24.06'$

$168.38'$

$229.25'$

$N.77^{\circ}30'11''E.$

$S.83^{\circ}24'12''W.$
 $70.10'$

$ARC 176.91'$

$ARC 182.89'$

$37.96'$

$331.66'$

R/W
 $R: 19^{\circ}08'00''$
 $R: 528.22'$
 $Ch. 26.59'$
 $175.59'$

$S.21^{\circ}22'36''W.$
 $111.9'$

$S.61^{\circ}05'57''E.$
 $121.86'$

$R: 21^{\circ}01'56''$
 $R: 498.22'$
 $Ch. 06.00'$
 $121.86'$

$S.21^{\circ}22'36''W.$
 $111.9'$

$S.61^{\circ}05'57''E.$
 $121.86'$

R/W
 $R: 19^{\circ}08'00''$
 $R: 528.22'$
 $Ch. 26.59'$
 $175.59'$

R/W
 $R: 19^{\circ}08'00''$
 $R: 528.22'$
 $Ch. 26.59'$
 $175.59'$

R/W
 $R: 19^{\circ}08'00''$
 $R: 528.22'$
 $Ch. 26.59'$
 $175.59'$

R/W
 $R: 19^{\circ}08'00''$
 $R: 528.22'$
 $Ch. 26.59'$
 $175.59'$

R/W
 $R: 19^{\circ}08'00''$
 $R: 528.22'$
 $Ch. 26.59'$
 $175.59'$

R/W
 $R: 19^{\circ}08'00''$
 $R: 528.22'$
 $Ch. 26.59'$
 $175.59'$

R/W
 $R: 19^{\circ}08'00''$
 $R: 528.22'$
 $Ch. 26.59'$
 $175.59'$

R/W
 $R: 19^{\circ}08'00''$
 $R: 528.22'$
 $Ch. 26.59'$
 $175.59'$

R/W
 $R: 19^{\circ}08'00''$
 $R: 528.22'$
 $Ch. 26.59'$
 $175.59'$

R/W
 $R: 19^{\circ}08'00''$
 $R: 528.22'$
 $Ch. 26.59'$
 $175.59'$

R/W
 $R: 19^{\circ}08'00''$
 $R: 528.22'$
 $Ch. 26.59'$
 $175.59'$

R/W
 $R: 19^{\circ}08'00''$
 $R: 528.22'$
 $Ch. 26.59'$
 $175.59'$

R/W
 $R: 19^{\circ}08'00''$
 $R: 528.22'$
 $Ch. 26.59'$
 $175.59'$

R/W
 $R: 19^{\circ}08'00''$
 $R: 528.22'$
 $Ch. 26.59'$
 $175.59'$

R/W
 $R: 19^{\circ}08'00''$
 $R: 528.22'$
 $Ch. 26.59'$
 $175.59'$

R/W
 $R: 19^{\circ}08'00''$
 $R: 528.22'$
 $Ch. 26.59'$
 $175.59'$

DESCRIPTION APPROVED
FOR RECORD & TRANSFER
BY *RMG*
5-2-2001