



Linn Engineering, Inc.

Civil Engineering Consultants

740-452-7434 • 1-800-991-7434 • FAX 740-452-5198

534 Market Street • P.O. Box 2086 • Zanesville, Ohio 43702-2086

ADDRESS N/A

DOMINION WEST

OFFICE COPY
NOT RECORDABLE

Situated in the State of Ohio, County of Muskingum, Township of Cass, bounded and described as follows:

10-34-51 - 37-001

Tract One: Being a part of Lot 17 and 22, Quarter Township Four of the United States Military Lands, Township 3, Range 8, and being a part of lands now owned by Dresden Energy, LLC as described in Muskingum County Official Record 1738, Page 888, and more particularly described as follows:

Beginning at an iron pin found at the Northwest corner of Lot 22 of Quarter Township 4, Township 3, Range 8, United States Military Lands;

thence along the west line of Lot 17 of Quarter Township 4, North 00 degrees 30 minutes 45 seconds East for a distance of 429.95 feet to a magnetic nail and cap found in a creek bed on the southwest corner of lands now owned by Franklin Real Estate (DR 548-827);

thence along said Franklin Real Estate's south line, South 87 degrees 59 minutes 44 seconds East for a distance of 698.99 feet to an iron pin found on the southwest corner of lands now owned by Ohio Power Company (DR 497-161);

thence through lands now owned by Dresden Energy, LLC (OR 1738-888), South 03 degrees 04 minutes 45 seconds East for a distance of 817.84 feet to an iron pin set on the corner of an area designated as the "Power Plant Block";

thence the following eleven courses around said "Power Plant Block":

- 1) South 20 degrees 26 minutes 29 seconds West for 186.92 feet to an iron pin set;
- 2) South 10 degrees 59 minutes 30 seconds West for 138.28 feet to an iron pin set;
- 3) North 89 degrees 44 minutes 09 seconds West for 140.55 feet to an iron pin set;
- 4) South 02 degrees 13 minutes 48 seconds West for 296.48 feet to an iron pin set;
- 5) South 78 degrees 59 minutes 22 seconds East for 124.23 feet to an iron pin set;
- 6) South 57 degrees 48 minutes 58 seconds East for 59.79 feet to an iron pin set;
- 7) South 29 degrees 57 minutes 02 seconds East for 131.28 feet to an iron pin set;
- 8) South 56 degrees 01 minutes 08 seconds East for 62.84 feet to an iron pin set;
- 9) South 69 degrees 30 minutes 56 seconds East for 233.63 feet to an iron pin set;
- 10) South 84 degrees 44 minutes 31 seconds East for 210.96 feet to an iron pin set;
- 11) South 87 degrees 41 minutes 52 seconds East for 204.60 feet to an iron pin set;

thence through said Dominion lands South 22 degrees 30 minutes 27 seconds East for a distance of 79.38 feet to an iron pin found on the northwest corner of lands presently owned by N. and M. Martin (DR 567-389);

thence along the west line of said Martin lands South 52 degrees 30 minutes 50 seconds West for a distance of 328.66 feet to an iron pin found on the northwest corner of lands presently owned

OFFICE COPY
NOT RECORDABLE

by A. and B. Davis (DR 1148-46);

thence along the said Davis lines the following two courses:

- 1) South 52 degrees 33 minutes 11 seconds West for 17.84 feet to an iron pin found;
- 2) South 41 degrees 05 minutes 08 seconds West for 516.62 feet to an iron pin found on the northwest corner of lands now owned by C. and G. Gladman (OR 1791-718);

thence along said Gladmans' west line South 41 degrees 06 minutes 53 seconds West for a distance of 249.39 feet to an iron pin found on the northwest corner of lands now owned by J.D. and L.A. Butler (DR 1822-173);

thence along said Butlers' line the following two courses:

- 1) South 41 degrees 00 minutes 13 seconds West for 75.53 feet to an iron pin found;
- 2) South 59 degrees 03 minutes 08 seconds West for 85.52 feet to an iron pin found on the northwest corner of lands now owned by S. and R. Laferre (OR 1547-993);

thence along said Laferres' north line South 58 degrees 59 minutes 07 seconds West for a distance of 425.92 feet to an iron pin found on the northeast corner of lands now owned by J.C. Ethell (DR 836-273);

thence along said Ethells' north line South 79 degrees 12 minutes 06 seconds West for a distance of 237.52 feet to a stone found on the west line of said Lot 22 and the east line of lands now owned by L. and M. Lauersdorf (OR 1513-733);

thence along said Lauersdorf's east line North 00 degrees 56 minutes 31 seconds East for a distance of 22.10 feet to an iron pin found on the southeast corner of lands now owned by C.A. and S.L. Myers (DR 1015-442), from which an iron pin found bears North 07 degrees 42 minutes 23 seconds East 6.09 feet;

thence along said Myers' east line the following four courses:

- 1) North 00 degrees 56 minutes 31 seconds East for 1466.33 feet to an iron pin found;
- 2) North 01 degrees 28 minutes 37 seconds East for 14.37 feet to a stone found;
- 3) North 00 degrees 59 minutes 28 seconds East for 445.58 feet to an iron pin found;
- 4) North 00 degrees 59 minutes 48 seconds East for 609.84 feet to the place of beginning;

containing 53.67 acres, more or less, subject to all legal road right of ways and applicable easements, written or implied.

110-34-51-39-001 N/A

Tract Two: Being a part of Lot 17, Quarter Township Four of the United States Military Lands, Township 3, Range 8, and being a part of lands now owned by Dresden Energy, LLC as described in Muskingum County Official Record 1738, Page 888, and more particularly described as follows:

Beginning for reference at an iron pin found at the Northwest corner of Lot 22 of Quarter Township 4, Township 3, Range 8, United States Military Lands;

thence along the west line of Lot 17 of Quarter Township 4, North 00 degrees 30 minutes 45 seconds East for a distance of 429.95 feet to a magnetic nail and cap found in a creek bed on the southwest corner of lands now owned by Franklin Real Estate (DR 548-827);

thence along said Franklin Real Estate's south line, South 87 degrees 59 minutes 44 seconds East for a distance of 698.99 feet to an iron pin found on the southwest corner of lands now owned by Ohio Power Company (DR 497-161);

thence along the south line of said Ohio Power lands, South 83 degrees 20 minutes 52 seconds

SITUATED IN

The State of Ohio, County of Muskingum
Township of Cass, and being a part of Lot 22,
and Lot 17, Quarter Township 4, T3, R8, U.S.M.L.

Dresden Energy, LLC
OR 1738-888
Tract Two
±2.43 Acres

Franklin Real Estate Company
DR 548-827

Ohio Power Company
DR 497-161

Martin Farms Partnership
OR 1787-271

P.O.B.
IRON PIN FOUND AT THE
NORTHWEST CORNER OF
LOT 22, OF QUARTER
TOWNSHIP 4, T3, R8
U.S.M.L.

C.A. & S.L. Myers
DR 1015-442

Dresden Energy, LLC
OR 1738-888
Tract One
±53.67 Acres

Dresden Energy, LLC
OR 1738-888
(POWER PLANT BLOCK)

N. & M. Martin
DR 567-389
OR 1804-512

LINE TABLE

LINE	LENGTH	BEARING
L1	33.20	S80°57'17"W
L2	63.60	N68°20'47"W
L3	71.48	N43°04'53"W
L4	62.44	N63°13'27"W
L5	148.16	N75°20'19"W
L6	104.20	N64°07'01"W
L7	77.84	S85°55'45"W
L8	175.20	N78°47'48"W
L9	108.15	N06°39'08"E

LEGEND

- Iron Pin Set, 5/8" rebar
- Iron Pin Found
- ⊗ Mag Nail and Cap
- Monument Found
- Stone Found
- △ Railroad Spike Set
- ▲ Railroad Spike Found
- ✕ Chain Link Fence
- - - Water Line
- - - Gas Line
- ▨ Wetland Area

REFERENCES

Previous surveys of area by
M. Graves, P. Dinan, R. Roberts,
and M.S.E.S. Consultants.
Tax Map 10-34
DR 548-827
DR 497-161
DR 1015-442

BASIS OF BEARING

Bearings are based on Ohio State Plane Coordinate System,
South Zone, NAD83, Grid North, as per monumentation provided
within the survey area by Black & Veatch Corporation.

PARCEL NO.

Tract One:
Part of: 10-10-34-51-39-001 (±7.10 ac.)
Part of: 10-10-34-51-38-000 (±16.04 ac.)
Part of: 10-10-34-51-37-000 (±30.53 ac.)

Tract Two:
Part of: 10-10-34-51-39-001 (±2.43 ac.)

**OFFICE COPY
NOT RECORDABLE**

Jack D. Newcome
Reg. Surveyor No. 7321

Date

GRAPHIC SCALE

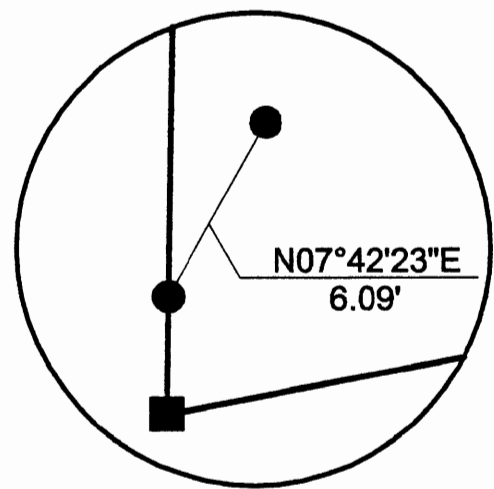
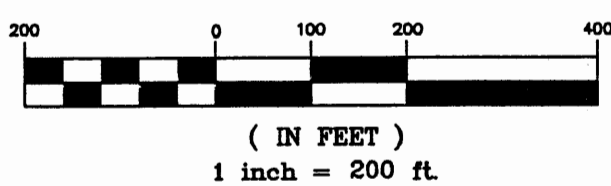

DETAIL

L. & M. Laversdorf
OR 1513-733

DESCRIPTION APPROVED
FOR ALIEN'S TRANSFER
BY [Signature]

Sheet No.	Project No.	By	Date	Scale	Revisions	By	Date
1	10-34 DOM	JDN		Horizontal 1" = 200'			
		VHC	09/10/04	Vertical 1" = N/A			
		JDN		Field Book No.			
		JDN					

DRESDEN ENERGY, LLC
CASS TOWNSHIP
MUSKINGUM COUNTY
BOUNDARY SURVEY

Linn Engineering, Inc.
Civil Engineering Consultants
P.O. Box 2086 Zanesville, Ohio 43702-2086 740-452-7434

