

W. J. Biedenbach & Associates

3120 Lisa Lane
Zanesville, OH 43701

Surveying and Mapping

Telephone (614) 453-4850
Fax (614) 450-1000

ROGER T. AND KAY A. SNIDER
AUDITORS PARCEL NUMBER 16-17-01-01-02-006 (PART)

BEING A PART OF THE NORTH HALF OF QUARTER TOWNSHIP 1, TOWNSHIP 1, RANGE 9, OF THE UNITED STATES MILITARY LANDS, FALLS TOWNSHIP, MUSKINGUM COUNTY, OHIO AND BEING FURTHER DESCRIBED AS FOLLOWS:

COMMENCING AT AN EXISTING IRON PIN (5/8 INCH REBAR) AT THE NORTHEAST CORNER OF QUARTER TOWNSHIP 1; THENCE WITH THE WEST LINE OF DEERWOODS SUBDIVISION THE NEXT THREE COURSES AND DISTANCES:

- 1) SOUTH 02 DEGREES 52 MINUTES 28 SECONDS WEST 1267.59 FEET TO A POINT, PASSING EXISTING IRON PINS (5/8 INCH REBAR) AT 81.34 FEET AND 732.59 FEET;
- 2) NORTH 87 DEGREES 07 MINUTES 32 SECONDS WEST 300.00 FEET (ALONG THE LINE ESTABLISHED IN DEED VOLUME 1068, PAGE 463 OF THE MUSKINGUM COUNTY DEED RECORDS) TO AN EXISTING IRON PIN (5/8 INCH REBAR);
- 3) SOUTH 02 DEGREES 37 MINUTES 44 SECONDS WEST 252.08 FEET TO A POINT; THENCE SOUTH 87 DEGREES 22 MINUTES 16 SECONDS EAST 1.00 FEET TO AN EXISTING IRON PIN (5/8 INCH REBAR) ON THE WEST LINE OF DOCKRAY DRIVE; THENCE SOUTH 02 DEGREES 37 MINUTES 44 SECONDS WEST 390.74 FEET ALONG THE SAID WEST LINE TO AN IRON PIN SET; SAID POINT BEING THE PLACE OF BEGINNING OF THE TRACT HEREIN INTENDED TO BE DESCRIBED; THENCE CONTINUING ALONG THE SAID WEST LINE, THE NEXT FIVE COURSES AND DISTANCES:

- 1) SOUTH 02 DEGREES 37 MINUTES 44 SECONDS WEST 303.37 FEET TO A POINT, SAID POINT BEING SOUTH 87 DEGREES 22 MINUTES 16 SECONDS EAST 1.00 FEET FROM AN EXISTING IRON PIN (5/8 INCH REBAR);
- 2) WITH A CURVE TO THE RIGHT HAVING A RADIUS OF 10.00 FEET (CHORD BEARING SOUTH 43 DEGREES 38 MINUTES 27 SECONDS WEST 13.12 FEET) AN ARC DISTANCE OF 14.32 FEET TO A POINT;
- 3) SOUTH 84 DEGREES 39 MINUTES 10 SECONDS WEST 142.49 FEET TO A POINT;
- 4) WITH A CURVE TO THE LEFT HAVING A RADIUS OF 125.00 FEET (CHORD BEARING SOUTH 56 DEGREES 10 MINUTES 05 SECONDS WEST 119.23 FEET) AN ARC DISTANCE OF 124.29 FEET TO A POINT;
- 5) SOUTH 27 DEGREES 41 MINUTES 00 SECONDS WEST 221.92 FEET TO A POINT IN THE CENTER OF OLD COUNTY ROAD 60; THENCE WITH THE SAID CENTERLINE NORTH 56 DEGREES 39 MINUTES 50 SECONDS WEST 21.71 FEET TO A POINT; THENCE LEAVING THE SAID ROAD NORTH 26 DEGREES 44 MINUTES 03 SECONDS EAST 309.85 FEET TO AN EXISTING IRON PIN (5/8 INCH REBAR), PASSING AN EXISTING IRON PIN (5/8 INCH REBAR) AT 28.72 FEET; THENCE NORTH 01 DEGREES 13 MINUTES 00 SECONDS WEST 267.12 FEET TO AN EXISTING IRON PIN (5/8 INCH REBAR); THENCE NORTH 08 DEGREES 56 MINUTES 54 SECONDS WEST 45.44 FEET TO AN IRON PIN SET; THENCE SOUTH 87 DEGREES 22 MINUTES 16 SECONDS EAST 258.75 FEET TO THE PLACE OF BEGINNING.

CONTAINING 2.000 MORE OR LESS ACRES, SUBJECT TO ALL LEGAL ROAD RIGHT-OF-WAY OF COUNTY ROAD 60 (RELOCATED) AND ALL OTHER APPLICABLE EASEMENTS.

ALL IRON PINS SET ARE 5/8 INCH X 30 INCH REBAR WITH PLASTIC IDENTIFICATION CAPS (BIEDENBACH PS5718-PS6923).

THE BEARINGS ARE BASED ON THE PREVIOUS SURVEY OF DEERWOODS SUBDIVISION AS RECORDED IN PLAT FILE 01, PAGE 123-123B OF THE MUSKINGUM COUNTY PLAT RECORDS.

I HEREBY CERTIFY TO THE BEST OF MY KNOWLEDGE AND BELIEF THE SURVEY AND DESCRIPTION TO BE CORRECTLY PREPARED BY ME, THIS 12th DAY OF DECEMBER, 1997.

W. J. BIEDENBACH
REGISTERED SURVEYOR 5718

DESCRIPTION APPROVED
FOR AUDITORS TRANSFER

BY RLS
12-22-97

17-01-01-02-007
4365 DOCKRAY DR.

SURVEY FOR ROGER SNIDER
AUDITORS PARCEL NUMBER
16-17-01-01-02-006 (PART)

BEING A PART OF THE NORTH HALF OF QUARTER TOWNSHIP 1,
TOWNSHIP 1, RANGE 9, OF THE UNITED STATES MILITARY LANDS,
FALLS TOWNSHIP, MUSKINGUM COUNTY, OHIO

BEARINGS ARE BASED ON THE PREVIOUS SURVEY OF DEERWOODS
SUBDIVISION AS RECORDED IN PLAT FILE 01, PG. 123-123B
OF THE MUSKINGUM COUNTY PLAT RECORDS.

RESEARCH:

- CO. RD. 60 ROW PLANS
- P.F. 01, PG. 123-123B
- VOL. 782, PG. 213
- VOL. 853, PG. 346
- VOL. 1046, PG. 356
- VOL. 1026 PG. 382
- VOL. 1011, PG. 338
- VOL. 1068, PG. 463
- VOL. 1079 PG. 56
- VOL. 1158, PG. 468

ROGER T. & KAY A.
SNIDER
VOL. 1134, PG. 474

ROGER T. & KAY A.
SNIDER
VOL. 1134, PG. 474
2.000 ± ACRES

L. W. DOCKRAY, JR.
DB. 853, PG. 346

DESCRIPTION APPROVED
FOR AUDITORS TRANSFER
BY *WJB*
12-22-97

I HEREBY CERTIFY TO THE BEST OF MY
KNOWLEDGE AND BELIEF THAT THE ABOVE PLAT AND
SURVEY TO BE CORRECTLY PREPARED BY ME,
THIS 12th DAY OF DECEMBER, 1997.

W.J. BIEDENBACH
REGISTERED SURVEYOR #5718

NORTHEAST CORNER OF
QUARTER TOWNSHIP 1

LOT 14

LOT 15

DEERWOODS SUBDIVISION
PLAT FILE 01, PG. 123-123B

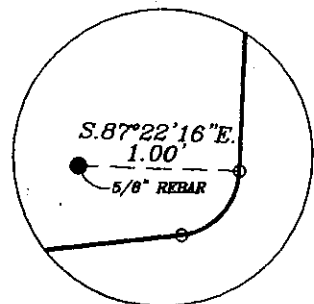

IRON PIN DETAIL
NOT TO SCALE

LEGEND

- EXISTING IRON PIN
- ⊙ IRON PIN SET
(5/8" REBAR W/CAP)
- ANGLE POINTS
- ⊠ QUARTER CORNER

W.J. BIEDENBACH & ASSOC.
SURVEYING & MAPPING
ZANESVILLE, OHIO
(614) 453-4850

DRAWN BY: AJS	DATE: 12-12-97
SCALE: 1"=120'	CHECKED BY: WJB
JOB NO: 4228	DRAWING NO: D:\4228\4228