

17-33.02-01-003

DESCRIPTION OF SURVEY FOR DAVID BENTLEY

JOB#1423-5

Situated in the State of Ohio, County of Muskingum, Township of Falls:

Being part of Lot #37 of Military Gardens a subdivision of Quarter Township #1, Township #1, Range #8, of the US Military District, **being part of** the Alan and Carol Wilson property recorded in Official Record Volume 1888, Page 284 of said county's deed records, further known as Muskingum County **Auditor's Parcel Number 17-33-02-01-000**, and more particularly described as follows;

Commencing at an iron pin (found) at the Northeast corner of said Lot #37 and Military Gardens, also being a common corner for the F Thomas Kearns Family Ltd. Partnership property recorded in Official Record Volume 1520, Page 316; **THENCE South 01 degrees 27 minutes 50 seconds West 534.80 feet** along the common line for said Lot #37, Military Gardens, and Kearns property to the unmarked place of beginning for the property herein intended to be described;

- #1- **THENCE South 01 degrees 27 minutes 50 seconds West 143.00 feet** continuing along the common line for said Lot #37, Military Gardens, and Kearns property to an iron pin (set);
- #2- **THENCE North 79 degrees 54 minutes 05 seconds West 234.97 feet** into said Lot #37 to an iron pin (set);
- #3- **THENCE South 45 degrees 36 minutes 35 seconds West 104.49 feet** continuing through said Lot #37 to an iron pin (set);
- #4- **THENCE South 85 degrees 09 minutes 20 seconds West 100.64 feet** continuing through said Lot #37 to an unmarked point on the West line of said Lot #37 and on the East line of Old Falls Road (County Road #298), passing an iron pin (set) at 59.32 feet;
- #5- **THENCE North 04 degrees 27 minutes 10 seconds West 198.86 feet** along the common line for said Lot and Road to an unmarked point;
- #6- **THENCE South 87 degrees 59 minutes 30 seconds East 425.63 feet** crossing said Lot #37 to the place of beginning, passing an iron pins (set) at 25.91 feet, and 419.20 feet, **containing 1.41 acres.**

The bearings within this description are based on State Plane Coordinate Grid (Ohio South 1983) derived from GPS Observations. Iron pins (set) are 5/8" rebar with identification caps (C.R.Harkness P.L.S.6885).

This description was written by Charles R. Harkness Professional Land Surveyor #6885 from an actual survey completed on March 30, 2005, in accordance with Chapter 4733-37 of the Administrative Code, and is intended to be used for the legal transfer of the property described and does not intend to describe all or any easements of record, nor encroachments unless otherwise indicated.

**OFFICE COPY
NOT RECORDABLE**

Charles R. Harkness PLS #6885

DESCRIPTION
APPROVED

By:

2/21/17



**APPROVED
MUSKINGUM COUNTY
PLANNING COMMISSION DIRECTOR**

2/21/17
Date

Fee Paid

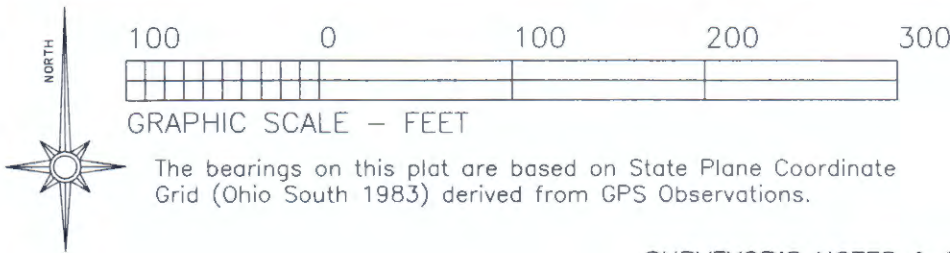

LEGEND

- PIN (SET) 5/8" REBAR CAPPED (C R HARKNESS PLS#6885)
- PIN (FOUND)
- △ POINT (UNMARKED)
- ⊗ AXLE (FOUND)

SURVEYOR'S NOTES & REFERENCES:

Muskingum Co. Tax Maps and Orthophotos of the area. 3-D TopoQuads by DeLorme (Ohio).
Survey of Lot #32 of Military Gardens completed by Richard Max Graves PLS #5792 dated 7/9/1999. Survey of shown Lot #37 by Denis Swierz PLS #8062 dated 12/12/2004. Survey of shown Kearns property completed by DJ Duche PLS #7938.

Bank Lots Recorded in DB "K", Page 644.

Bank Lot #11
Bank Lot #10

S 87°59'30"E 360.00'
340.67'

NE Cor
Lot #37

Alan & Carol Wilson
DB Vol. 1888, Page 284.
Auditor's Parcel Number
17-33-02-01-000

5.00 Acres
Jobs #1423-1,2,3 & 4

Military Gardens
Lot #37
PB 7, PG 49.

Situated in the State of Ohio, County of Muskingum, Township of Falls:

Being part of Lot #37 of Military Gardens a subdivision of Quarter Township #1, Township #1, Range #8, of the US Military District, being part of the Alan and Carol Wilson property recorded in Official Record Volume 1888, Page 284 of said county's deed records, further known as Muskingum County Auditor's Parcel Number 17-33-02-01-000;

F Thomas Kearns Family LTD. Partnership
OR Vol. 1520, Page 316.

Military Gardens

PB 8, PG 43.

APPROVED

MUSKINGUM COUNTY

PLANNING COMMISSION DIRECTOR



Fee Paid

Old Falls Road

(CR #298)

Date

Old Falls Road

(CR #298)

Old Falls Road

N 04°27'10"W

Old Falls Road

(CR #298)

To Pin @ Angle Point for Lot #37

N 15°00'55"E 188.13'

S 84°29'00"E 4.82' REF PIN

N 07°12'55"E 285.00'

S 86°57'30"E 9.12' REF PIN

N 04°27'10"W 198.86'

S 85°09'20"W 100.64'

S 04°27'10"E 424.06'

To Pin @ Angle Point for Lot #37

N 15°00'55"E 188.13'

S 84°29'00"E 4.82' REF PIN

N 07°12'55"E 285.00'

S 86°57'30"E 9.12' REF PIN

N 04°27'10"W 198.86'

S 85°09'20"W 100.64'

S 04°27'10"E 424.06'

To Pin @ Angle Point for Lot #37

N 15°00'55"E 188.13'

S 84°29'00"E 4.82' REF PIN

N 07°12'55"E 285.00'

S 86°57'30"E 9.12' REF PIN

N 04°27'10"W 198.86'

S 85°09'20"W 100.64'

S 04°27'10"E 424.06'

To Pin @ Angle Point for Lot #37

N 15°00'55"E 188.13'

S 84°29'00"E 4.82' REF PIN

N 07°12'55"E 285.00'

S 86°57'30"E 9.12' REF PIN

N 04°27'10"W 198.86'

S 85°09'20"W 100.64'

S 04°27'10"E 424.06'

To Pin @ Angle Point for Lot #37

N 15°00'55"E 188.13'

S 84°29'00"E 4.82' REF PIN

N 07°12'55"E 285.00'

S 86°57'30"E 9.12' REF PIN

N 04°27'10"W 198.86'

S 85°09'20"W 100.64'

S 04°27'10"E 424.06'

To Pin @ Angle Point for Lot #37

N 15°00'55"E 188.13'

S 84°29'00"E 4.82' REF PIN

N 07°12'55"E 285.00'

S 86°57'30"E 9.12' REF PIN

N 04°27'10"W 198.86'

S 85°09'20"W 100.64'

S 04°27'10"E 424.06'

To Pin @ Angle Point for Lot #37

N 15°00'55"E 188.13'

S 84°29'00"E 4.82' REF PIN

N 07°12'55"E 285.00'

S 86°57'30"E 9.12' REF PIN

N 04°27'10"W 198.86'

S 85°09'20"W 100.64'

S 04°27'10"E 424.06'

To Pin @ Angle Point for Lot #37

N 15°00'55"E 188.13'

S 84°29'00"E 4.82' REF PIN

N 07°12'55"E 285.00'

S 86°57'30"E 9.12' REF PIN

N 04°27'10"W 198.86'

S 85°09'20"W 100.64'

S 04°27'10"E 424.06'

To Pin @ Angle Point for Lot #37

N 15°00'55"E 188.13'

S 84°29'00"E 4.82' REF PIN

N 07°12'55"E 285.00'

S 86°57'30"E 9.12' REF PIN

N 04°27'10"W 198.86'

S 85°09'20"W 100.64'

S 04°27'10"E 424.06'

To Pin @ Angle Point for Lot #37

N 15°00'55"E 188.13'

S 84°29'00"E 4.82' REF PIN

N 07°12'55"E 285.00'

S 86°57'30"E 9.12' REF PIN

N 04°27'10"W 198.86'

S 85°09'20"W 100.64'

S 04°27'10"E 424.06'

To Pin @ Angle Point for Lot #37

N 15°00'55"E 188.13'

S 84°29'00"E 4.82' REF PIN

N 07°12'55"E 285.00'

S 86°57'30"E 9.12' REF PIN

N 04°27'10"W 198.86'

S 85°09'20"W 100.64'

S 04°27'10"E 424.06'

To Pin @ Angle Point for Lot #37

N 15°00'55"E 188.13'

S 84°29'00"E 4.82' REF PIN

N 07°12'55"E 285.00'

S 86°57'30"E 9.12' REF PIN

N 04°27'10"W 198.86'

S 85°09'20"W 100.64'

S 04°27'10"E 424.06'

To Pin @ Angle Point for Lot #37

N 15°00'55"E 188.13'

S 84°29'00"E 4.82' REF PIN

N 07°12'55"E 285.00'

S 86°57'30"E 9.12' REF PIN

N 04°27'10"W 198.86'

S 85°09'20"W 100.64'

S 04°27'10"E 424.06'

To Pin @ Angle Point for Lot #37

N 15°00'55"E 188.13'

S 84°29'00"E 4.82' REF PIN

N 07°12'55"E 285.00'

S 86°57'30"E 9.12' REF PIN

N 04°27'10"W 198.86'

S 85°09'20"W 100.64'

S 04°27'10"E 424.06'

To Pin @ Angle Point for Lot #37

N 15°00'55"E 188.13'

S 84°29'00"E 4.82' REF PIN

N 07°12'55"E 285.00'

S 86°57'30"E 9.12' REF PIN

N 04°27'10"W 198.86'

S 85°09'20"W 100.64'

S 04°27'10"E 424.06'

To Pin @ Angle Point for Lot #37

N 15°00'55"E 188.13'

S 84°29'00"E 4.82' REF PIN

N 07°12'55"E 285.00'

S 86°57'30"E 9.12' REF PIN

N 04°27'10"W 198.86'

S 85°09'20"W 100.64'

S 04°27'10"E 424.06'

To Pin @ Angle Point for Lot #37

N 15°00'55"E 188.13'

S 84°29'00"E 4.82' REF PIN

N 07°12'55"E 285.00'

S 86°57'30"E 9.12' REF PIN

N 04°27'10"W 198.86'

S 85°09'20"W 100.64'

S 04°27'10"E 424.06'

To Pin @ Angle Point for Lot #37

N 15°00'55"E 188.13'

S 84°29'00"E 4.82' REF PIN

N 07°12'55"E 285.00'

S 86°57'30"E 9.12' REF PIN

N 04°27'10"W 198.86'

S 85°09'20"W 100.64'

S 04°27'10"E 424.06'

To Pin @ Angle Point for Lot #37

N 15°00'55"E 188.13'

S 84°29'00"E 4.82' REF PIN

N 07°12'55"E 285.00'

S 86°57'30"E 9.12' REF PIN

N 04°27'10"W 198.86'

S 85°09'20"W 100.64'

S 04°27'10"E 424.06'

To Pin @ Angle Point for Lot #37

N 15°00'55"E 188.13'

S 84°29'00"E 4.82' REF PIN

N 07°12'55"E 285.00'

S 86°57'30"E 9.12' REF PIN

N 04°27'10"W 198.86'

S 85°09'20"W 100.64'

S 04°27'10"E 424.06'

To Pin @ Angle Point for Lot #37

N 15°00'55"E 188.13'

S 84°29'00"E 4.82' REF PIN

N 07°12'55"E 285.00'

S 86°57'30"E 9.12' REF PIN

N 04°27'10"W 198.86'

S 85°09'20"W 100.64'

S 04°27'10"E 424.06'

To Pin @ Angle Point for Lot #37

N 15°00'55"E 188.13'

S 84°29'00"E 4.82' REF PIN

N 07°12'55"E 285.00'

S 86°57'30"E 9.12' REF PIN

N 04°27'10"W 198.86'

S 85°09'20"W 100.64'

S 04°27'10"E 424.06'

To Pin @ Angle Point for Lot #37

This plat was prepared by C. R. Harkness Surveying & Mapping Inc. in accordance with Chapter 4733-37 of the Administrative Code, and is intended to be used for the legal transfer of the property described and does not intend to describe all or any easements of record, nor encroachments unless otherwise indicated.

OFFICE COPY
NOT RECORDABLE

Charles R. Harkness PLS #6885

SURVEY FOR:

David Bentley

Old Falls Road, Zanesville, Ohio 43701

SURVEY DATE: 3/30/2005

DRAWN DATE: 4/5/2005

TWP:#1 R:#8 TWP:Falls CO:Muskingum

CHARLES R. HARKNESS
SURVEYING & MAPPING, INC.
8205 OLD TOWN ROAD
ROSEVILLE, OHIO 43777
PHONE (740) 849-0122

JOB NUMBER

JOB #1423

DRAWING / SHEET NUMBER

PLAT #05