

**+ - 3.11 Acre Re-Survey of Lot No.3 of Tanner-L. Heights Subdivision**

Situated in the State of Ohio, County of Muskingum, Township of Falls, and being all of Lot 3, of Tanner-L. Heights Subdivision, as per Plat Book 5, Pages 95, and 96, being a subdivision of Lot 13, of Quarter Township 3, as per Deed Record "P", Page 519, Township 1, Range 8, United States Military Lands, and being all the lands presently owned by Cynthia A. Mccloud, Trustee, OR 2134-865, Second Parcel of Tract Two, and being more particularly described as follows:

Beginning for reference and the principal place of beginning at an angle iron found on the northwest corner of Lot 3, of Tanner-L. Heights Subdivision, as per Plat Book 5, Page 95, and 96;

Thence along the north line of Lot 3, South 65 degrees 30 minutes 00 seconds East, 303.50 feet to an iron pin set on the northwest corner of Lot 2, of said subdivision;

Thence along the east line of Lot 3, South 41 degrees 44 minutes 44 seconds West, 621.82 feet to a point in the pavement of Pinecrest Drive, passing an iron pin set at 591.82 feet;

Thence with the platted centerline in the pavement of Pinecrest Drive, North 46 degrees 27 minutes 51 seconds West, 174.09 feet to a point in the centerline of Pinecrest Drive, and the south east corner of lands presently owned by D. L. Williams;

Thence along the west line of Lot 3, and the east line of D. L. Williams land, North 29 degrees 20 minutes 00 seconds East, 539.00 feet to the principal place of beginning, passing an iron pin found at 22.20 feet and 0.42 feet north and west of the line, and an iron pin found at 68.44 feet, containing 3.11 acres more or less.

Subject to all legal recorded easements and right of ways.

Iron pins set are 5/8 inch rebars , 30 inches long, with plastic identification caps.

Bearings are based on the west line of Lot 3, as per the Tanner-L. Heights Subdivision, as being North 29 degrees 20 minutes 00 seconds East, per Plat Book 5, Pages 95, and 96.

This description is written based on a field survey completed April 29, 2010, by Jack D. Newcome, Reg. No. 7321.

**OFFICE COPY  
NOT RECORDABLE**  
Jack D. Newcome, 7321



5-2-10  
Date

Parcel No.- All of: 17-51-03-03-000 + - 3.11 Acres  
(+ - 0.08 Acres in RW of Pinecrest Drive)

DESCRIPTION  
APPROVED  
By: *[Signature]* 5/11/10

**SITUATED IN:**

State of Ohio, County of Muskingum, Township of Falls, and being all of Lot 3, of Tanner-L. Heights Subdivision, as per Plat Book 5, Pages 95, and 96, being a subdivision of Lot 13, of Quarter Township 3, as per DR "P", Page 519, Township 1, Range 8, United States Military Lands.

M. A. Lewis  
DR 498-526

**BASIS OF BEARINGS**

Bearings are based on the west line of Lot 3, of Tanner-L. Heights Subdivision as being North 29 degrees 20 minutes 00 seconds East as per Plat Book 5, Pages 95, and 96.

**REFERENCES**

Pl. Bk. 5, Pg. 95 and 96  
DR "P" Pg. 519  
Survey by J. Spilker

Angle Iron Found at the Northwest Corner of Lot 3, of Tanner-L. Heights Subdivision, as per Plat Book 5, Pages 95, and 96.

D. L. Williams  
DR 1051-41

C. A. Mccloud  
Trustee  
OR 2134-865

Cynthia A. Mccloud  
Trustee  
OR 2134-865  
+- 3.11 Acres

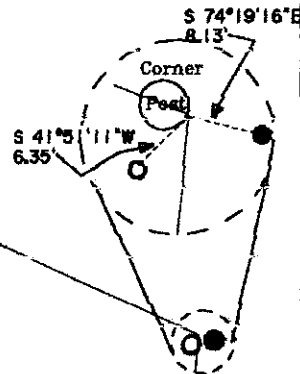

Lot 4

Lot 3

Lot 2

Note: Iron pin found behind fence post is 0.42 feet north and west of property line.

Centerline of Pinecrest Drive  
40' R.W.  
(Per Plat)

Centerline of Pavement

DESCRIPTION  
APPROVED  
By: *[Signature]* 5/11/10

**LEGEND**

- △ Railroad Spike Set
- Iron Pin Found
- ⊞ Stone Found
- Axis Found
- Iron Pipe Found
- ▲ Railroad Spike Found
- ⊙ Iron Pin Set, 5/8" rebar
- ⊞ Monument Found
- L Angle Iron Found

**PARCEL NO.**

All of: 17-51-03-03-000 +- 3.11 Acres  
(+- 0.08 Acres in Pinecrest Drive)

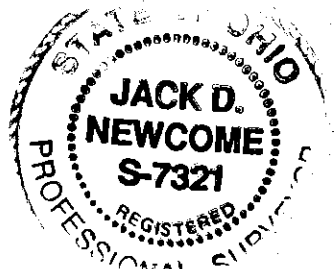

**OFFICE COPY  
NOT RECORDABLE**

5-2-10

Date

Reg. Surveyor No.

Newcome Surveying Company  
6515 Ballard Road  
Nashport, Ohio  
740-452-5796



Graphic Scale in Feet 1" = 200'