

Survey for Zanesville Terrace Properties, LTD.

Being a part of land located in the State of Ohio, County of Muskingum, Falls Township, part of Quarter Township 4, Township 1 North, Range 8 West, United States Military Lands. Being part of the lands conveyed to Zanesville Terrace Properties, LTD., Muskingum County, Ohio in Deed Record 2212, page 246, bounded and described as follows:

Beginning at an iron pin found at the southwest corner of Lot 208 of Licking View Sudivision, (Plat Book 5, page97);

thence along the south line of Lot 208 South 57 degrees 53 minutes 52 seconds East 310.47 feet to a survey nail found in a log, also being the northwest corner of the Board of County Commissioners, Muskingum County, Ohio (DR 2284-526);

thence leaving the said south line of Lot 208 and along the west line of the Board of County Commissioners, Muskingum County, Ohio (DR 2284-526) South 22 degrees 12 minutes 09 seconds West 243.44 feet to an iron pin found, being the northwest corner of Board of County Commissioners, Muskingum County, Ohio (DR 1074-379);

thence along the west line of Board of County Commissioners, Muskingum County, Ohio (DR 1074-379) South 22 degrees 12 minutes 09 seconds West 539.19 feet to a point, being the southwest corner of Board of County Commissioners, Muskingum County, Ohio (DR 1074-379), an iron pin found bearing South 57 degrees 06 minutes 03 seconds East 12.15 feet;

thence along the west line of Coralie Wilson (DR 1062-525) South 22 degrees 12 minutes 09 seconds West 88.88 feet to an iron pin set;

thence leaving the west line of Coralie Wilson (DR 1062-525) and thru the property of Zanesville Terrace Properties, LTD. (DR 2212-246) North 57 degrees 06 minutes 03 seconds West 449.78 feet to an iron pin set on a line of Leroy and Delores Snider (DR 1110-22);

thence along said line of Leroy and Delores Snider (DR 1110-22) North 27 degrees 35 minutes 44 seconds East 248.88 feet to a point, an iron pin found bearing North 82 degrees 33 minutes 41 seconds West 0.60 feet, being the southeast corner of Leroy and Doris Snider (DR 1894-835);

thence along the east line of Leroy and Doris Snider (DR 1894-835) North 27 degrees 35 minutes 44 seconds East 592.53 feet to an iron pin found on the south line of Lot 209 of Licking View Subdivision, (Plat Book 5, page 97);

thence along the south line of Lot 209 South 71 degrees 32 minutes 18 seconds East 57.15 feet to the place of beginning containing 8.00 acres, more or less.

Part of Parcel No.: 17-96-01-13-000 (\pm 8.00 acres)

This legal description was written by Denis P. Swierz based on a field survey completed November 2010 by Muskingum County Engineers' Office. The bearings in this description are based on NAD 83, Ohio South Zone, State Plane Coordinates as per GPS observations from Muskingum County Engineer monument – GPS 58.

Subject to all easements, right of ways, restrictions, reservations, etc.. of record and those that may be implied.

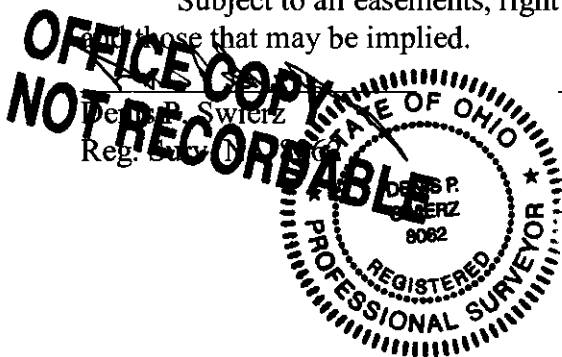

12/17/10
Date

DESCRIPTION
APPROVED

By: [Signature] 12/21/10

PLAT OF SURVEY FOR ZANESVILLE TERRACE PROP., LTD.

STATE OF OHIO, MUSKINGUM COUNTY, FALLS TOWNSHIP,
PART OF QUARTER TOWNSHIP 4, TOWNSHIP 1 NORTH, RANGE 8
WEST, UNITED STATES MILITARY LANDS

LOT 209 T.E. & C. BAUGHMAN
DR 1139-448

LOT 208

PART OF PARCEL NO.:
17-96-01-13-000 ±8.00 ACRES

K.S. MCHENRY
DR 2092-877

C.S. EDWARDS
DR 2092-880

BASIS OF BEARING:

BEARINGS SHOWN HEREON ARE TO AN ASSUMED
MERIDIAN AND ARE USED TO DENOTE
ANGLES ONLY.

PERTINENT DOCUMENTS AND SURVEYS USED:

1. DEED REFERENCES SHOWN
2. TAX MAPS
3. SURVEY RECORDS FOUND IN THE
MUSKINGUM COUNTY ENGINEERS
OFFICE, ZANESVILLE, OHIO

SOUTHWEST CORNER OF
LOT 208 OF LICKING VIEW SUB.
(PLAT BOOK 5, PAGE 97)

LEROY & DORIS SNIDER
DR 1894-835

N 27°35'44" E
592.53 FT

ZANESVILLE TERRACE
PROPERTIES, LTD.
DR 2212-246
±8.00 ACRES

S 22°12'09" W
243.44 FT
BOARD OF COUNTY
COMMISSIONERS,
MUSKINGUM COUNTY, OHIO
DR 2284-526

N 82°33'41" W
0.60 FT

LEROY & DELORES SNIDER
DR 1110-22
N 27°35'44" E
248.88 FT

NOTE:

NOT TO BE TRANSFERRED AS AN INDEPENDENT
PARCEL IN THE FUTURE WITHOUT PLANNING
COMMISSION APPROVAL IN ACCORDANCE WITH
APPLICABLE SUBDIVISION REGULATIONS.

BOARD OF COUNTY
COMMISSIONERS,
MUSKINGUM COUNTY, OHIO
DR 1074-379

DESCRIPTION

APPROVED
By: *[Signature]* 12/21/2010

S 22°12'09" W
539.19 FT

ZANESVILLE TERRACE PROPERTIES, LTD.
DR 2212-246

S 57°06'03" E
12.15 FT

CORALIE WILSON
DR 1062-525

LEGEND

- ⊙ IRON PIN SET $\frac{3}{4}$ " X 30" W/CAP
MARKED "MUSK CTY"
"SWIERZ 8062"
- △ SURVEY NAIL FOUND IN LOG
- IRON PIN FOUND
- POINT

MUSKINGUM COUNTY ENGINEER'S OFFICE

155 REHL ROAD
ZANESVILLE, OHIO 43701
(740) 454-0155

I HEREBY CERTIFY THIS PLAT
TO BE CORRECTLY SURVEYED
ON NOVEMBER 2010

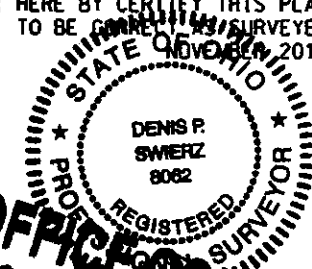

DENIS P.
SWIERZ
PS# 8062
DATE 12/17/10

OFFICE COPY
NOT RECORDABLE