

Phone and Fax: 740-453-8448

## L. Peter Dinan & Associates

27 South Sixth Street

P.O. Box 55, Zanesville, Ohio 43702-0055

SURVEYING & MAPPING

George T. & Maxine E. Ferguson, Tr.

1.02 Acres

Part of Parcel #17-78-04-28-000

Situated in the State of Ohio, County of Muskingum,  
Township of Falls.

Being a part of Lot 6 of Convers Subdivision at the  
County Infirmary Farm as recorded in Plat Book 1, Page 167  
bounded and described as follows:

Beginning at an iron pin found at the southeast corner  
of Lot 10 in Terrace View Subdivision as recorded in Plat  
Book 7, Page 51; thence along the east line of Lot 6 of  
Convers Subdivision south 22 degrees 57 minutes 09 seconds  
west 300.0 feet to an iron pin placed; thence north 67  
degrees 02 minutes 51 seconds west 75.0 feet to an iron  
pin placed; thence north 22 degrees 57 minutes 09 seconds  
east 140.0 feet to an iron pin placed; thence north 43  
degrees 38 minutes 49 seconds west 219.27 feet to an iron  
pin placed; thence north 21 degrees 32 minutes 02 seconds  
east 61.0 feet to an iron pin placed on the south line of  
Terrace View Subdivision; thence along the south line of  
Terrace View Subdivision south 69 degrees 30 minutes 29  
seconds east 278.0 feet to the place of beginning, containing  
one and two hundredths (1.02) acres more or less.

The above described 1.02 acre parcel has been granted  
an easement to be used for ingress and egress and utilities  
installation and maintenance across the following described  
part of a 4.64 acres parcel.

Beginning at the northwest corner of said 4.64 acre  
parcel and at the southwest corner of Lot 15 in Terrace  
View Subdivision; thence along the south line of Lot 15  
south 69 degrees 30 minutes 29 seconds east 25.0 feet to  
an iron pin placed; thence south 21 degrees 32 minutes 02  
seconds west 30.0 feet to a point; thence north 69 degrees  
30 minutes 29 seconds west 25.0 feet to a point on the west  
line of said 4.64 acre parcel; thence north 21 degrees 32  
minutes 02 seconds east 30.0 feet to the place of beginning.

This description written from a survey made by L. Peter  
Dinan, Registered Surveyor #5451, September 24, 2012.

APPROVED  
MUSKINGUM COUNTY  
PLANNING COMMISSION DIRECTOR  
  
10/3/12  
Date Fee Paid

OFFICE COPY  
NOT RECORDABLE



DESCRIPTION

APPROVED

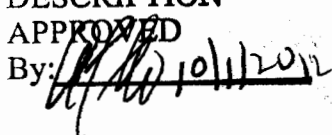
By:  10/11/2012

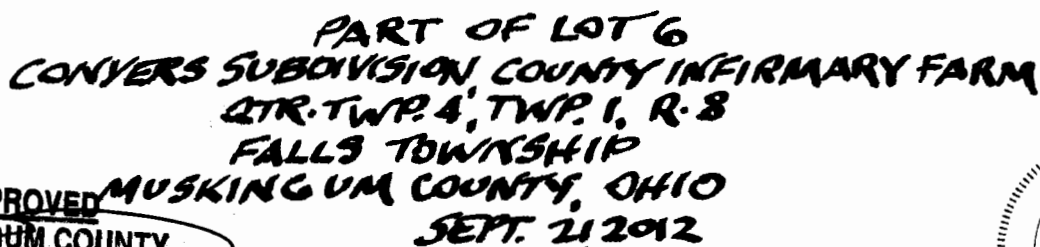
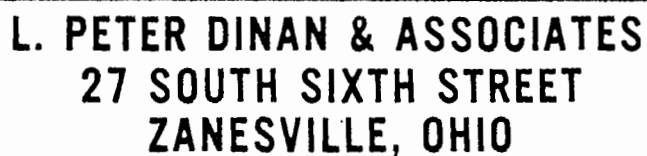

**OFFICE COPY  
NOT RECORDABLE**

10/21, 2  
Date

**Fee Paid**