

DESCRIPTION

APPROVED

By: 2/18/2021

Iron pins set are 5/8 inch rebar, 30 inches long, with plastic identification caps, stamped LINN.

Bearings are based on the Ohio State Plane Coordinate System, NAD 83, South Zone, Grid, as per GPS observations made in February 2018 and October 2022.

This description is written based on a field survey completed November 29, 2022 by Timothy H. Linn, PS, Reg. No. 7113.

**OFFICE COPY**

**NOT RECORDABLE**  
Timothy H. Linn, PS, Reg. No. 7113

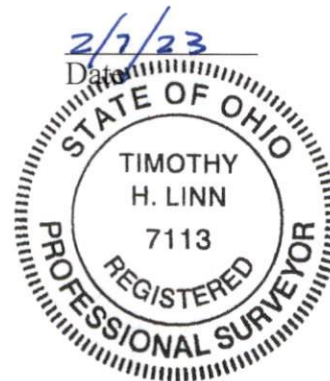

**Parcel Numbers:**

Part of: 08-05-00-00-900	+/- 0.641 acres in Section 7
All of: 08-07-00-00-900	+/- 6.423 acres in Section 8
All of: 08-10-00-00-900	+/- 5.549 acres in Section 9
All of: 20-01-00-00-900	+/- 5.585 acres in Section 10
<u>All of: 20-20-00-00-900</u>	<u>+/- 5.017 acres in Section 30</u>
Total	+/-23.215 acres