

SALT CREEK
BEAGLE
CLUB, INC.
20-30-20-17-000
TOWNSHIP 11 N
RANGE 13 W
SECTION 20
SURVEY (EXCEPT 40
AC.) 110.71 ACRES
DEED IN BOOK 480
PG. 230

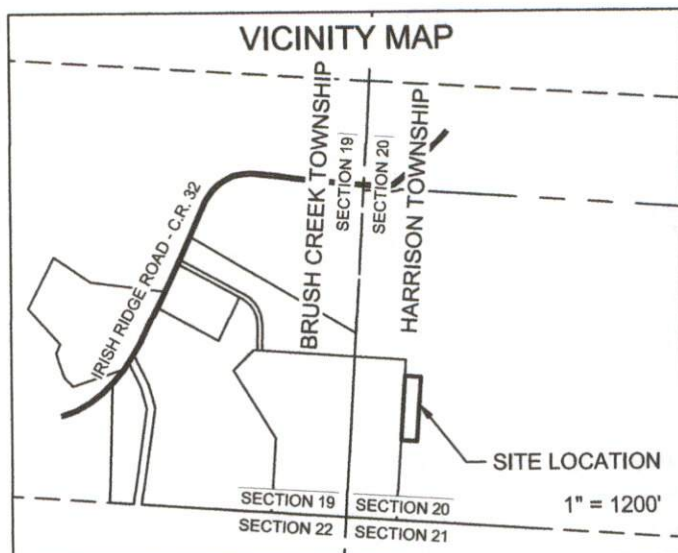

5/8" IRON PIN

5/8" IRON PIN WITH
CAP
"KLEINGERS &
ASSOC"

BRUSH CREEK TOWNSHIP
SECTION 19
SECTION 20
HARRISON TOWNSHIP

APPROVED
MUSKINGUM COUNTY
PLANNING COMMISSION DIRECTOR

Date _____

ROCKIES EXPRESS
PIPELINE, LLC
20-30-20-17-001
7.285 ACRES
TOWNSHIP 11 N
RANGE 13 W
SECTION 20
DEED IN BOOK 2144
PG. 846

Free Paid

PART OF PARCEL
20-30-20-17-000
0.918
ACRES
NO BUILDINGS

DESCRIPTION
APPROVED

By: John 9/19/2022

POINT OF COMMENCEMENT
UTM N ZONE 17
N: 14,469,630.73
E: 1,377,642.21

SE CORNER OF THE SW QUARTER
OF THE SW QUARTER SECTION 20
STONE (FOUND)

- 5/8" IRON PIN SET
WITH CAP "TRC"

- POINT OF BEGINNING
5/8" IRON PIN SET
WITH CAP "TRC"

SECTION 21

N86° 12' 40"W 900.59'

LEGEND

● DENOTES IRON PIN SET
 ○ DENOTES IRON PIN FOUND
 ■ DENOTES STONE FOUND

PROPERTY LINE
ADJOINING PROPERTY LINE
LINE NOT TO SCALE

100 50 0 100

GRAPHIC SCALE IN FEET

NOTES

1. BEARINGS ARE BASED ON THE PLAT IN DEED BOOK 2144 PAGE 846.
2. SOURCE DOCUMENTS ARE AS NOTED.
3. MONUMENTS WERE FOUND IN GOOD CONDITION UNLESS OTHERWISE NOTED.
4. ALL DISTANCE SHOWN HEREON ARE GROUND DISTANCES.
5. NOT TO BE USED AS A SEPARATE BUILDING SITE OR TRANSFERRED AS AN INDEPENDENT PARCEL IN THE FUTURE WITHOUT PLANNING COMMISSION APPROVAL IN ACCORDANCE WITH APPLICABLE SUBDIVISION REGULATIONS.

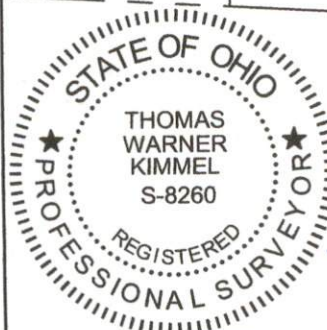

I HEREBY CERTIFY THAT THIS PLAT IS BASED UPON A FIELD SURVEY MADE UNDER MY SUPERVISION IN ACCORDANCE WITH 4733-37 OF THE OHIO ADMINISTRATIVE CODE.

THOMAS WARNER KIMMEL
OHIO PROFESSIONAL SURVEYOR NO. 8260

33-37 OF THE OHIO ADMINISTRATIVE CODE.

OFFICE COPY

S. Warner

NOT RECORDABLE

8/30/2023

S WARNER KIMMEL DATE

REVISIONS		
DATE	REVISION	DESIGNED BY: CRJ
6/12/23	UPDATE BOUNDARY	DRAWN BY: CRJ
		CHECKED BY: TWK
		SCALE: 1"=100'
		DATE: 08/30/2023
		PROJECT NUMBER:
		536514

0.918 ACRE TRACT
TALLGRASS MUSKINGUM COMMUNITY POWER, LLC
HARRISON TOWNSHIP
MUSKINGUM COUNTY, OHIO
SECTION 20, TOWNSHIP 11 NORTH,
RANGE 13 WEST



317 E CARSON ST, SUITE 113
PITTSBURGH, PA 15219