

County Road No. 6, Harrison Twp.,
Muskingum County, Ohio.
4.513 acre tract

DESCRIPTION APPROVED
for Auditor's transfer

Situated in the County of Muskingum, in the State of Ohio, and in the Township of Harrison, and bounded and described as follows:

Being a part of Lot No. 5 of Fractional Section 30, in Township 12, Range 12, according to a plat of said subdivision made by Charles Roberts and recorded in the Recorder's office of said county in Deed Book "S", Page 474, and more particularly described as follows:

Commencing, for reference, at a corner stone found at the southwest corner of Lot No. 4 of the above mentioned subdivision, on the south line of Fractional Section 30, said stone bears North 88 degrees 27 minutes 07 seconds East along the south line of said Section 30 a distance of 2353.56 feet from the southwest corner thereof; thence running North 01 degree 13 minutes 55 seconds West along the west line of said Lot No. 4 a distance of 1257.43 feet to a corner fence post; thence South 88 degrees 15 minutes 58 seconds East and following the line fence marking the southerly lands of Kenneth M. Alexander and Olive M. Alexander (Deed Book 296, Page 583) a distance of 2205.30 feet to a corner fence post; thence North 00 degrees 51 minutes 09 seconds West 1291.98 feet to a point on the north line of said Lot No. 5; thence East along said lot line 129.75 feet to an iron pipe found at the northwest corner of the premises now or formerly owned by Jimmy D. Kern and Linda D. Kern (Deed Book 834, Page 104); thence South 07 degrees 12 minutes 20 seconds East and following the westerly line of said Kern premises and continuing along the westerly line of the premises now or formerly owned by Raymond R. Cruz and Katherine L. Cruz (Deed Book 787, Page 28) a distance of 332.08 feet to an iron pipe found; thence North 82 degrees 46 minutes 00 seconds East along the southerly line of said Cruz tract a distance of 227.10 feet to a railroad spike in the centerline of County Road No. 6, and being the True Place of Beginning of the premises herein intended to be conveyed; thence South 06 degrees 12 minutes 00 seconds East along said centerline 277.65 feet; thence South 06 degrees 49 minutes 40 seconds East along said centerline 119.38 feet to a P.K. nail; thence South 89 degrees 52 minutes 20 seconds West 9.45 feet to a point on the westerly right-of-way line of the Baltimore and Ohio Railroad property; thence South 04 degrees 25 minutes 30 seconds East along said right-of-way line 195.25 feet to the centerline of County Road No. 6; thence along the centerline of said road in a southeasterly direction on a curve to the left having a radius of 77.304 feet a distance of 48.05 feet to a nail driven in the center of the tracks of said railroad (chord bears South 36 degrees 30 minutes 34 seconds East 47.28 feet); thence from said nail, being a point of reverse curve, on a curve to the right having a radius of 96.937 feet a distance of 76.68 feet to a point in the centerline of said road (chord bears South 31 degrees 39 minutes 25 seconds East 74.69 feet); thence South 08 degrees 59 minutes 48 seconds East along said centerline 171.81 feet; thence South 13 degrees 09 minutes 40 seconds East along said centerline 145.33 feet; thence South 19 degrees 36 minutes 16 seconds East along said centerline 106.29 feet to a point of intersection with the center thread of Crow Run; thence following the center thread of Crow Run South 71 degrees 19 minutes 16 seconds East 185.37 feet to a point at the lower end of

**OFFICE COPY
NOT RECORDABLE**

DESCRIPTION APPROVED
for Auditor's transfer

[Signature]

4.513 acre tract - continued

The Muskingum River; thence North 12 degrees 27 minutes 00 seconds West and along said low water mark a distance of 1204.23 feet to the southeast corner of the aforementioned Raymond R. Cruz and Katherine L. Cruz tract; thence South 82 degrees 46 minutes 00 seconds West along the southerly line of said Cruz tract a distance of 130.45 feet to the True Place of Beginning, and containing 4.513 acres, more or less, subject to all legal highways and easements of record.

Surveyed and description written by Jerry Lee Gamble, Registered Surveyor No. 5737 on January 29, 1931.

**OFFICE COPY
NOT RECORDABLE**
Jerry Lee Gamble, Registered Surveyor No. 5737

J. & T. Ribble 589/81

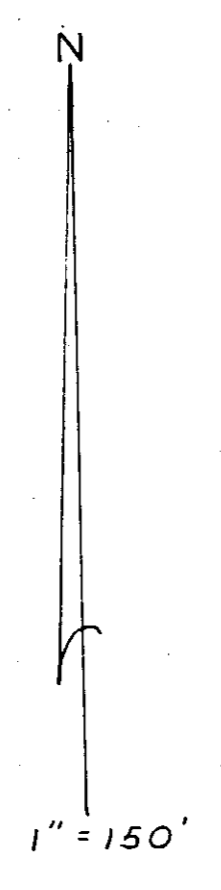

K & O. Alexander 294/583

4

S88°15'48"E
2205.30'

63.10 AC.

C. & M. Flickinger 528/939
10.81 Ac.

D. & L. Bennett 826/32
25.19 Ac.

S.W. Cor. Frac. Sec. 30
T12, R12
2353.56'

South Line of Fractional Section 30, Twp. 12, R. 12
588°27'07"W

North Line of Section 31, Twp. 12, R. 12

J. & M. Dickson 546/323

4.955 AC.

444.60'

588°27'07"W

Map Showing Survey
of
Lands Situated in Sections 30 & 31 of Township 12, Range 12
Harrison Township, Muskingum County, Ohio
Deed Reference: Volume 564, Page 235

I hereby certify that I have surveyed the premises as shown hereon and that
this plat is a correct representation of said

**OFFICE COPY
NOT RECORDABLE**

Jerry Lee Ribble, Registered Surveyor No. 5737
1245 Blue Avenue, Zanesville, Ohio 43701
January 29, 1948

Curve	Delta	Radius	Tan	Length	Chd Bearing	Chd Dist
1	27°00'00"	980.36'	17.68	35.36	N05°27'29"W	35.36'
2	35°36'57"	77.304'	24.83	48.05'	S36°30'34"E	47.28'
3	45°19'18"	95.937'	40.47	76.68	S31°35'25"E	74.49'

Ima Mae Komaromy 663/73

Line of Lot No. 4
N01°13'55"W
1257.43'

Corner Area past

Line fence

Crow Run

Line fence
S01°50'35"W
370.91'

Corner Area past

Gr. Post

Gr. Post

Gr. Post

Gr. Post

Gr. Post

Gr. Post

Gr. Post

Gr. Post

Gr. Post

Gr. Post

Gr. Post

Gr. Post

Gr. Post

Gr. Post

Gr. Post

Gr. Post

Gr. Post

Gr. Post

Gr. Post

Gr. Post

Gr. Post

Gr. Post

Gr. Post

Gr. Post

Gr. Post

462'

115.75'

507.1250'E

832.08'

442'

J. & T. Ribble 831/104
4.438 Ac.

R. & K. Cruz 787/28
1.972 Ac.

227.70'

N82°4'00"E

1130.45'

214.50'

S89°52'20"W

214.50'

N79°11'50"W

408.76'

N65°19'14"W

185.17'

S71°59'12"E

571.5912'E

185.17'

S71°59'12"E

571.5912'E

185.17'

S71°59'12"E

571.5912'E

185.17'

S71°59'12"E

571.5912'E

185.17'

S71°59'12"E

571.5912'E

185.17'

S71°59'12"E

571.5912'E

185.17'

S71°59'12"E

571.5912'E

185.17'

S71°59'12"E

571.5912'E

185.17'

S71°59'12"E

571.5912'E

185.17'

S71°59'12"E

571.5912'E

185.17'

S71°59'12"E

571.5912'E

185.17'

S71°59'12"E

571.5912'E

185.17'

S71°59'12"E

571.5912'E

185.17'

S71°59'12"E

571.5912'E

185.17'

S71°59'12"E

571.5912'E

185.17'

S71°59'12"E

571.5912'E

185.17'

S71°59'12"E

571.5912'E

185.17'

S71°59'12"E

571.5912'E

185.17'

S71°59'12"E

571.5912'E

185.17'

S71°59'12"E

571.5912'E

185.17'

S71°59'12"E

571.5912'E

185.17'

S71°59'12"E

571.5912'E

185.17'

S71°59'12"E

571.5912'E

185.17'

S71°59'12"E

571.5912'E

185.17'

S71°59'12"E

571.5912'E

185.17'

S71°59'12"E

571.5912'E

185.17'

S71°59'12"E

571.5912'E

185.17'

S71°59'12"E

571.5912'E

185.17'

S71°59'12"E

571.5912'E

185.17'

S71°59'12"E

571.5912'E

185.17'

S71°59'12"E

571.5912'E

185.17'

S71°59'12"E

571.5912'E

185.17'

S71°59'12"E

571.5912'E

185.17'

S71°59'12"E

571.5912'E

185.17'

S71°59'12"E

571.5912'E

185.17'

S71°59'12"E

571.5912'E

185.17'

S71°59'12"E

571.5912'E

185.17'

S71°59'12"E

571.5912'E

185.17'

S71°59'12"E

571.5912'E

185.17'

S71°59'12"E

571.5912'E

185.17'

S71°59'12"E

571.5912'E

185.17'

S71°59'12"E

571.5912'E

185.17'

S71°59'12"E

571.5912'E

185.17'

S71°59'12"E

571.5912'E

185.17'

S71°59'12"E

571.5912'E

185.17'

S71°59'12"E

571.5912'E

185.17'

S71°59'12"E

571.5912'E

185.17'

S71°59'12"E

571.5912'E

185.17'

S71°59'12"E

571.5912'E

185.17'

S71°59'12"E

571.5912'E

185.17'

S71°59'12"E

571.5912'E

185.17'

S71°59'12"E

571.5912'E

185.17'

S71°59'12"E

571.5912'E

185.17'

S71°59'12"E

571.5912'E

185.17'

S71°59'12"E

571.5912'E

185.17'

S71°59'12"E

571.5912'E

185.17'

S71°59'12"E

571.5912'E

185.17'

S71°59'12"E

571.5912'E

185.17'

S71°59'12"E

571.5912'E

185.17'

S71°59'12"E

571.5912'E

185.17'

S71°59'12"E

571.5912'E

185.17'

S71°59'12"E

571.5912'E

185.17'

S71°59'12"E

571.5912'E

185.17'

S71°59'12"E

571.5912'E

185.17'

S71°59'12"E

571.5912'E

185.17'

S71°59'12"E

571.5912'E

185.17'

S71°59'12"E

571.5912'E

185.17'

S71°59'12"E

571.5912'E

185.17'

S71°59'12"E