

APPROVED FOR CLOSURE

[Signature] 11/23/2005

EXEMPT FROM
PLANNING COMMISSION

[Signature] 11/23/2005

M. JOHNSON

BEING A PARCEL OF LAND LOCATED IN THE EAST HALF OF THE NORTHEAST QUARTER OF SECTION NO. 14, TOWN NO. 10, RANGE NO. 13, HARRISON TWP., MUSKINGUM COUNTY, OHIO. (BEING A PART OF PARCEL NO. 20-20-90-14-01-00-3).

COMMENCING AT THE NORTHEAST CORNER OF SAID SECTION NO. 14;

THENCE ALONG THE EAST LINE OF SAID SECTION SOUTH 00° 27' 30" EAST 1171.62' TO AN IRON PIN (FD) AT THE NORTHEAST CORNER OF K. CONFER LAND (VOLUME-994, PAGE-378);

THENCE LEAVING SAID EAST LINE AND ALONG THE NORTH LINE OF CONFER LAND NORTH 63° 18' 50" WEST 585.12' TO AN IRON PIN (SET) AND THE POINT OF BEGINNING;

THENCE LEAVING SAID NORTH LINE SOUTH 83° 45' 40" WEST 101.69' TO THE CENTER OF UNION HILL RD. AND THE WEST LINE OF CONFER LAND (REFERENCE: PASSING AN IRON PIN (SET) AT 71.58');

THENCE ALONG SAID ROAD AND SAID WEST LINE NORTH 11° 50' 40" EAST 57.18' TO THE NORTHWEST CORNER OF CONFER LAND;

THENCE LEAVING SAID ROAD AND ALONG THE NORTH LINE OF CONFER LAND SOUTH 63° 18' 50" EAST 100.00' TO THE POINT OF BEGINNING, CONTAINING 0.063 OF AN ACRE.

REFERENCE: BOOK-994, PAGE-378.

REFERENCE BEARING: (ASSUMED MERIDIAN USED TO DENOTE ANGLES ONLY).

IRON PINS (SET) ARE 5/8" REBAR WITH I.D. CAPS (JANES 6029).

THE ABOVE PARCEL SUBJECT TO ALL LEASES, EASEMENTS AND RIGHT OF WAYS OF RECORD.

PLAT OF SAID SURVEY IS ATTACHED HEREWITH AND MADE A PART THEREOF.

THIS DESCRIPTION WAS WRITTEN FROM A SURVEY MADE BY ROBERT A. JANES REGISTERED SURVEYOR NO. 6029

OFFICE COPY
NOT RECORDABLE
OCTOBER 11, 2005



SURVEY FOR MARVIN JOHNSON

BEING A PARCEL OF LAND LOCATED IN THE EAST HALF OF THE N.E. QTR. OF SEC. N^o 14, T-10, R-13, HARRISON TWP, MUSKINGUM CO. OHIO. (BEING A PART OF P.N. 20-20-90-14-01-00-3).

N.E. COR. OF SEC. N^o 14

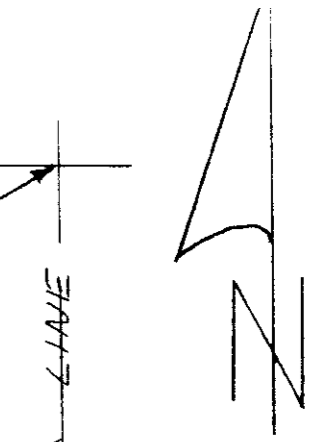
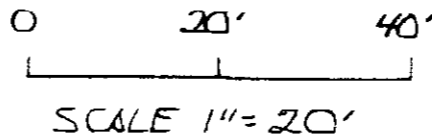

REF. BEARING:

ASSUMED MERIDIAN AND USED TO DENOTE ANGLES ONLY.

E. LINE OF SEC. N^o 14 AS S00°27'30"E

N 11° 50' 40" E
57.18'

ROAD

S 63° 18' 50" E
100.00'

0.063 AC.

M. JOHNSON
4.808 AC.
BK. 1956-710

30.11' IRSET
S 83° 45' 40" W - 101.69'

IRSET P.O.B.

N 63° 12' 50" W

K. CONFER 994-378
LEGEND

- IP = IRON PIN (SET), 5/8" REBAR WITH ID CAP (JANES 6029).
- IP = IRON PIN (FOUND).

APPROVED FOR CLOSURE
[Signature] 11/23/2005

REF:
BK. 994-378

1171.62'

S 00° 27' 30" E

SECTION

UNION HILL

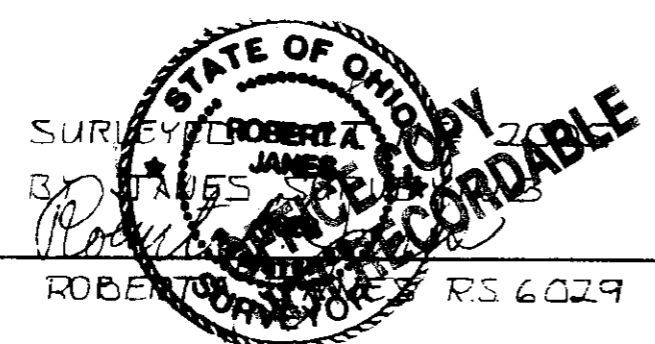

EXEMPT FROM PLANNING COMMISSION
[Signature] 11/23/2005