



www.mcpeeklandsurveying.com LLC  
email: brian@mcpeeklandsurveying.com  
340 Robin Hood Ln., \* Zanesville, Oh 43701 \* 740.704.6073

**Sandra Beatty & Ronald Barr**  
**OR 2566-900**  
**Tract 2**  
**+/-29.751 Ac.**

Being a part of the West Half of Section 1, Township 2, Range 5, Highland Township, Muskingum County, State of Ohio, also being part of the lands in Muskingum County Parcel Number 23-30-01-05-000 and all of the lands in Muskingum County Parcel Number 23-30-01-07-000 now owned by Sandra Beatty & Ronald Barr as recorded in Official Record 2566, Page 900, more fully described as follows.

Beginning for reference at an iron pin found at the northwest corner of the northwest quarter of Section 1, thence with the common line of Highland Township and Monroe Township, South 88 degrees 22 minutes 10 seconds East, 356.46 feet to an iron pin set and the principal place of beginning;

thence continuing with said common line of Highland Township and Monroe Township, South 88 degrees 22 minutes 10 seconds East, 1311.54 feet to an iron pin set on the west line of the lands now owned by Nicholas K. Wilder & James C. Wilder (DR 908-298);

thence with the common line of said Beatty/Barr & Wilder's lands, South 13 degrees 02 minutes 13 seconds East, 753.94 feet to an iron pin set;

thence leaving said common line and going through said Beatty/Barr's lands the following seven courses:

1. South 79 degrees 13 minutes 57 seconds West, 268.16 feet to an iron pin set;
2. South 60 degrees 36 minutes 08 seconds West, 203.87 feet to an iron pin set;
3. South 73 degrees 34 minutes 29 seconds West, 128.27 feet to an iron pin set;
4. South 56 degrees 02 minutes 12 seconds West, 261.89 feet to an iron pin set;
5. South 63 degrees 18 minutes 45 seconds West, 275.60 feet to an iron pin set;
6. North 75 degrees 04 minutes 49 seconds West, 222.24 feet to an iron pin set;
7. North 11 degrees 31 minutes 27 seconds West, 1195.24 feet to the place of beginning, containing 29.751 acres more or less, subject to all legal highways and easements of record.

All bearings described herein are based on the Ohio State Plane Grid Coordinates, NAD83, Ohio South per GPS Observation on.

All iron pins set are 5/8 inch by 30 inch steel rebar with plastic identification caps marked MCPEEK PS8517.

The above described 29.751 acre parcel is based on a field survey made by Brian K. McPeek, PS 8517 of McPeek Land Surveying, LLC on 10/21/2015.



Parcel No.

**Part of: 23-30-01-05-000 (+/- 29.751 ac.)**

**DESCRIPTION**

**APPROVED**

**By:**

*[Signature]* 1/22/16

**SITUATED IN**  
The State of Ohio, County of Muskingum  
Township of Highland and being part of the  
West Half of Sec. 1, T2, R5.

**BASIS OF BEARING**  
Bearings are based on State Plane Grid Coordinates.  
NAD83, Ohio South, per GPS Observation.

**REFERENCES**  
\* As Noted on Plot  
[www.muskingumcountyauditor.org](http://www.muskingumcountyauditor.org)  
[www.mceo.org](http://www.mceo.org)  
<http://recorder.muskingumcounty.org>

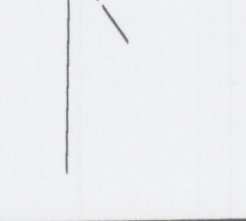
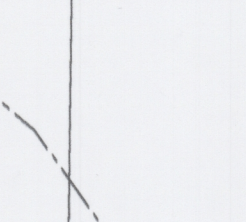
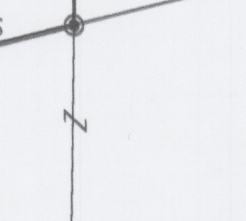
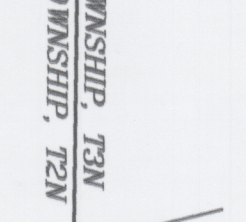
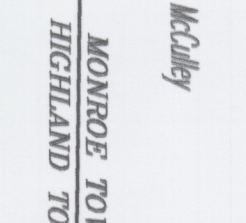
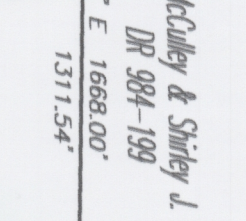
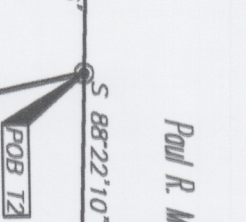
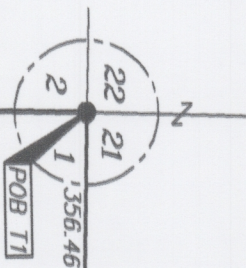

**DESCRIPTION  
APPROVED  
BY:**  
*[Signature]*  
11/28/2016

Nicholas K. Wilder & James C. Wilder  
DR 908-298

Tract 2  
±29.751 Ac.  
Part of: 23-30-01-05-000

CL Dickson Road (T-53)

Kody R. Glebo  
OR 2317-899

Sandra Beatty & Ronald Barr  
OR 2566-900  
Total ±119.005 Ac.

Tract 3  
±29.524 Ac.  
Part of: 23-30-01-05-000

J.J. Detweiler Enterprises, Inc.  
OR 2408-638

Bertha P. Ballantine  
OR 2358-577

Tract 1  
±59.730 Ac.  
Part of: 23-30-01-05-000  
±52.469 Ac.

**OFFICE COPY  
NOT RECORDED**  
*[Signature]*  
12/16  
Brian Kelly McPeck  
Reg. Surveyor No. 8517

**LINE TABLE**

Deborah M. Warren aka Deborah M. Berg  
OR 2513-235

LINE	BEARING	DISTANCE
L1	S 75°04'49" E	222.24'
L2	N 63°18'45" E	275.60'
L3	N 56°02'12" E	261.89'
L4	N 73°34'29" E	128.27'
L5	N 60°36'08" E	203.87'
L6	N 79°13'57" E	268.16'
L7	S 13°02'13" E	50.04'
L8	S 79°13'57" W	261.94'
L9	S 60°36'08" W	201.36'
L10	S 73°34'29" W	126.24'
L11	S 56°02'12" W	155.82'
L12	S 08°08'46" W	157.14'
L13	-	-
L14	S 35°44'56" W	360.24'
L15	S 35°44'56" W	88.00'
L16	S 53°09'54" W	148.58'
L17	N 72°42'48" W	221.06'
L18	N 72°42'48" W	370.00'
L19	N 02°11'50" E	310.77'
L20	S 79°13'57" W	268.16'
L21	S 60°36'08" W	203.87'
L22	S 73°34'29" W	128.27'
L23	S 56°02'12" W	261.89'
L24	S 63°18'45" W	275.60'
L25	N 75°04'49" W	222.24'
L26	N 08°08'46" E	157.14'
L27	N 56°02'12" E	155.82'
L28	N 73°34'29" E	126.24'
L29	N 60°36'08" E	201.36'
L30	N 79°13'57" E	261.94'
L31	S 82°45'53" E	183.21'
L32	N 87°25'13" W	145.86'
L33	S 52°53'06" W	96.36'
L34	S 26°08'06" W	305.58'
L35	N 87°55'44" W	135.66'
L36	N 87°55'03" W	135.00'

William Lewis & Ann Lewis  
OR 1512-406

Stephen J. Lewis & Janice Lewis  
OR 1504-373

Gilbert Colnar & Ann Colnar  
OR 1510-450

Darren Lee Mallett & Tracie L. Mallett  
OR 1756-217

**GRAPHIC SCALE**

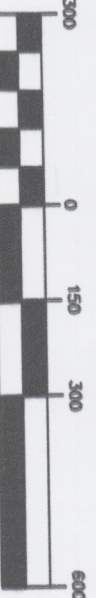

( IN FEET )  
1 inch = 300 ft

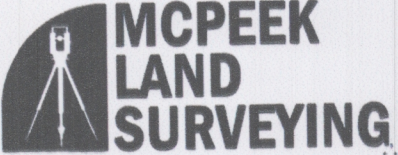
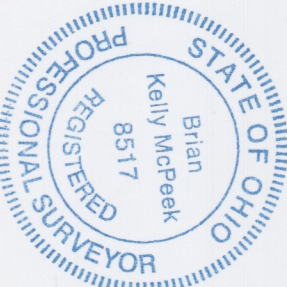

www.mcpeeklandsurveying.com  
email: brian@mcpeeklandsurveying.com  
340 Robin Hood Ln., \* Zanesville, Oh 43701 \* 740.704.6073