

SITUATED IN

NORTHWEST QUARTER OF SECTION 13, T-2, R-5,
UNITED STATES MILITARY LANDS, HIGHLAND
TOWNSHIP, MUSKINGUM COUNTY, OHIO.

PARCEL NUMBER

PART OF: 23-50-13-09-000 ±49.075 AC.
PART OF: 23-50-13-14-000 ±0.730 AC.

NOTES

- APPROXIMATE END OF TOWNSHIP MAINTAINED McCULLEY LANE.
- THE RIGHT OF WAY OF McCULLEY LANE (TR-488) RUNS THROUGH TO SWITZER LANE (TR-488). THE COUNTY HAS NO RECORD OF THE AREA BETWEEN THE ROADS AS BEING VACATED.
- AN INGRESS/EGRESS EASEMENT IS RESERVED WITHIN THE RIGHT OF WAY OF McCULLEY LANE.

REFERENCES

AS SHOWN ON PLAT.
ORIGINAL SURVEY OF T-2, R-5.

BASIS OF BEARINGS

BEARINGS ARE BASED ON NAD 83, OHIO
STATE PLANE COORDINATE SYSTEM, SOUTH
ZONE (GRID), AS PER GPS OBSERVATIONS
MADE ON MARCH 10, 2022.

LEGEND

- IRON PIN SET, 5/8" REBAR W/CAP #7113
- ⊗ STONE FOUND
- IRON PIN FOUND
- P.O.B. PLACE OF BEGINNING
- P.P.O.B. PRINCIPAL PLACE OF BEGINNING

DESCRIPTION

APPROVED

By: *DWB* 5/17/2022

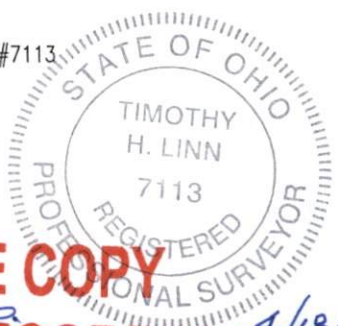

**OFFICE COPY
NOT RECORDABLE**

TIMOTHY H. LINN, P.S.#7113

4/18/22
DATE



Linn Engineering, Inc. 740-452-7434
Civil Engineering Consultants
P.O. Box 2086 Zanesville, Ohio 43702-2086