

Situated in the State of Ohio, County of Muskingum, Township of Hopewell:

Being part of Lot 3, of Quarter Township 3, of Township 1, Range 9, of the US Military District, being part of the Ronald L Zwahlen and Genny Zwahlen property recorded in Deed Book Volume 1046, Page 332, of said county's deed records, further being part of Muskingum County Auditor's Parcel Number 25-40-41-21-000, and more particularly described as follows;

Commencing at an iron pin (found) at the common corner for Lots 3,4,11, & 12 of said Quarter Township 3;

- TIE-1 THENCE South 87 degrees 43 minutes 45 seconds East 1553.84 feet along the common line for said Lots 3 and 4 to an unmarked point in the centerline of Flint Ridge Road (County Road 8), passing iron pins (found) at 1317.01 feet and 1523.84 feet;
- TIE-2 THENCE along a curve to the right having, a chord bearing South 24 degrees 51 minutes 25 seconds East 209.57 feet, a radius of 592.78 feet, and arc length of 210.68 feet, into said Lot 3 and along said road to an unmarked point;
- TIE-3 THENCE South 14 degrees 40 minutes 30 seconds East 119.84 feet continuing along said road to an unmarked point;
- TIE-4 THENCE along a curve to the left having, a chord bearing South 20 degrees 30 minutes 40 seconds East 86.18 feet, a radius of 423.74 feet, and arc length of 86.33 feet, continuing along said road to the unmarked place of beginning for the property herein intended to be described;
- #1- THENCE along a curve to the left having, a chord bearing South 32 degrees 13 minutes 50 seconds East 86.88 feet, a radius of 423.74 feet, and arc length of 87.03 feet, continuing along said road to an unmarked point;
- #2- THENCE South 38 degrees 06 minutes 55 seconds East 119.33 feet continuing along said road to an unmarked point;
- #3- THENCE South 40 degrees 44 minutes 15 seconds West 339.97 feet leaving said road and through said Zwahlen property to an iron pin (set), passing an iron pin (set) at 62.40 feet;
- #4- THENCE North 39 degrees 14 minutes 35 seconds West 205.27 feet continuing through said Zwahlen property to an iron pin (set)
- #5- THENCE North 41 degrees 03 minutes 40 seconds East 352.77 feet continuing through said Zwahlen property to the place of beginning, passing an iron pin (set) at 298.45 feet, containing 1.59 acres, of which 0.12 acres are within the right of way for Flint Ridge Road (County Road 8).

**ALSO AN EASEMENT FOR INGRESS AND EGRESS**

Also an easement for ingress and egress beginning at the most Eastern corner of the the above described 1.59 acre parcel, located in the centerline of Flint Ridge Road (County Road 8);

- E1- THENCE South 38 degrees 06 minutes 55 seconds East 49.58 feet along said road to a railroad spike (found);
- E2- THENCE South 38 degrees 53 minutes 30 seconds East 87.90 feet continuing along said road to an unmarked point;
- E3- THENCE South 51 degrees 06 minutes 30 seconds West 40.00 feet leaving said road and through said Zwahlen property to an unmarked point;
- E4- THENCE North 48 degrees 12 minutes 15 seconds West 127.93 feet continuing through said Zwahlen property to an iron pin (set) on the Southeastern line of the above described 1.59 acre parcel;
- E5- THENCE North 40 degrees 44 minutes 15 seconds East 62.40 feet along said 1.59 acre parcel to the place of beginning for this easement.

The bearings within this description are based on State Plane Coordinate Grid (Ohio South 1983) derived from GPS Observations. Iron pins (set) are 5/8" rebar with identification caps (C.R.Harkness P.L.S.6885).

This description was written by Charles R. Harkness Professional Land Surveyor #6885 from an actual survey completed on May 20, 2009 in accordance with Chapter 4733-37 of the Administrative Code, and is intended to be used for the legal transfer of the property described and does not intend to describe all or any easements of record, nor encroachments unless otherwise indicated.

*Charles R. Harkness*  
Charles R. Harkness P.L.S. #6885



APPROVED  
MINOR LOT SPLIT ONLY  
MUSKINGUM COUNTY  
PLANNING COMMISSION DIRECTOR

*[Signature]*  
Date: 6/9/09 Fee Paid: \_\_\_\_\_

DESCRIPTION APPROVED  
By: *[Signature]*

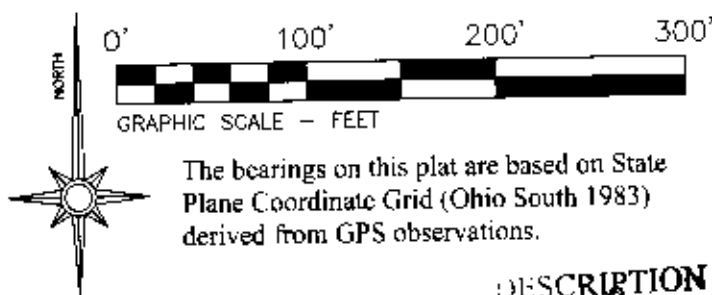

The bearings on this plat are based on State Plane Coordinate Grid (Ohio South 1983) derived from GPS observations.

**LEGEND**

- PIN (SET) 5/8" REBAR CAPPED (C R HARKNESS PLS#6885)
- PIN (FOUND)
- △ POINT (UNMARKED)
- ⊙ RAILROAD SPIKE (FOUND)

DESCRIPTION APPROVED  
By: *[Signature]*

Approved For Transfer  
On Lot Sewage Proposed  
Date 6/8/09

Zanesville-Muskingum County  
Health Department

Situated in the State of Ohio, County of Muskingum, Township of Hopewell:

Being part of Lot 3, of Quarter Township 3, of Township 1, Range 9, of the US Military District, being part of the Ronald L Zwahlen and Genny Zwahlen property recorded in Deed Book Volume 1046, Page 332, of said county's deed records, further being part of Muskingum County Auditor's Parcel Number 25-40-41-21-000:

**SURVEYOR'S NOTES AND REFERENCES:**

- Muskingum County Tax Maps and Orthophotos of the area.
- Note #1- No right of way width was found for Flint Ridge Road (County Road 8), 50 feet wide was used to calculate the area within the right of way, 0.12 acres.
- Note #2- Existing Oil/Gas Well Lease Road crosses the surveyed 1.59 acre parcel.
- Note #3- Tie point 4.00 feet from Zwahlen/Secoy property corner.



**APPROVED**  
**MINOR LOT SPLIT ONLY**  
**MUSKINGUM COUNTY**  
**PLANNING COMMISSION DIRECTOR**  
Date 6/9/09 Fee Paid

This plat was prepared by C.R. Harkness Surveying & Mapping Inc. in accordance with Chapter 4733-37 of the Administrative Code, and is intended to be used for the legal transfer to describe all or any easements of record, nor encroachments unless otherwise indicated.

**OFFICE COPY**  
**NOT VALIDABLE**  
Charles R. Harkness PLS #6885

SURVEY FOR: <b>Ronald L &amp; Genny Zwahlen</b>		HARKNESS SURVEYING & MAPPING, INC. 8205 OLD TOWN ROAD ROSEVILLE, OHIO 43777 PHONE/FAX (740) 849-0122	
QTR TWP:3 TWP:1 RANGE:9		JOB NUMBER Job# 1777	DRAWING / SHEET NUMBER Plat #01
TWP:Hopewell CO:Muskingum ST:Oh		SURVEYED: 5-20-09 DRAWN: 5-21-09	

CURVE	CHORD BEAR	CHORD LEN	RADIUS	ARC LEN
C1	S 24°51'25" E	209.57'	592.78'	210.68'
C2	S 20°30'40" E	86.18'	423.74'	86.33'
C3	S 32°13'50" E	88.88'	423.74'	87.03'

