

DESCRIPTION

Situated in Jackson Township, Muskingum County, State of Ohio and being a part of the Southwest Quarter of Section 20 in the Fourth Quarter of Township 3 North, Range 9 West, United States Military Lands, also being a part of the lands conveyed to Larry A. Minnich and Allen B. Minnich by a deed recorded in Book 1814, Page 5, Muskingum County Recorders Office, more fully described as follows:

It is the intent of this description to describe that portion of Minnich lands lying on the Northerly side of the center line of Hedges Lane (Township Road 642).

Beginning for a point of reference at a stone found at the Southwest corner of Section 20 and also being the Southwest corner of the lands of Tina Wise (Book 2293, Page 569);

thence S 89° 52' 34" E along the South line of the lands of Tina Wise, a distance of 751.07 feet to a point marked by a iron pin found marked "Binckley 7879", and being the Southeast corner of the lands of Tina Wise, also being the Southwest corner of the said Minnich lands;

thence N 0° 33' 47" W along the line common to the lands of said Wise and Minnich, a distance of 981.65 feet to a point on the center line of Hedges Lane and being the True Point of Beginning of the herein described tract, passing a iron pin found capped "Morris 7347" at 951.65 feet;

thence continuing N 0° 33' 47" W along the Westerly line of Minnich lands, a distance of 13.63 feet to a point marking the Northwesterly corner of Minnich lands;

thence N 67° 26' 13" E a distance of 65.54 feet to a point;

thence N 83° 24' 20" E on the Westerly projection of the center line of Hedges Lane, a distance of 73.96 feet to a point of curvature on the center line of Hedges Lane, passing a P.K. nail set at 33.96 feet;

thence Southwesterly along the curved center line of Hedges Lane (Concave to the South) to the point of tangency, which bears S 65° 36' 43" W, a distance of 40.00 feet from said P.K. nail set, Curve Data Being, Delta = 17° 47' 37", Radius = 255.53 feet, T = 40.00feet, Chord = S 74° 30' 32" W 79.04feet;

thence S 65° 36' 43" W along the center line of Hedges Lane, a distance of 63.35 feet to the True Point of Beginning.

Containing 0.0237 acre as surveyed by Kenneth C. Varner, Reg. Surveyor No. 4508 in June 2013.

Bearings are based on those in title of adjoining lands of Christopher M. and Molly B. Lemley whose title is recorded in Book 1682, Page 633.

Auditor Parcel No. 29-50-20-17-000 – Part

“Not to be used as a separate building site or transferred as an independent parcel in the future without planning commission approval in accordance with applicable subdivision regulations. Parcel to be combined to Auditor’s Parcel Number 29-50-20-33-000.

Subject to all valid and existing building and other restrictions and conditions of record, to all valid and existing zoning laws, ordinances and resolutions, to all valid and existing easements of record.

DESCRIPTION APPROVED
By: *[Signature]* 7/15/13

Kenneth C. Varner
Reg. Surveyor No. 4508
June 25, 2013

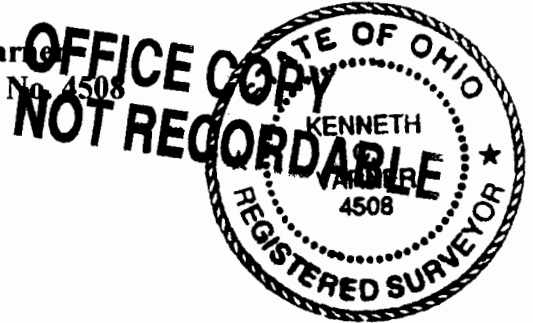

APPROVED
MUSKINGUM COUNTY
PLANNING COMMISSION DIRECTOR
[Signature]
Date: 7/15/13 Fee Paid: -

Kenneth C. Varner
Reg. Surveyor No. 4508

Plat of Survey for Larry A. & Allen B. Minnich
 Jackson Twp. - Muskingum Co. - State of Ohio
 Section 20 - Fourth Qtr. - T3N-R9W-USML

☐ = Stone Found ● = Iron Pin Found —X— = Fence

○ = Iron Pin Set 5/8" X 30" rebar capped KCV4508

Scale 1 inch = 100 feet

○ = Unmarked Point (3) ○ = P.K. Nail Set

Village of Frazersburg
1808/589

Shannon Rd

Sharon Hedges
948/159
Hedges Lane

Jay H. Salvage
812/9217

1553/757
Samuel W.
Hedges Jr.
Hedges Lane

True POB

0.0237 Ac.

29-50-20-17-000 Part

APPROVED
 MUSKINGUM COUNTY
 PLANNING COMMISSION DIRECTOR

7/15/13

	Date	Fee Paid
①	N 0°33'47" W	13.63'
②	N 67°26'13" E	65.54'
③	N 83°24'20" E	73.96'
④		33.96'
⑤	Δ = 17°47'37" R = 255.53'	
	T = 40.00'	
	Chd. = S 74°30'32" W	79.04'
⑥		40.00'
⑦	S 65°36'43" W	63.35'

Larry A. & Allen B. Minnich
1814/5

Approved for Transfer
 No On-Lot Sewage
 Zanesville-Muskingum Co.
 Health Department

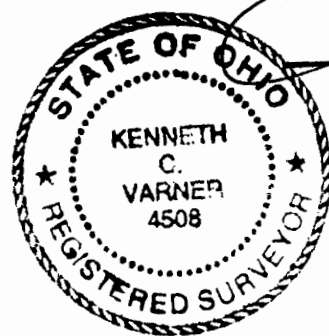

DESCRIPTION
 APPROVED
 By: *[Signature]* 7/15/13

I hereby certify that this Plat represents a true and correct survey and all measurements were made in accordance with Chap. 4733-37 of the Ohio Adm. Code.

Kenneth C. Varner
 Reg. Surveyor
 June 25, 2013
**OFFICE COPY
 NOT RECORDABLE**

Bearings are based on those in title of adjoining lands of Christopher M. and Molly B. Lemley whose title is recorded in Book 1682, Page 633.

Tina Wise 2293/569
 N 0°33'47" W

951.65'

981.65'

Village of Frazersburg
291/47

S 89°52'34" E
751.07'

Ref. POB
 Southwest Corner
 Section 20

Stephen R. McCann, et al
1129/364

Marilyn B. Mitchell 1814/916

William D. Minnich
1814/920