

Page 2 of 3  
Description of Parcel # 5 (5.000 Acres)

Subject to the 100-year Flood Plain restrictions, if applicable.

All iron pins set are 5/8" x 30" rebar capped and labeled "Biedenbach Surveying, LLC.  
PS 7881".

The bearings in this description are for angle calculations only and are based on the northern  
portion of east line of the northeast quarter of Section 16 used as a grid bearing of  
North 02°54'53" East.

A plat of the above-described survey has been submitted for file at the County Engineer's Office.

The above description prepared by Gregory A. Biedenbach, Ohio Registered Surveyor No. 7881,  
based on information obtained from an actual field survey of June 10, 2021. Said survey being  
subject to any facts that may be disclosed in a full and accurate title search.

Prior Deed: Volume 2991, Page 706.

*June 10, 2021* **OFFICE COPY**  
*Gregory A. Biedenbach* **NOT RECORDABLE**  
Date Gregory A. Biedenbach  
Ohio Registered Surveyor  
No. 7881.

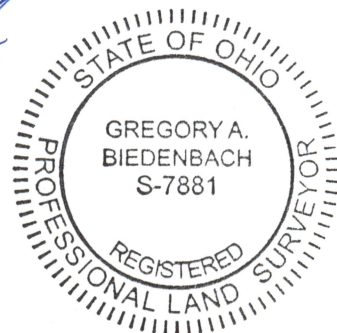

Cc: Survey File: GB-3752F

DESCRIPTION

APPROVED

By: *pc 7/13/21*

**APPROVED**  
**MUSKINGUM COUNTY**  
**PLANNING COMMISSION DIRECTOR**  
*[Signature]*  
Date *7/13/21* Fee Paid *-*