

- 32) South 10 degrees 47 minutes 20 seconds East 16.70 feet;
- 33) South 22 degrees 07 minutes 38 seconds East 17.61 feet;
- 34) South 26 degrees 22 minutes 54 seconds East 88.44 feet to an iron pin set;
- 35) South 16 degrees 32 minutes 16 seconds East 19.74 feet;
- 36) South 00 degrees 31 minutes 07 seconds East 36.35 feet;
- 37) South 21 degrees 37 minutes 01 seconds West 34.39 feet;
- 38) South 12 degrees 17 minutes 52 seconds West 48.90 feet;
- 39) South 25 degrees 53 minutes 51 seconds West 37.09 feet;
- 40) South 22 degrees 18 minutes 20 seconds West 21.72 feet;
- 41) South 13 degrees 16 minutes 02 seconds West 24.45 feet to an iron pin set;
- 42) South 19 degrees 09 minutes 03 seconds West 127.00 feet to the place of beginning, containing 5.983 acres, more or less, subject to all easements and right of ways, written or implied.

Iron pins set are 5/8 inch rebar, 30 inches long, with plastic identification caps.

Bearings are based on the Ohio State Plane Coordinate System, NAD 83, North Zone, Grid North as per GPS observations made on November 8, 2018.

This description is written based on a field survey completed March 29, 2019 by Timothy H. Linn, PS, Reg. No. 7113.

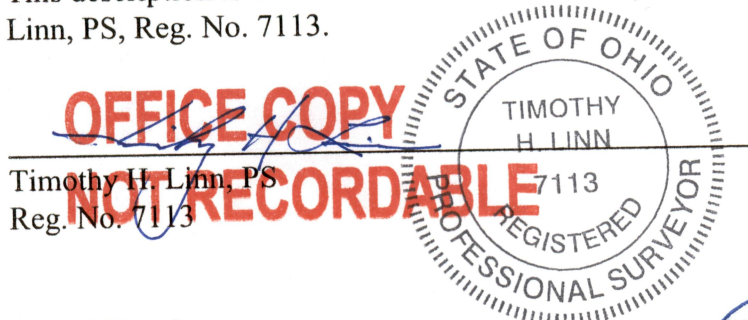

Timothy H. Linn, PS  
Reg. No. 7113

4/10/19  
Date

**Parcel Number:**

All of: 47-70-20-16-001 +/- 0.500 acres  
Part of: 47-70-20-16-000 +/- 5.483 acres

**APPROVED**  
**MUSKINGUM COUNTY**  
**PLANNING COMMISSION DIRECTOR**  
9.00  
4/15/19  
Date Fee Paid

DESCRIPTION  
APPROVED  
By: [Signature] 4/16/2019