

47-70-21-08-010 A

Page 2 of 2

Description of Parcel No. 2A (5.003 Acres)

Subject to the 100-Year Flood Plain restrictions, if applicable.

All iron pins set are 5/8" x 30" rebar capped "Biedenbach Surveying, LLC. 7881".

The bearings in this description are for angle calculations only and are based on the north line of the southeast quarter of Section 21 used as an assumed bearing of South 86°38'14" East.

A plat for the above-described survey has been submitted for file at the County Engineer's Office.

The above description was prepared by Gregory A. Biedenbach, Registered Surveyor No. 7881, based on an actual field survey of April 8, 2020; said survey being subject to any facts that may be disclosed in a full and accurate title search.

Prior deeds: Official Records Volume 2860, Page 517.

Surveyor: Gregory A. Biedenbach
Date: April 8, 2020
Survey File: GB-3446

DESCRIPTION

APPROVED

By: Matthew

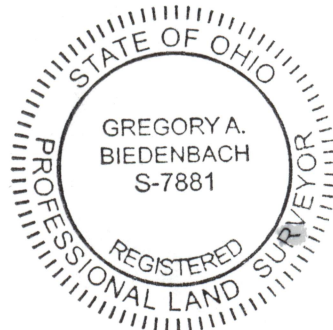

APPROVED
MUSKINGUM COUNTY
PLANNING COMMISSION DIRECTOR
4/28/2020
Date Fee Paid