

SURVEY FOR MAXINE MONLUX

AUDITORS PARCEL NUMBER
51-51-10-02-04-000 (ALL)

BEING ALL OF THE PARCEL CONVEYED TO MAXINE V. MONLUX IN O.R. VOLUME 2834, PAGE 97 OF THE MUSKINGUM COUNTY OFFICIAL RECORDS, SITUATED IN THE SOUTHWEST QUARTER OF SECTION 2, TOWNSHIP 1, RANGE 6, OF THE UNITED STATES MILITARY LANDS, PERRY TOWNSHIP, MUSKINGUM COUNTY, OHIO.

BEARINGS ARE BASED ON OHIO STATE PLANE COORDINATE SYSTEM 1983(2011), OHIO SOUTH ZONE, GRID, DERIVED FROM A GPS OBSERVATION.

DESCRIPTION
APPROVED

By: *DA4/8/hoig*

NOTE 1: THE SOUTHWEST CORNER OF SECTION 2 BY PREVIOUS SUBDIVISION SURVEY (S.M. BOWMAN 2004) WAS NOT HELD AS THE SECTION CORNER FOR THIS SURVEY. EXISTING IRON PINS FROM PREVIOUS SURVEY OF DOSCH PARCEL BY J.R. MARSHALL IN 1968 WERE USED TO ESTABLISH THE SECTION CORNER.

NOTE 2: FOR DETAILS ON IRON PINS FOUND AND IRON PINS SET BETWEEN DANIEL MONLUX AND CURTIS MARLING SEE SURVEY FOR CURT MARLING AND DAN MONLUX (4 PARCELS) COMPLETED BY BASELINE SURVEYING ON MARCH 15, 2019.

NOTE 3: SECTION LINE (SOUTH LINE OF SECTION 2) AND QUARTER SECTION LINE (EAST LINE OF THE SOUTHWEST QUARTER OF SECTION 2) AS ESTABLISHED BY PREVIOUS SURVEYS OF THE DANIEL MONLUX AND CURTIS MARLING PARCELS, COMPLETED BY R.L. DANIELS IN 1988, WERE NOT HELD FOR THIS SURVEY.

NOTE 4: FLOOD ZONE A (NO BASE FLOOD ELEVATION) IS GRAPHICALLY PLOTTED FOR REFERENCE ONLY. THE EXACT LOCATION CAN ONLY BE DETERMINED BY AN ELEVATION CERTIFICATE.

LEGEND

- EXISTING IRON PIN
- ⊙ IRON PIN SET (5/8" REBAR W/CAP)
- ANGLE POINTS

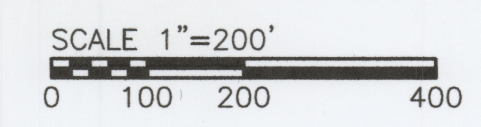

RESEARCH

DEEDS AS SHOWN
PREVIOUS SURVEY OF A 0.664 AC. PARCEL COMPLETED APRIL 5, 1988 BY R.L. DANIELS PS5410
PREVIOUS SURVEY OF A 5.45 AC. PARCEL COMPLETED APRIL 5, 1988 BY R.L. DANIELS PS5410
PREVIOUS SURVEY OF A 1.9720 AC., 0.9761 AC., 0.6836 AC., AND A 2.4889 AC. PARCEL COMPLETED MAY 17, 1975 BY J.L. GAMBLE PS5737
PREVIOUS SURVEY OF A 1.4852 AC. PARCEL COMPLETED DEC. 10, 1977 BY J.L. GAMBLE PS5737
PREVIOUS SURVEY OF HARVEST HILLS ESTATES COMPLETED OCT. 1, 2004 BY S.M. BOWMAN PS7135
PREVIOUS SURVEY OF AN 8.37± AC. PARCEL COMPLETED APRIL 8, 1968 BY J.R. MARSHALL PS5307
PREVIOUS SURVEY OF A 54.105 AC. PARCEL COMPLETED NOV. 22, 2018 BY J. LEACHMAN PS8536
PREVIOUS SURVEY OF A 78.743 AC. PARCEL COMPLETED NOV. 6, 2018 BY J. LEACHMAN PS8536
MUSKINGUM COUNTY GIS

THIS PROPERTY IS SUBJECT TO ALL APPLICABLE EASEMENTS, RIGHT OF WAYS, OR RESTRICTIONS, WHETHER RECORDED OR IMPLIED. THIS PLAT, PREPARED IN ACCORDANCE WITH CHAPTER 4733-37 OF THE ADMINISTRATIVE CODE, IS INTENDED FOR THE LEGAL TRANSFER OF THE PROPERTY SHOWN AND DOES NOT INTEND TO SHOW ANY OR ALL OF THE EASEMENTS, RIGHT OF WAYS, RESTRICTIONS OR ENCROACHMENTS UNLESS OTHERWISE INDICATED.

I, JASON LEACHMAN, HEREBY CERTIFY TO THE BEST OF MY KNOWLEDGE AND BELIEF THE ABOVE PLAT AND SURVEY TO BE CORRECT AS PREPARED BY ME, THIS 21st DAY OF MARCH, 2019, FROM A FIELD SURVEY COMPLETED THE 19th DAY OF MARCH, 2019.
NOT RECORDED
JASON LEACHMAN
PROFESSIONAL SURVEYOR #8536

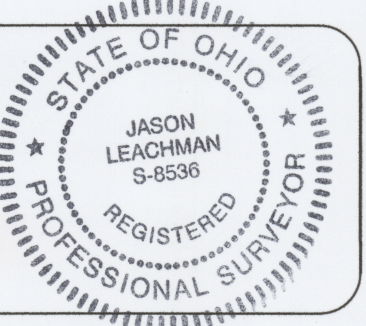

DRAWN BY: JWL	DATE: 03-21-19	SCALE: 1"=200'
CHECKED BY: MDN	JOB NO: 6157	Z:\6139\6139 MONLUX SWEETHEART.dwg

BASELINE SURVEYING, INC.
3010 EAST PIKE, ZANESVILLE, OHIO 43701
phone: 740-453-4850, email: BE@rhhio.com