



**Linn Engineering, Inc.**

*Civil Engineering Consultants*

740-452-7434 • 1-800-991-7434 • FAX 740-452-5198

534 Market Street • P.O. Box 2086 • Zanesville, Ohio 43702-2086

51-60-02-05

SPR

**CONVEYANCE TO:  
LITTLE FAMILY PARTNERSHIP  
PARCEL THREE**

Situated in the State of Ohio, County of Muskingum, Township of Perry, bounded and described as follows:

Being a part of Quarter Township 3, Township 1 North, Range 6 West, United States Military Lands and being more particularly described as follows:

Beginning at a point 172.53 feet right of Interstate 70 centerline station 231+64.27 as designated and delineated on Muskingum County Plat Book 10, Page 58, from which an iron pipe found bears North 26 degrees 06 minutes 35 seconds West 0.47 feet;

thence along the south right of way of Interstate 70 North 60 degrees 09 minutes 32 seconds East 118.35 feet to an iron pin set;

thence through lands now owned by Buckeye Motor Lodge, Inc. (DR 532-80) South 29 degrees 58 minutes 28 seconds East 201.52 feet to an iron pin set;

thence continuing through said Buckeye Motor Lodge, Inc. lands (DR 532-80 and DR 530-772) North 60 degrees 15 minutes 27 seconds East 147.21 feet to an iron pin set;

thence continuing through said Buckeye Motor Lodge lands (DR 530-772) the following four courses:

- 1) South 37 degrees 32 minutes 58 seconds East 39.95 feet to an iron pin set;
- 2) South 20 degrees 11 minutes 14 seconds East 84.92 feet to an iron pin set;
- 3) South 08 degrees 34 minutes 23 seconds East 159.38 feet to an iron pin set;
- 4) South 14 degrees 09 minutes 31 seconds East 132.68 feet to an axle found on the north right of way of US Routes 40/22;

thence along said north right of way of US Routes 40/22 the following two courses:

- 1) South 59 degrees 43 minutes 51 seconds West 202.79 feet to a point;
- 2) South 56 degrees 08 minutes 54 seconds West 87.00 feet to an iron pin set ;

thence through lands now owned by Buckeye Motor Lodge, Inc. (DR 604-3) the following two courses:

- 1) North 32 degrees 27 minutes 43 seconds West 183.30 feet to an iron pin set;
- 2) South 66 degrees 12 minutes 04 seconds West 146.65 feet to an iron pin found on the northeast corner of lands now owned by Ron, Sr. and Marlene Parrill (DR 881-30);

thence along said Parrills' north line North 82 degrees 26 minutes 31 seconds West 140.05 feet to an iron pin found Parrills' northwest corner;

thence along Parrills' west line South 38 degrees 01 minutes 46 seconds East 17.39 feet to an iron pin found;

thence along the south line of lands now owned by Litle Family Partnership (DR 1076-156 and DR 1793-894) the following two courses:

- 1) South 74 degrees 54 minutes 42 seconds West 111.39 feet to an iron pin found;
- 2) South 74 degrees 48 minutes 57 seconds West 1087.82 feet to an iron pin found on the east line of lands now owned by Duane Huddleston (DR 1122-390);

thence along said Huddleston's east line North 41 degrees 21 minutes 01 seconds West 45.83 feet to an iron pin found on said south right of way of Interstate 70;

thence along said south right of way the following two courses:

- 1) North 60 degrees 49 minutes 41 seconds East 484.60 feet to an iron pin found on the northeast corner of said Litle Family Partnership (DR 1793-894);
- 2) North 60 degrees 10 minutes 32 seconds East 1073.82 feet to the principal place of beginning, containing 11.91 acres, more or less, subject to all legal road right of ways and applicable easements, written or implied.

Iron pins set are 5/8 inch diameter by 30 inch long rebar with plastic identification caps.

Bearings are based on the centerline survey of Interstate 70 between Stations 235+00 and 242+15 as bearing North 60 degrees 50 minutes 21 seconds East as depicted on 1962 Centerline Survey as recorded in Muskingum County Plat Book 10, Page 58.

This description is written based on a survey completed February 18, 2004 by Timothy H. Linn, Reg. No. 7113.

**OFFICE COPY  
NOT RECORDABLE**

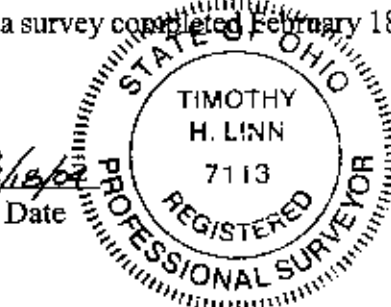

**Parcel Nos.**

- Part of 51-60-02-01-000 (0.46 ac.)
- Part of 51-60-02-02-000 (1.48 ac.)
- Part of 51-60-02-03-000 (2.20 ac.)
- Part of 51-60-02-05-000 (6.47 ac.)
- Part of 51-60-02-06-000 (1.30 ac.)
- Total Acreage: 11.91 ac.

DESCRIPTION APPROVED  
FOR AUDITOR'S TRANSFER  
BY [Signature]  
3-4-2004