

PS

**DEED DESCRIPTION FOR  
MARILYN L. MOORE  
PARCEL 1 OF SURVEY**

Situated in the Township of Rich Hill, County of Muskingum, and State of Ohio, and being 42.462 acres of land in the southeast quarter of Section 12 and 73.744 acres of land in the northeast quarter of Section 13, Township 13N, Range 11W of the "Congress Lands East of the Scioto River" and being more particularly described as follows:

Commencing at an iron pin set at the southwest corner of the northeast quarter of Section 13, the BEGINNING; thence  $N02^{\circ}13'35''E$  with the west line of said northeast quarter a distance of 542.75 feet to an iron pin set; thence leaving said west line  $N72^{\circ}23'30''E$  with the land of Sandra L. and Arthur L. Herron as recorded in Deed Volume 992, Page 226 a distance of 527.51 feet to a point in the center of County Road 203 ( passing on line iron pins found at distances of 2.38 feet and 508.51 feet ); thence with the center of said road and the land of said Sandra L. and Arthur L. Herron the following three courses:

[1]  $N30^{\circ}20'40''W$  a distance of 456.90 feet to a point;  
[2]  $N31^{\circ}48'36''W$  a distance of 199.28 feet to a point;  
[3]  $N36^{\circ}42'47''W$  a distance of 220.69 feet to a point on the quartersection line;  
thence leaving said road  $N02^{\circ}13'35''E$  with the west line of said northeast quarter and the land of Sandra L. and Arthur L. Herron as recorded in Deed Volume 992, Page 221 a distance of 71.67 feet to an iron pin set; thence continuing  $N02^{\circ}13'35''E$  with said west line a distance of 735.08 feet to a point ( witnessed by a 3/4" iron pipe found that bears  $S87^{\circ}46'25''E$  a distance of 8.24 feet ); thence continuing  $N02^{\circ}13'35''E$  with said west line and the land of Arthur W. Huhn as recorded in Deed Volume 982, Page 523 a distance of 415.96 feet to an iron pin set at the northwest corner of the northeast quarter of Section 13; thence  $N02^{\circ}09'38''E$  with the west line of the southeast quarter of Section 12 and the land of Ohio Power Co. as recorded in Deed Volume 362, Page 460 a distance of 1676.34 feet to an iron pin set; thence leaving said west line with the land of Theodore and Tammy Huhn as recorded in Deed Volume 1136, Page 439 the following two courses:

[1]  $S88^{\circ}05'42''E$  a distance of 1008.21 feet to an iron pin set;  
[2]  $S00^{\circ}55'05''W$  a distance of 218.49 feet to an iron pin found;  
thence with the land of John H. Dively, Sr. as recorded in Deed Volume 936, Page 338 the following two courses:

[1]  $S05^{\circ}59'02''E$  a distance of 1472.04 feet to an iron pin found;  
[2]  $S06^{\circ}52'00''E$  a distance of 677.77 feet to an iron pin found;  
thence  $S02^{\circ}13'35''W$  with the Second Tract, First Parcel of land of Marilyn L. Moore as recorded in Deed Volume 1141, Page 931 a distance of 1736.66 feet to an iron pin set ( passing on line an iron pin set at a distance of 687.97 feet ); thence with a new division line through the Second Tract, Second Parcel of land of the said Marilyn L. Moore the following two courses:

[1]  $N87^{\circ}38'37''W$  a distance of 202.96 feet to an iron pin set;

[2] S23°22'26"W a distance of 289.24 feet to a point on the south line of the northeast quarter of Section 13 ( passing on line an iron pin set at a distance of 240.25 feet ); thence N87°38'37"W with said south line a distance of 1021.29 feet to the point of beginning ( passing on line an iron pin set at a distance of 27.17 feet ), containing **116.206 acres.**

Subject to all leases, easements, rights of way, and restrictions of public records, if any.  
Subject to the right of way of County Road 203.

A survey of this description was made March 20, 1998 by Charles W. Hunnell, Registered Land Surveyor #6889. All iron pins set are 5/8" X 30" rebar with orange plastic caps labeled HUNNELL 6889. Reference bearing of N02°13'35"E on the west line of the northeast quarter of Section 13 is assumed for angle calculations.

Prior Deed Reference: Deed Volume 1141, Page 931

First Tract: A.P. #53-53-30-12-10-000 ( 42.462 ac. )

A.P. #53-53-60-13-06-000 ( 33.120 ac. )

Second Tract, Second Parcel: A.P. #53-53-60-13-05-000 ( 40.624 ac. )(PART)

DESCRIPTION APPROVED  
FOR AUDITOR'S TRANSFER  
BY *Charles W. Hunnell*  
3-25-98

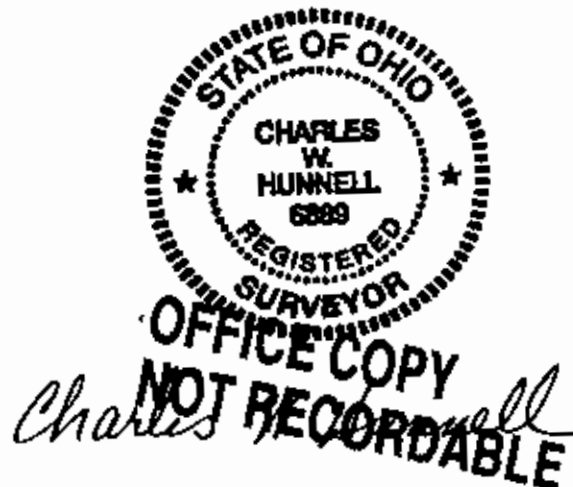

S88°05'42"E 1008.21

THEODORE & TAMMY HUHN  
1136 / 439

### PLAT OF SURVEY FOR MARILYN L. MOORE

SITuated IN THE FIRST TWP, MUSKINGUM CO.,  
AND STATE OF OHIO, AND BEING A PART THE  
SUM OF SECTION 12 AND PART OF THE NE 1/4 OF  
SECTION 13, TWP. 13, RANGE 11W OF THE  
"CONGRESS LANDS EAST OF THE SCIOTO RIVER"

SCALE: 1" = 200'



#### LEGEND:

- ⊙ 1" IRON PIN FOUND
- IRON PIN FOUND CAPPED BIEDENBACH 5718
- ⌒ IRON PIN SET CAPPED HUNNELL 6889
- △ SURVEY ANGLE POINT

BASIS OF BEARINGS:  
REFERENCE BEARING OF N02°13'35"E  
ON THE WEST LINE OF THE NE 1/4 OF  
SECTION 13 IS ASSUMED FOR  
ANGLE CALCULATIONS.

OHIO POWER CO  
302 / 440

12  
12  
13  
13  
ARTHUR W. HUHN  
982 / 523

QUARTERSECTION LINE

JOHN L. DIVELY, SR.  
936 / 338

QUARTERSECTION LINE  
1222.71 TOTAL  
N02°13'38"E

**PARCEL 1**  
116.206 AC.  
D.V. 1141, PG. 931  
FIRST TRACT:  
A.P. #53-53-30-10-000 ( 42.462 AC. ) (ALL)  
A.P. #53-53-60-13-06-000 ( 33.120 AC. ) (ALL)  
SECOND TRACT, SECOND PARCEL:  
A.P. #53-53-60-13-05-000 ( 40.624 AC. ) (PART)

PERTINENT DOCUMENTS  
ALL DEEDS SHOWN  
COUNTY TAX MAPS  
U.S.G.S. TOPO MAP (NEW CONCORD)  
SURVEYS BY W.J. BIEDENBACH 5718

MARILYN L. MOORE  
1141 / 931  
SECOND TRACT, FIRST PARCEL  
62.25 AC.

SANDRA L. & ARTHUR L. HERRON  
992 / 221  
992 / 226

*Handwritten signature and date*  
3-25-98

THIS SURVEY BY:  
CHARLES W. HUNNELL, R.L.S. #6889  
350 MAPLE AVE.  
SENECAVILLE, OH 43780  
(740) 685-5049  
MAR. 20, 1998

**PARCEL 2**  
1.581 AC.  
D.V. 1141, PG. 931  
A.P. #53-53-60-13-05-000 ( 0.581 AC. ) (PART)  
A.P. #53-53-60-13-04-000 ( 1.000 AC. ) (ALL)

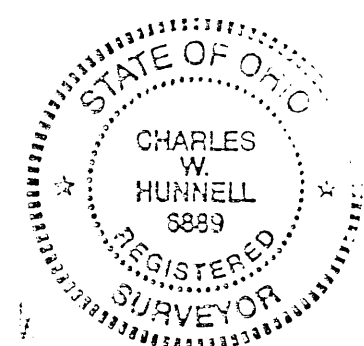

**PARCEL 3**  
0.310 AC.  
D.V. 1141, PG. 931  
SECOND TRACT, FIRST PARCEL:  
A.P. #53-53-60-13-03-000 ( 0.310 AC. ) (PART)

*Charles W. Hunnell*

N02°13'38"E 542.75  
N72°23'30"E 527.51 TOTAL  
N87°38'37"W 1021.29 TOTAL

N87°38'37"W 202.96  
N87°38'37"E 50.00  
N02°13'35"E 270.00  
N87°38'37"W 307.31  
N87°38'37"W 50.00  
S23°22'26"W 289.24 TOTAL  
N02°13'35"E 270.00  
N87°38'37"W 202.96  
N87°38'37"E 50.00