



www.mcpeeklandsurveying.com LLC
email: brian@mcpeeklandsurveying.com
340 Robin Hood Ln., * Zanesville, Oh 43701 * 740.704.6073

**Stephen D. White, Et al
OR 2402-196
+/-2.500 Ac.**

Situated in the State of Ohio, County of Muskingum, Township of Rich Hill, part of the NW Qtr. of Section 18, Township 13, Range 11 and being part of the lands now owned by Stephen D. White & Jennie M. White as recorded in OR 2402-209 of the Muskingum County Recorders Office more particularly described as follows.

Beginning for reference at the northeast corner of the northwest corner of said Section 18, thence with the north line of said Section 18, N 87°38'12" W, 525.83 feet to an iron pin found; thence with the common line of the lands now owned by Stephen D. White & Jennie M. White's (DR 1028-32) lands and Stephen D. White & Jennie M. White (OR 2402-209) lands, S 11°44'10" W, 356.99 feet to an iron pin found;

thence continuing with said common line, S 31°35'05" W, 306.27 feet to an iron pin found and the and the principal place of beginning;

thence leaving said common line and going through said Stephen D. White & Jennie M. White (OR 2402-209), S 86°32'43" E, 308.41 feet to an iron pin found on the west line of the lands now owned by Jonathan D. Sloan & Holly A. Sloan (OR 2402-204);

thence with said White/Sloan's common line S 27°05'18" W, 362.50 feet to an iron pin found;

thence leaving said common line and going N 87°38'50" W, 344.24 feet to an iron pin found;

thence with the common line of said White/White's lands, N 31°35'05" E, 384.09 feet to the place of beginning, containing a total of 2.500 acres more or less, subject to all legal highways and easements of record.

Attached to the above described parcel is an easement for the purpose of ingress/egress as described and recorded in OR 2402-196.

All bearings described herein are based on the Ohio State Plane Grid Coordinates, NAD83, Ohio South per GPS Observation.

All iron pins set are 5/8" rebar, 30" long with identification caps stamped "McPeek PS 8517".

The above described 2.500 acre parcel is based on a field survey made by McPeek Land Surveying on September 6th, 2016.

OFFICE COPY
NOT RECORDABLE
Brian Kelly McPeek, PS 8517

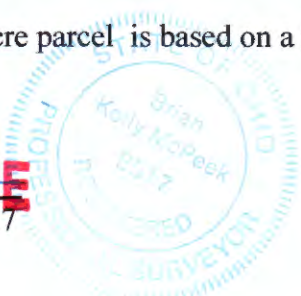

10/12/16
Date

Parcel No.
Part of :53-40-18-03-000 (+/- 2.500Ac.)

DESCRIPTION APPROVED
by: [Signature] 11/7/16

APPROVED
MUSKINGUM COUNTY
PLANNING COMMISSION DIRECTOR
[Signature]
Date 11/2/16 Fee Paid -

SITUATED IN

The State of Ohio, County of Muskingum, Township of Rich Hill,
part of the NW Qtr., Sec. 18, T13, R11.

DESCRIPTION
APPROVED

By: *[Signature]* 10/13/2016

BASIS OF BEARING

Bearings are based on State Plane Grid Coordinates,
NAD83, Ohio South, per GPS Observation.

John C. Frick & Charlotte F. Frick
DR 527-1048

Stephen D. White &
Jennie M. White
DR 1028-32
±0.808 Ac.

53-40-18-03-001
Stephen D. White &
Jennie M. White
DR 1028-32

53-40-18-03-000
Stephen D. White &
Jennie M. White
OR 2402-209

part of:
53-40-18-03-000
Stephen D. White &
Jennie M. White
OR 2402-196
±2.500 Ac.

Hallie E. Lighthizer &
Greg M. Connell
OR 2383-158

Jonathan D. Sloan & Holly A. Sloan
OR 2402-204

Jonathan D. Sloan & Holly A. Sloan
OR 2402-196

Approved for Transfer
No On-Lot Sewage
Zanesville-Muskingum Co.
Health Department

APPROVED
MUSKINGUM COUNTY
PLANNING COMMISSION DIRECTOR

PARCEL NO.

Part of: 53-40-18-03-001(±0.808 Ac.)
Part of: 53-40-18-03-000(±2.500 Ac.)

LEGEND

- Iron Pin Found
- Z- Property Hook
- Iron Pin Set

ADJOINER STATEMENT

Not to be used as a separate building
site or transferred as an independent
parcel in the future without planning
commission approval in accordance with
applicable subdivision regulations.



**OFFICE COPY
NOT RECORDABLE** 10/12/16
Date
Brian Kelly McPeck
Reg. Surveyor No. 8517

GRAPHIC SCALE



(IN FEET)
1 inch = 150 ft.



www.mcpeeklandsurveying.com
email: brian@mcpeeklandsurveying.com
340 Robin Hood Ln., * Zanesville, Oh 43701 * 740.704.6073