

56-80-18-09-004  
56-80-23-04-001

# W. J. Biedenbach & Associates

3120 Lisa Lane  
Zanesville, OH 43701

Surveying and Mapping

Telephone (740) 453-4850  
Fax (740) 450-1000

LEE GUNNELS  
AUDITORS PARCEL NUMBER 56-56-80-18-09-000 (PART)  
AUDITORS PARCEL NUMBER 56-56-80-23-04-001 (PART)

BEING A PART OF TRACTS CONVEYED TO LEE GUNNELS BY DEED RECORDED IN VOLUME 1137, PAGE 104 OF THE MUSKINGUM COUNTY DEED RECORDS; SITUATED IN THE SOUTHWEST QUARTER OF SECTION 18 AND THE NORTHWEST QUARTER OF SECTION 23, TOWNSHIP 2, RANGE 6, OF THE UNITED STATES MILITARY LANDS, SALEM TOWNSHIP, MUSKINGUM COUNTY, OHIO AND BEING FURTHER DESCRIBED AS FOLLOWS:

**BEGINNING** AT AN EXISTING STONE AT THE SOUTHEAST CORNER OF THE SOUTHWEST QUARTER OF SECTION 18;

**THENCE** SOUTH 03 DEGREES 31 MINUTES 41 SECONDS EAST ALONG THE EAST LINE OF THE NORTHWEST QUARTER OF SECTION 23, 31.67 FEET TO A POINT IN COUNTY ROAD 64 (NORFIELD ROAD);

**THENCE** WITH THE CENTER OF SAID ROAD THE NEXT TWO COURSES AND DISTANCES:

- 1) SOUTH 59 DEGREES 21 MINUTES 35 SECONDS WEST 260.65 FEET TO A POINT;
- 2) SOUTH 53 DEGREES 33 MINUTES 36 SECONDS WEST 182.57 FEET TO A POINT AT THE INTERSECTION OF THE CENTERLINE OF TOWNSHIP ROAD 82 (KNIPE ROAD);

**THENCE** WITH THE CENTER OF SAID KNIPE ROAD THE NEXT TWO COURSES AND DISTANCES:

- 1) NORTH 39 DEGREES 40 MINUTES 39 SECONDS WEST 245.50 FEET TO A POINT IN THE CENTER OF SAID ROAD;
- 2) NORTH 45 DEGREES 55 MINUTES 02 SECONDS WEST 50.56 FEET TO A POINT IN THE CENTER OF SAID ROAD;

**THENCE** LEAVING THE SAID KNIPE ROAD AND TRAVERSING THROUGH THE ABOVE SAID GUNNELS TRACT (VOLUME 1137, PAGE 104), NORTH 24 DEGREES 58 MINUTES 55 SECONDS EAST 711.67 FEET TO AN IRON PIN SET, PASSING AN EXISTING IRON PIN (5/8 INCH REBAR) AT 19.47 FEET AND AN IRON PIN SET AT 309.61 FEET;

**THENCE** WITH THE SOUTH LINE OF A TRACT CONVEYED TO JOHN TRESCOTT (VOLUME 1051, PAGE 631), NORTH 88 DEGREES 04 MINUTES 47 SECONDS EAST 224.58 FEET TO A POINT ON THE EAST LINE OF THE SOUTHWEST QUARTER OF SECTION 18, SAID POINT BEING SOUTH 88 DEGREES 04 MINUTES 47 SECONDS WEST 0.44 FEET FROM AN EXISTING IRON PIN (5/8 INCH REBAR);

**THENCE** WITH THE SAID EAST LINE OF THE SOUTHWEST QUARTER, SOUTH 03 DEGREES 31 MINUTES 41 SECONDS EAST 604.99 FEET TO THE PLACE OF BEGINNING.

**CONTAINING** 7.178 MORE OR LESS ACRES TOTAL WITH 5.445 MORE OR LESS ACRES IN SECTION 18 AND 1.733 MORE OR LESS ACRES IN SECTION 23. SUBJECT TO ALL LEGAL ROAD RIGHT-OF-WAYS OF TOWNSHIP 82 AND COUNTY ROAD 64 AND ALL OTHER APPLICABLE EASEMENTS.

ALL IRON PINS SET ARE 5/8 INCH X 30 INCH REBAR WITH PLASTIC IDENTIFICATION CAPS (BIEDENBACH PS5718-PS6923).

THE BEARINGS ARE BASED ON THE PREVIOUS SURVEY OF TRACTS CONVEYED TO LEE GUNNELS (VOLUME 1137, PAGE 104)

I HEREBY CERTIFY TO THE BEST OF MY KNOWLEDGE AND BELIEF THE SURVEY AND DESCRIPTION TO BE CORRECT AS PREPARED BY ME, THIS 11<sup>TH</sup> DAY OF NOVEMBER 1999.

**OFFICE COPY  
NOT RECORDABLE**  
REGISTERED SURVEYOR 5718

DESCRIPTION AS PROVIDED  
FOR AUDITOR'S PARCEL  
BY *[Signature]*  
11-16-99

# SURVEY FOR LEE GUNNELS

## AUDITORS PARCEL NUMBERS

56-56-80-18-09-000 (PART) - 5.445 ± ACRES

56-56-80-23-04-001 (PART) - 1.733 ± ACRES

BEING A PART OF TRACTS CONVEYED TO LEE GUNNELS BY DEED RECORDED IN VOLUME 1137, PAGE 104 OF THE MUSKINGUM COUNTY DEED RECORDS, SITUATED IN THE SOUTHWEST QUARTER OF SECTION 18 AND THE NORTHWEST QUARTER OF SECTION 23, TOWNSHIP 2, RANGE 6, OF THE UNITED STATES MILITARY LANDS, SALEM TOWNSHIP, MUSKINGUM COUNTY, OHIO.

THE BEARINGS ARE BASED ON THE PREVIOUS SURVEY OF TRACTS CONVEYED TO LEE GUNNELS (VOLUME 1137, PAGE 104).

J. TRESOTT  
VOL. 1051, PG. 631

SEE DETAIL.

N.88°04'47"E. 224.58'

SCALE 1"=100'  
0 50 100 200

## LEGEND

- EXISTING IRON PIN
- ⊙ IRON PIN SET  
(5/8" REBAR W/CAP)
- ANGLE POINTS
- EXISTING STONE

### RESEARCH:

PREVIOUS SURVEY BY W.J. BIEDENBACH (PS#5718)  
PREVIOUS SURVEY BY T.H. LINN (PS#7113)  
PREVIOUS SURVEY BY J.A. MALOTT (PS#5963)  
PREVIOUS SURVEY BY R.M. GRAVES (PS#5792)  
OTSEGO U.S.G.S.  
MUSKINGUM CO. TAX MAP

IRON PIN DETAIL  
NOT TO SCALE

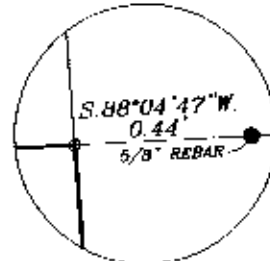

LEE GUNNELS  
VOL. 1137, PG. 104  
7.178 ± ACRES (TOTAL)

DESCRIPTION ATTACHED  
FOR AUDITORS USE ONLY  
BY *[Signature]*  
11-16-99

5.445 ± ACRES

SOUTHEAST CORNER OF THE  
SOUTHWEST QUARTER  
OF SECTION 18

SECTION 18  
SECTION 23

1.733 ± ACRES

E COUNTY ROAD 64  
(NORFIELD ROAD)

J. & D. HOHN  
VOL. 775, PG. 146

AREA OF SURVEY  
ENCROACHMENT

E TOWNSHIP ROAD 82  
(KNIFE ROAD)

D. MOORE  
VOL. 1017, PG. 239

D. COLLINS  
VOL. 558, PG. 359

P.O.B.

31.67'

S.03°31'41"E. 636.66'  
604.99'

W.J. BIEDENBACH & ASSOC.  
SURVEYING & MAPPING  
ZANESVILLE, OHIO  
(740) 453-4850

I HEREBY CERTIFY TO THE BEST OF MY KNOWLEDGE AND BELIEF THAT THE ABOVE PLAT AND SURVEY TO BE CORRECTLY PREPARED BY ME, THIS 11th DAY OF NOVEMBER, 1999.

OFFICE COPY  
NOT RECORDABLE

W.J. BIEDENBACH  
REGISTERED SURVEYOR #5718

DRAWN BY:  
AJS

DATE:  
11-11-99

SCALE:  
1"=100'

CHECKED BY:  
WJB

JOB NO:  
4502

DRAWING NO:  
D:\4502\4502