

DESCRIPTION FOR ROBERT AND DONNA McJESSY

TRACT 1

66-10-08-10-001

11360 NORWICH DR

Situated in the Township of Union, County of Muskingum, and State of Ohio, and being a parcel of land in the northwest quarter of Section 8, Township 1, Range 5 of the United States Military District and being more particularly described as follows:

Commencing at the northeast corner of the northwest quarter of Section 8, thence $S00^{\circ}18'56''W$ with the east line of said northwest quarter a distance of 1193.51 feet to a point; thence $S54^{\circ}51'11''W$ a distance of 501.61 feet to an iron pin found, the BEGINNING; thence continuing $S54^{\circ}51'11''W$ with the north right of way line of U.S. Route 40 a distance of 267.66 feet to an iron pin found; thence $N03^{\circ}25'10''W$ along a new division line through the land of Robert and Donna McJessey a distance of 332.78 feet to an iron pin set; thence $S84^{\circ}25'22''E$ with the land of Donald Skinner as recorded in Deed Volume 1029, Page 257 a distance of 200.90 feet to an iron pin found; thence $S13^{\circ}44'04''E$ with the land of said Donald Skinner a distance of 163.24 feet to the point of beginning, containing 1.225 acres.

ALSO the use of a roadway for ingress and egress which is more particularly described as follows:

Commencing at an iron pin set at the northwest corner of the 1.225 acre parcel previously described, thence $S03^{\circ}25'10''W$ a distance of 60.00 feet to a point, the BEGINNING; thence continuing $S03^{\circ}25'10''W$ a distance of 20.86 feet to a point; thence $N76^{\circ}19'55''W$ a distance of 122.05 feet to an iron pin set; thence $N11^{\circ}42'42''W$ a distance of 63.79 feet to an iron pin found; thence $N27^{\circ}12'17''E$ a distance of 202.73 feet to a PK nail set in the center of Township Road 692; thence $S83^{\circ}03'30''E$ a distance of 32.01 feet to a PK nail set in the center of said road; thence $S27^{\circ}12'17''W$ a distance of 200.00 feet to an iron pin found (passing on line an iron pin found at 30.18 feet); thence $S18^{\circ}12'35''W$ a distance of 24.14 feet to a point; thence $S11^{\circ}42'42''E$ a distance of 22.27 feet to a point; thence $S76^{\circ}19'55''E$ a distance of 103.25 feet to the point of beginning.

This description is part of the land of Robert and Donna McJessey as recorded in Deed Volume 1065, Page 342 being also a part of Auditor's Parcel #66-10-08-10. Subject to all leases, easements, rights of way, and restrictions of public record, if any.

A survey of this description was made September 26, 1995 by Charles W. Hunnell, R.L.S. #6889. All iron pins set are 5/8" x 30" rebar with orange plastic caps labeled HUNNELL 6889. Reference bearing of $S00^{\circ}18'56''W$ on the east line of the northwest quarter of Section 8 is assumed for angle calculations.

TRACT 2

66-10-08-10-001

Situated in the Township of Union, County of Muskingum, and State of Ohio, and being a parcel of land in the northwest quarter of Section 8, Township 1, Range 5 of the United States Military District and being more particularly described as follows:

Commencing at the northeast corner of the northwest quarter of Section 8, thence $S00^{\circ}18'56''W$ along the east line of said northwest quarter a distance of 1193.51 feet to a point; thence $S54^{\circ}51'11''W$ a distance of 769.27 feet to an iron pin found (passing on

PLAT OF SURVEY FOR ROBERT AND DONNA McJESSY

SCALE: 1" = 100'

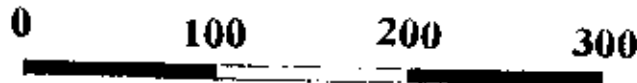

LOCATION:
NW 1/4 OF SEC. 8, T-1N, R-5W
U.S. MILITARY DISTRICT
UNION TWP, MUSKINGUM CO.

LEGEND:
□ STONE FOUND
○ IRON PIN FOUND
● IRON PIN SET
▲ PK NAIL SET

PRIOR DEED REF:
DEED VOL. 1065, PG. 342

BEARINGS & DISTANCES FOR ROADWAY PURPOSES

A	S03°25'10"E	68.00
B	S03°25'10"E	20.86
C	N76°19'55"W	122.05
D	N11°42'42"W	63.79
E	N27°12'17"E	202.73
F	S83°03'30"E	32.01
G	S27°12'17"W	30.18
H	S27°12'17"W	169.82
I	S18°12'35"W	24.14
J	S11°42'42"E	22.27
K	S76°19'55"E	103.25

NE COR OF NW
SECTION 8

DESCRIPTION APPROVED
FOR AUDITORS TRANSFER

BY ALLB
9-29-95

TWP. RD. 692

DONALD SKINNER
1029 / 257

TRACT 1
1.225 ACRES

TRACT 2
1.840 ACRES

U.S. ROUTE 40

SURVEY BY:
CHARLES W. HUNNELL, R.L.S. #6889
350 MAPLE AVE.
SENECAVILLE, OH 43780
1-614-685-5049
SEPT. 25, 1995

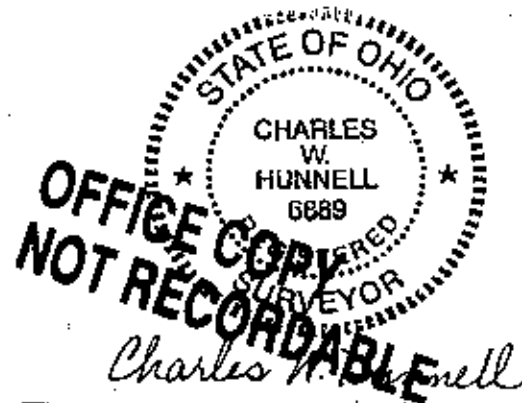

EVERT & DOROTHY POWELSON
762 / 308