

Situated in the State of Ohio, Muskingum County, Union Township, Township 1 North, Range 5 West, Being part of the southeast quarter of Section 7, United States Military Survey, Being a tract of land described in Deed volume 1129 page 695 to Russell D. Stines and Connie L. Stines., and being more particularly described as follows:

Commencing for reference at an iron pin found (5/8") at the southwesterly corner of lot 15B of the Country Retreat subdivision re-plat as found in Muskingum County plat book 16 page 32, said point also being on the easterly line of Belle Drive and the southerly line of East Belle Drive, said point being referenced by an iron pin found (5/8") bearing N17°30'36"E 44.00 feet; Thence continuing along the westerly line of said lot 15B and the easterly line of Belle Drive S24°46'00"E 4.00 feet to a point on the northerly right of way line of State Route 40; Thence leaving said lot 15B and across said State right of way S31°36'24"E 133.41 feet to a point in the centerline of State Route 40, said point being the **True Point of Beginning** for the tract herein described;

Thence leaving said centerline S07°26'24"E 126.35 feet to a 3/4" iron pipe found, said point also being on the southerly right of way line of State Route 40;

Thence leaving said right of way line S07°26'24"E 244.73 feet to a 3/4" iron pipe found, said point being on the northerly right of way line of the B & O railroad;

Thence along said northerly right of way line S73°43'42"W 140.75 feet to a 3/4" iron pipe found, said point also being the southeasterly corner of a tract of land described in Deed Volume 520 page 185 to Richard A. Tom and Effie Tom;

Thence leaving said northerly line of the B & O railroad and along the easterly line of said Tom tract N21°32'44"W 233.10 feet to an iron pin set, said point also being on the southerly right of way line of State Route 40;

Thence continuing along said easterly line and across said State right of way, N21°32'44"W 108.50 feet to a point in the centerline of said State Route 40;

Thence leaving said Tom tract and along said centerline with a curve to the left having a radius of 7161.97 feet, an arc length of 230.66 feet, a chord bearing of N67°07'31"E and a chord length of 230.65 feet to the **Place of Beginning**.

The above described area contains 1.493 acres and is known as Auditor's Parcel No. 66-17-02-01-000

Prior Deed reference Deed Volume 1129 page 695

Bearings are based on the southwesterly line of lot 15B of the Country Retreat subdivision as re-platted in Muskingum County Plat book 16 page 32, being S24°46'00"E.

This description was based on a survey performed by Robert A. Lowe on July 4, 2012.

All iron pins set are 5/8" x 30" with an attached plastic identification cap stamped Robert A. Lowe P.S. 8415.

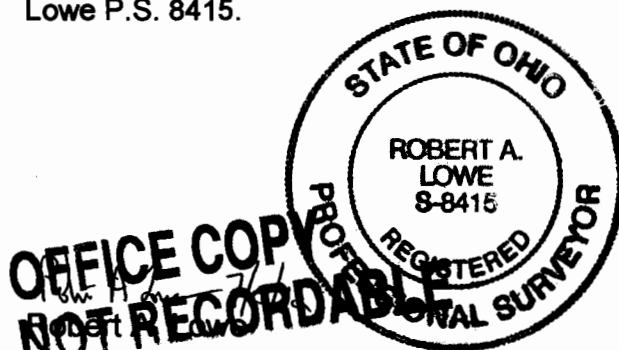

Ohio Professional Surveyor S-8415

DESCRIPTION
APPROVED
By: [Signature] 7/10/2012