

Baseline Surveying, Inc.
Land Surveying and Construction Layout

3010 East Pike
Zanesville, OH 43701

Email: bei@rrohio.com
Telephone (740) 453-4850

CONTAINING 5.349 ACRES, SUBJECT TO LEGAL ROAD RIGHT OF WAYS OF MCKINLEY DRIVE (TOWNSHIP ROAD 656) AND ALL OTHER APPLICABLE EASEMENTS.

ALL IRON PINS SET ARE 5/8 INCH X 30 INCH REBAR WITH PLASTIC IDENTIFICATION CAPS (BASELINE PS6923-PS8536).

BEARINGS ARE BASED ON OHIO STATE PLANE COORDINATE SYSTEM 1983 (2011), OHIO SOUTH ZONE, GRID, DERIVED FROM A GPS OBSERVATION.

I, JASON LEACHMAN, PS 8536, HEREBY CERTIFY TO THE BEST OF MY KNOWLEDGE AND BELIEF THE SURVEY AND DESCRIPTION TO BE CORRECT AS PREPARED BY ME, THIS 19TH DAY OF OCTOBER 2020, FROM A FIELD SURVEY COMPLETED BY ME ON THE 13TH DAY OF OCTOBER 2020.

**OFFICE COPY
NOT RECORDABLE**

JASON LEACHMAN
PROFESSIONAL SURVEYOR 8536

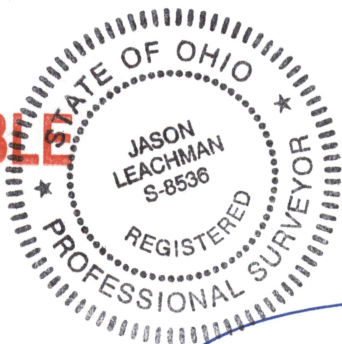

DESCRIPTION
APPROVED

By: *[Signature]*



11/2/2020
Date

Fee Paid