

66-25-02-67-001 A

Situated in the State of Ohio, County of Muskingum, Village of New Concord, and being a part of the Northwest Quarter of Section 1, Union Township, Township 1, Range 5, United States Military Lands; and being part of lands currently owned by Muskingum University (formerly Muskingum College) (DR 166-75), and being more particularly described as follows:

Beginning for reference at an iron pin found on the northwest corner of Lot 4 of E. Morrison Giffen's 1st Addition to New Concord as the same is designated on Muskingum County Plat Book 5, Page 61, from which an iron pin found on the northwest corner of Lot 3 of said 1st Addition bears North 02 degrees 45 minutes 46 seconds West a distance of 66.60 feet and an iron pin found on the northwest corner of Lot 8 of said 1st Addition bears South 02 degrees 50 minutes 33 seconds East a distance of 287.95 feet;

thence crossing Lakeside Drive, North 66 degrees 24 minutes 03 seconds West 32.50 feet to an iron pin found and the principal place of beginning of this Access Easement;

thence through the lands of said Muskingum University the following five courses:

- 1) South 86 degrees 54 minutes 21 seconds West 116.90 feet to an iron pin found;
- 2) South 86 degrees 54 minutes 21 seconds West 105.62 feet to a point;
- 3) North 03 degrees 05 minutes 39 seconds West 30.00 feet to a point;
- 4) North 86 degrees 54 minutes 21 seconds East 223.11 feet to a point;
- 5) South 01 degrees 59 minutes 03 seconds East 30.01 feet to the principal place of beginning.

Bearings are based on the Ohio State Plane Coordinate System, South Zone, North American Datum 1983, as per GPS observations made December 6, 2019.

OFFICE COPY
NOT RECORDABLE

Timothy H. Linn, PS
Reg. No. 7113

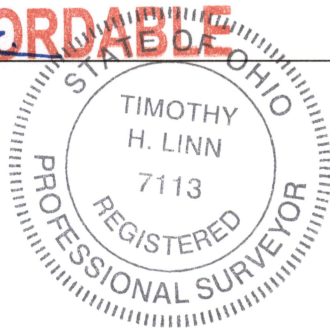

1/27/20
Date

DESCRIPTION
APPROVED

By: [Signature]