

73-36-01-12-002



www.mcpeeklandsurveying.com  
email: brian@mcpeeklandsurveying.com  
340 Robin Hood Ln., \* Zanesville, Oh 43701 \* 740.704.6073

**Christopher Paul Zemba & Kathleen Zemba**  
**OR 1628-644**  
**+/-2.829 Acre**

Situated in the State of Ohio, County of Muskingum, Township of Wayne, being part of the Southeast Quarter of Section 14, Township 12, Range 13, being part of the lands now owned by Christopher Paul Zemba & Kathleen Zemba recorded in OR 1628-644 of the Muskingum County Records Office and more particularly described as follows.

Beginning for reference at an iron pin found at the northeast corner of the southeast quarter of Section 14, thence with the mid-section line, N 87°40'42" W a distance of 1329.11 feet to an iron pin found;

thence continuing with said mid-section line, N 86°57'38" W a distance of 117.07 feet to an iron pin set and the principal place of beginning;

thence going through said Zemba's lands, S 03°02'22" W a distance of 313.60 feet to a point in the center of Ellerman Drive (T-449), passing an iron pin set at 292.49 feet;

thence with the center of said Ellerman Drive the following four (4) courses:

1. N 79°39'07" W a distance of 180.66 feet to a point;
2. N 76°01'18" W a distance of 58.53 feet to a point;
3. N 66°09'12" W a distance of 78.27 feet to a point;
4. N 54°36'20" W a distance of 199.03 feet to a point on the east line of the lands now owned by Jeffrey A. Bryan & Glenda J. Bryan (OR 2183-204);

thence leaving the center of said Ellerman Drive and going with the east line of said Bryan's lands, N 03°32'05" E a distance of 145.20 feet to an iron pin found on said mid-section line, being the south line of the lands now owned by James L. McFerren & Eileen B. McFerren (DR 1119-345), passing an iron pin found at 24.77 feet;

thence with said mid-section line, S 86°57'38" E a distance of 476.70 feet to the place of beginning, containing 2.829 acres more or less, subject to all legal highways and easements of record.

All bearings described herein are based on the Ohio State Plane Grid Coordinates, NAD83, Ohio South per GPS Observation.

All iron pins set are 5/8 inch by 30 inch steel rebar with plastic identification caps marked MCPEEK PS8517.

The above described 2.829 acre parcel is based on a field survey made by Brian K. McPeek, PS 8517 of McPeek Land Surveying, LLC on April 12<sup>th</sup>, 2019.

**Parcel No.**

**Part of: 73-36-01-12-000 (+/-2.829 Ac.)**

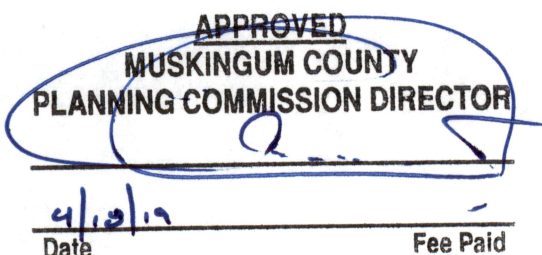
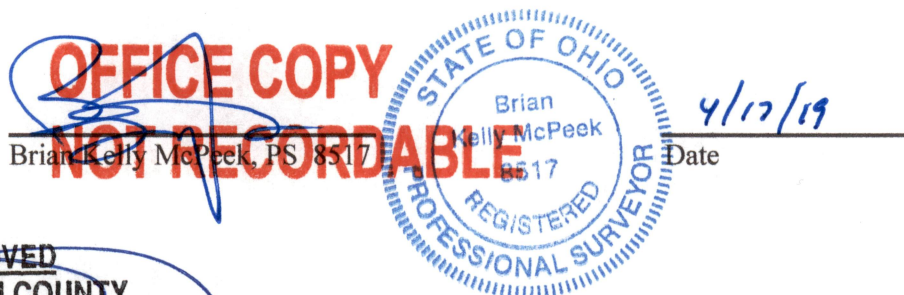

DESCRIPTION  
APPROVED  
By: 4/12/19

Date

Fee Paid