

DESCRIPTION OF SURVEY FOR THE HAYES FAMILY LIMITED PARTNERSHIP
JOB#2373

Situated in the State of Ohio, County of Muskingum, Township of Wayne:

Being part of the Northwest Quarter, Section 2, Township 11, Range 13, and part of the Southwest Quarter of Section 12, Township 12, Range 13, of the Congress Lands East of the Scioto River, further **being part of** The Hayes Family Limited Partnership property recorded in **Deed Book Volume 1130, Page 122** of said county's deed records, further **being all of** Muskingum County **Auditor's Parcel Numbers 73-09-01-03-000 and 73-42-02-16-000**, and more particularly described as follows;

Beginning at an iron pin (set) at the common corner for Sections 12 and 13 of said Township 12 and Range 12;

- #1- **THENCE North 02 degrees 46 minutes 15 seconds East 1569.14 feet** along the common line for Sections 12 and 13, being the common line for said Hayes property and for Brandon Sommers and Eryca Sommers property recorded in Official Record Volume 2679, Page 448, and for the Terence F Paul and Christine A Paul property recorded in Deed Book Volume 1105, Page 265, and for the Patrick A Burkhart and Karen L Burkhart property recorded in Deed Book Volume 1049, Page 397 to an iron pipe (found) at the Southwest corner of the Andrew C Bertke Trustee property recorded in Official Record Volume 2304, Page 190, passing an iron pin (found) at a corner for said Sommers and Paul properties at 256.77 feet, and iron pin (found) at a corner for said Paul and Burkhart properties at 1269.42 feet;
- #2- **THENCE South 87 degrees 12 minutes 34 seconds East 1607.99 feet** into Section 12 and along the common line for said Hayes and Bertke properties also along the Gary E Taylor and Janelle E Taylor property recorded in Deed Book Volume 1103, Page 479 to an iron pin (set) at the Northwest corner of Lot 1 of Chuck's Subdivision recorded in Plat Book 11, Page 46;
- #3- **THENCE South 05 degrees 38 minutes 51 seconds West 228.56 feet** along the West line of said Lot 1 and subdivision to an iron pin (set);
- #4- **THENCE South 84 degrees 03 minutes 39 seconds East 200.00 feet** along the South lines of said subdivision and Lots 1 and 2 to an iron pipe (found) at the Southeast corner of said Lot 2;
- #5- **THENCE South 83 degrees 55 minutes 13 seconds East 50.09 feet** continuing along the South line of the Subdivision and crossing a platted access to an iron pipe (found) at the Southwest corner of Lot 3 of said Subdivision;
- #6- **THENCE South 83 degrees 59 minutes 25 seconds East 200.00 feet** continuing along the South line of said subdivision and Lots 3 and 4 of said subdivision to an iron pin (set) at the Southeast corner of said Lot 4, passing an iron pin (set) at a common corner for said Lots 3 and 4 at 100.00 feet;
- #7- **THENCE South 80 degrees 35 minutes 38 seconds East 648.81 feet** leaving said subdivision and along a common line for said Hayes property and for the Dennis M Baughman and Holli S Baughman property recorded in Official Record Volume 2597, Pages 525 and 528 to an unmarked point on the common line for the Southwest and Southeast Quarters of Section 12, from which an iron pin (found) for reference bears South 80 degrees 34 minutes 32 seconds East 1.41 feet;
- #8- **THENCE South 03 degrees 06 minutes 18 seconds West 1249.18 feet** along said Quarter Section Line, and common line for said Hayes property and for the Robert L Schilling and Thasia L Schilling property recorded in Official Record Volume 2650, Page 347, and for the April Foster and Kyle Foster property recorded in Official Record Volume 2581, Page 711, to an iron pin (found) on the common line for said Townships 11 and 12, passing an iron pin (found) at 714.79 feet being a common corner for said Schilling and Foster properties;
- #9- **THENCE North 86 degrees 29 minutes 42 seconds West 601.30 feet** along said Township line, further being the common line for Sections 2 and 12 and for said Hayes property and the Joseph P Stoneburner and Barbara J Stoneburner property recorded in Deed Book Volume 1081, Page 63 to an iron pipe (found) at the common corner for the Northeast and Northwest Quarters of said Section 2;

DESCRIPTION OF SURVEY FOR THE HAYES FAMILY LIMITED PARTNERSHIP
JOB#2376

- #10- **THENCE South 03 degrees 02 minutes 13 seconds West 1893.24 feet** along the common line for said Northeast and Northwest Quarters of Section 2 and continuing along said properties to an unmarked point in the old centerline of Dietz Lane, passing an iron pipe at 1834.82 feet and the current centerline of Dietz Lane at 1874.60 feet;
- #11- **THENCE North 67 degrees 56 minutes 04 seconds West 78.38 feet** along the old centerline of Dietz Lane and common line for said Hayes property and for the Donald E Mehling Jr. property recorded in Deed Book Volume 1070, Page 202 to an iron pin (found);
- #12- **THENCE North 54 degrees 31 minutes 01 seconds West 106.51 feet** continuing along said old centerline and properties to an iron pin (found);
- #13- **THENCE South 88 degrees 17 minutes 03 seconds West 144.75 feet** continuing along said old centerline and properties to an iron pin (found);
- #14- **THENCE North 71 degrees 28 minutes 27 seconds West 183.24 feet** continuing along said old centerline and properties to an iron pin (found);
- #15- **THENCE North 75 degrees 01 minutes 16 seconds West 214.33 feet** continuing along said old centerline and properties to an iron pin (found);
- #16- **THENCE North 79 degrees 00 minutes 16 seconds West 325.61 feet** continuing along said old centerline and properties to an unmarked point in the current centerline of Dietz Lane, passing the current centerline at 54.00 feet;
- #17- **THENCE along a curve to the right having, a chord bearing North 69 degrees 56 minutes 05 seconds West 152.71 feet, a radius of 739.00 feet, and arc length of 152.98 feet,** along said current centerline to an unmarked point;
- #18- **THENCE North 64 degrees 00 minutes 16 seconds West 133.70 feet** continuing along said current centerline to an unmarked point;
- #19- **THENCE along a curve to the left having, a chord bearing North 68 degrees 47 minutes 08 seconds West 94.02 feet, a radius of 564.00 feet, and arc length of 94.13 feet,** continuing along said current centerline and properties to the unmarked Southeast corner of said Sommers property;
- #20- **THENCE North 18 degrees 48 minutes 30 seconds East 509.55 feet** leaving said road and along the common line for said Hayes and Sommers properties to an iron pin (found), passing an iron pin (found) at 19.83 feet;
- #21- **THENCE North 87 degrees 11 minutes 30 seconds West 551.39 feet** continuing along said properties to an iron pin (found);
- #22- **THENCE North 03 degrees 47 minutes 51 seconds East 1062.80 feet** continuing along said properties to an iron pin (found) on the common line for said Townships 11 and 12;
- #23- **THENCE North 87 degrees 11 minutes 30 seconds West 307.59 feet** along said Township line, further being the common line for said Sections 2 and 12 and continuing along said properties to the place of beginning, containing 63.76 acres in Section 2 and 90.13 acres in Section 12 for a **total of 153.89 acres**, of which 1.55 acres are within the right of way of Dietz Lane.

The bearings within this description are based on State Plane Coordinate Grid (Ohio South 1983) derived from GPS Observations. Iron pins (set) are 5/8" rebar with identification caps (C.R.Harkness P.L.S.6885).

This description was written by Charles R. Harkness Professional Land Surveyor #6885 from an actual survey completed on February 9, 2017 in accordance with Chapter 4733-37 of the Administrative Code, and is intended to be used for the legal transfer of the property described and does not intend to describe any apparent easements nor easements of record, unless otherwise indicated.

**OFFICE COPY
NOT RECORDED**
Charles R. Harkness
Charles R. Harkness PLS #6885



**DESCRIPTION
APPROVED**
By: *[Signature]*

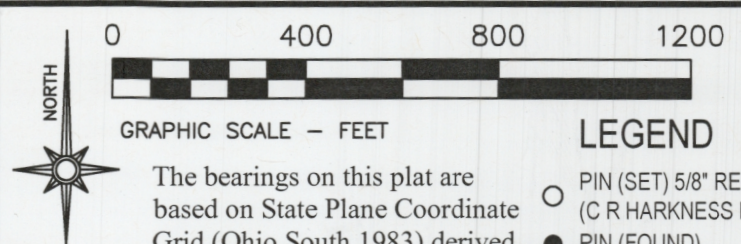

GRAPHIC SCALE - FEET

LEGEND

The bearings on this plat are based on State Plane Coordinate Grid (Ohio South 1983) derived from GPS observations.

- PIN (SET) 5/8" REBAR CAPPED (C R HARKNESS PLS #6885)
- PIN (FOUND)
- △ POINT (UNMARKED)
- STONE (FOUND)
- PIPE (FOUND)
- x-x-x- FENCE LINE

Situated in the State of Ohio, County of Muskingum, Township of Wayne:

Being part of the Northwest Quarter, Section 2, Township 11, Range 13, also part of the Southwest Quarter of Section 12, Township 12, Range 13, of the Congress Lands East of the Scioto River, further **being part of The Hayes Family Limited Partnership property recorded in Deed Book Volume 1130, Page 122** of said county's deed records, further **being all of Muskingum County Auditor's Parcel Number 73-09-01-03-000 and 73-42-02-16-000:**

SURVEYOR'S NOTES AND REFERENCES:

Muskingum County Tax Maps and OGRIP Orthophotos of the area. All other references are shown or listed.

Note #1- The right of way for Dietz Lane is listed as 40 feet and occupies 1.55 Acres of the surveyed parcel.

DESCRIPTION
APPROVED
By: *[Signature]*

This plat was prepared by C.R. Harkness Surveying & Mapping Inc. in accordance with Chapter 4733-37 of the Administrative Code, and is intended to be used for the legal transfer of the parcel surveyed and does not show any apparent easements nor easements of record, unless otherwise indicated.



OFFICE COPY
NOT RECORDED

SURVEY FOR:		HARKNESS SURVEYING & MAPPING, INC.	
The Hayes Family Limited Partnership		8205 OLD TOWN ROAD ROSEVILLE, OHIO 43777 PHONE/FAX (740) 849-0122	
SURVEYED: 2/9/17	DRAWN: 2/10/17	JOB NUMBER Job#2373	DRAWING / SHEET # Plat #01

