

National Gas and Oil property
0.656 Ac.
Part of Auditors Parcel No. 81-11-03-03-000.

Situated in the State of Ohio, County of Muskingum, City of Zanesville:

Being the south half of Lot 16 and all of Lot 15 of Buckingham Terrace Addition as Recorded in Plat Book 2, Page 47 and part of property in Deed Book 686, Page 22 owned by National Gas and Oil Corporation and Recorded in Deed Records of said Muskingum County Deed Records bounded and described as follows:

Commencing at a stone found at the southwest corner of Lot 18 in said Buckingham Terrace (P.B. 2, Pg. 47); thence S 88°31'54"E (the base of bearings for this description is true north from an observation of the sun) along the north line of Searle Street 150.80 feet to a point; thence S 00°04'39"W and crossing said street and along the east line of Lot 17 and 16 a distance of 275.92 feet to a nail in concrete around the corner post of a chain link fence at the true place of beginning for the following described property; thence S 00°04'39"W along the east line of Lot 16 and 15 and along the west line of property owned by Estella Keith (Vol. 658, Pg. 123) and property owned by Joseph Norris (Vol. 1093, Pg. 155) a distance of 241.00 feet to an iron pin set at the southeast corner of said Lot 15; thence along the south line of said Lot 15 on a curve to the left having a radius of 95.32 feet and having a central angle of 82°48'55" (the chord of which bears N 72°25'50"W 126.09 feet) an arc distance of 137.77 feet to an iron pin set on the east line of Lake Drive; thence along the east line of said Lake Drive on a curve to the right having a radius of 333.17 feet and a central angle of 7°16'28" (the chord of which bears N 14°35'45"W 42.27 feet) an arc distance of 42.30 feet to an iron pin set; thence along the east line of said drive on a curve to the right having a radius of 1407.69 feet and a central angle of 6°37'20" (the chord of which bears N 7°38'51"W 162.61 feet) an arc distance of 162.70 feet to an iron pin set; thence N 89°40'33"E along the south line of property owned by Roy Hawkins (Vol. 1643, Pg. 622) 152.82 feet to the true place of beginning containing 0.656 of an acre.

Part of Auditors Parcel No. 81-11-03-03-000.

Subject to all legal right of ways and easements on record.

All iron pins set are 5/8"x 30" rebar capped Graves No. 5792.

This description was written December 30, 2004 from a field Survey made by Richard Max Graves Registered Surveyor No. 5792.

APPROVED FOR

CLOSURE

[Signature]
1-4-2005

**OFFICE COPY
NOT RECORDABLE**



N

11100

VOL. 686, Pg. 22
VOL. 512, Pg. 708
VOL. 352, Pg. 460
VOL. 129, Pg. 344
VOL. 130, Pg. 22
VOL. 129, Pg. 347
VOL. 795, Pg. 230
L.P. DANAH SURVEY
ON SOUTH

PB-MINICK #3858
SURVEY IN 1960 OF
NATIONAL GAS PROP.

BUCKINGHAM TERRACE
PLAT BOOK 2, PG. 47
TAX MAP 81-12 & 81-11

CLOSURE

all
1-9x005

EXEMPT FROM
PLANNING COMMISSION

atlb
1-7-2005

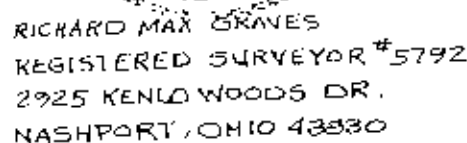

OFFICE COPY
NOT RECORDABLE

LOT 8

N.E. COR
L-27. B.

 $\rightarrow R'$.

SEARLE ST.

BUCKINGHAM

TERRACE

PLAT BOOK Z, Pg. 47

LOT 15

ROY HAWKINS

N. 29° 40' 33".

--- I ---
LOT 10
LOT 15

NATIONAL GAS
OIL CORP.
100-33

15

PT. 81-11-03-03-00

ARC 137.77
R 98

4-02-18 55 ✓
Ch. H. 72-55
(26-55)

199

10/10/1964

57.0

APR 20 1954

100-442012

1000

07 55 W
23 64

78

JEWETT COR. 50