

Situated in the State of Ohio, Muskingum County, City of Zanesville, Township 16,
Range 14, Bounded and Described as follows:

Being all of Michelle Wilson Volume 1035, page 363, Parcel No. 80-83-19-01-56-000.
Being part of lot 29 of Cliffwood Addition to Zanesville, Plat Book 1, page 198 & 199.

Commencing at a iron pin found at the Southwest corner of Lot 29 of Cliffwood Addition,
Plat Book 1, Page 198, & 199; Thence North $1^{\circ}49'36''$ East along East line Of Out Lot 15
30.20 feet to an iron pin set at The Place of Beginning; Thence Continuing North $1^{\circ}49'36''$
East 40.00 feet to an iron pin set, passing an iron pin found at 3.63 feet on south side of
a 16.00 foot Access alley; Thence South $88^{\circ}10'00''$ East 88.81 feet to an iron pin set on west
side of a Private Alley; Thence along west side of Private Alley South $2^{\circ}15'00''$ West 40.00
feet to an iron pin set; Thence leaving Private Alley North $88^{\circ}10'00''$ West 88.52 feet to the
Place of Beginning. Containing 0.08 Acres more or less.

Bearings are based on the South line of Prospect Ave. bearing South $88^{\circ}50'00''$ East.

Above description is based on a survey by R.L. Daniels, Registered Surveyor No. 5410
January 11, 2005 and is intended for legal transfer of property described and does not
intend to describe all or any easements of record nor encroachments unless otherwise
indicated.

Iron pins set are No. 5 Reinforced bars 30 inches long with plastic I.D. caps.

Reference Volume 1035, page 363.

EXEMPT FROM
PLANNING COMMISSION

RLD 1-19-2005

OFFICE COPY
NOT RECORDED
APPROVED FOR CLOSURE

RLD 1-19-2005

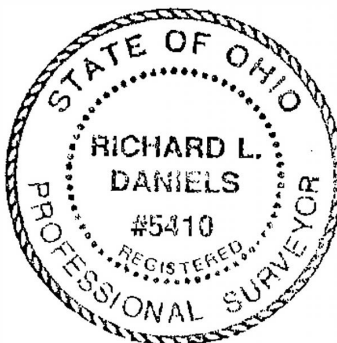

PROSPECT AVE. 49.5'

Basis of Bearings
S 88°50'00"E

1" = 40'

- IRON PIN SET
- IRON PIN FOUND

V. & M. Martin 764-329

E.M. NORRIS 770-60

C. TABLER 969-351

OAK STREET 66'

S88°10'00"E
88.81'

0.08 Ac.

N88°10'00"W
88.52'

S2°15'00"W
40.00'

PRIVATE ALLEY

EXEMPT FROM
PLANNING COMMISSION

APPROVED FOR CLOSURE

Line
1

Bearing
N1°49'36"E

Distance
30.20'

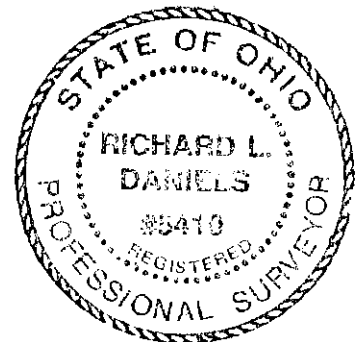

Michelle Wilson

All of Parcel No. 80-83-19-01-56-000
Deed Vol. 1035, Page 363
Part of Lot 29 of Cliffwood Addition to
Zanesville, Ohio, Page 198-199
State of Ohio, Muskingum County City of
Zanesville, Ohio, R 14

1-11-05

Reg. 5011400

OFFICE COPY
NOT RECORDABLE