

DESCRIPTION
APPROVED
By: *[Signature]* 6/17/14

LEGEND

- IPS Iron Pin Set, 5/8" rebar
- Iron Pin Found
- Pipe Found
- * PK Nail Set
- Z— Property Hook
- [P.O.B.] Point of Beginning
- 22 Parcel Number

SITUATED IN

City of Zanesville, County of Muskingum, State of Ohio. Being a part of Lots 11, 12, 13 and 14 of Thompson's Addition as the same is designated and delineated on Muskingum County Deed Book A-0, Page 176 and being a part of Lots 6, 7 and 8 of Daniel Convers East Addition as the same is designated and delineated on Muskingum County Deed Book A-0, Page 78; and being part of unplatted lands situated east of Miller and Klemm's Subdivision as the same is designated and delineated on Muskingum County Deed Book 3, Page 117, and north of said Convers East Addition and southwest of said Thompson's Addition.

PARCEL NO.

All of: 84-26-05-20-000 (0.08 ac.)
All of: 84-26-05-21-000 (0.08 ac.)
All of: 84-26-05-22-000 (0.45 ac.)
All of: 84-26-05-44-000 (0.08 ac.)
All of: 84-26-05-45-000 (0.07 ac.)
Private Driveway has no Parcel No. (0.01 ac.)
Total Acreage: ±0.77 Acres

REFERENCES

OR 1696-615
OR 2514-923
OR 2515-14
OR 2514-929
OR 2059-580
OR 1777-427
OR 2514-942
OR 2515-20
OR 1119-551
OR 2515-1
OR 2514-948
OR 2514-939
OR 2514-948
OR 2514-934
DB 3 PG 117

BASIS OF BEARING

Bearing are based on Ohio State Plane Coordinate System, South Zone from GPS observations made on October 26 and December 20, 2012.

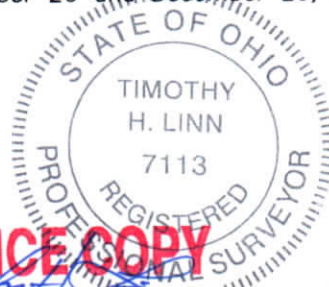

OFFICE COPY
NOT RECORDABLE

Timothy H. Linn, P.E.
Reg. No. 7113

6/17/14
Date

Project No.: DG-960

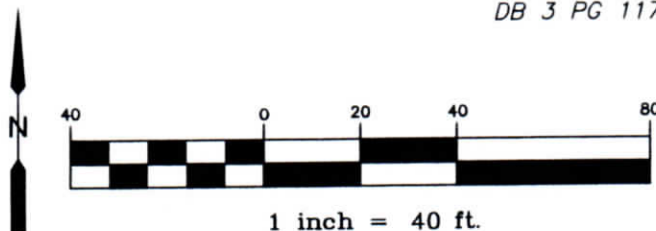

Linn Engineering, Inc.
Civil Engineering Consultants
P.O. Box 2086 Zanesville, Ohio 43702-2086

740-452-7434

