

EXHIBIT A

Page 2 of 2

RX 251 WDV

Rev. 05/09

South 59 degrees, 05 minutes, 40 seconds West, 46.32 feet to an iron pin set, said iron pin set being 45.00 foot right of centerline station 2+36.00;

North 88 degrees, 14 minutes, 41 seconds West, 76.00 feet to an iron pin set, said iron pin set being 45.00 foot right of centerline station 1+60.00; and . . .

North 29 degrees, 12 minutes, 30 seconds West, 29.15 feet to an iron pin set in the existing southerly right-of-way line of Military Road, said iron pin set being 20.00 foot right of centerline station 1+45.00;

Thence along said right-of-way line, **South 88 degrees, 14 minutes, 41 seconds East, 130.00 feet** to the **Point of Beginning** and containing **0.059 acres**, more or less, which is located in Muskingum County Auditor's Permanent Parcel Number 86-26-02-04-000, according to a survey made by Jobes Henderson & Associates, Inc., during October of 2012.

Grantor claims title by instrument(s) recorded in Deed Book 327, Page 627, Muskingum County Recorder's Office, Muskingum County, Ohio.

The bearings in the above description are based on State Plane Coordinates System, Ohio South Zone.

Subject to all valid and existing easements, restrictions, and conditions of record.

This description is based on a survey made under the direction and supervision of Jeremy L. Van Ostran, Registered Surveyor Number 8283.

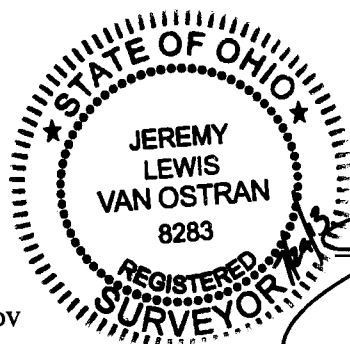

DESCRIPTION
APPROVED

By

[Signature] 8/21/2013

**OFFICE COPY
NOT RECORDEABLE**
Reg. Surveyor # 8283

July 29, 2013

T:/Z03-43/93104/row/legals/2WDV