

SITUATED IN
NORTHEAST AND NORTHWEST QUARTERS OF
SECTION 13, T-2, R-5, UNITED STATES MILITARY
LANDS, HIGHLAND TOWNSHIP, MUSKINGUM COUNTY,
OHIO.

PARCEL NUMBER
 PART OF: 23-50-13-06-000 ±6.670 AC.
 PART OF: 23-50-13-09-000 ±1.939 AC.
 PART OF: 23-50-13-10-000 ±5.335 AC.
 PART OF: 23-50-13-14-000 ±34.825 AC.

BASIS OF BEARINGS
BEARINGS ARE BASED ON NAD 83, OHIO
STATE PLANE COORDINATE SYSTEM, SOUTH
ZONE (GRID), AS PER GPS OBSERVATIONS
MADE ON MARCH 10, 2022.

LEGEND
 ● IRON PIN SET, 5/8" REBAR W/CAP #7113
 ☒ STONE FOUND
 ● IRON PIN FOUND
 P.O.B. PLACE OF BEGINNING
 P.P.O.B. PRINCIPAL PLACE OF BEGINNING

REFERENCES
AS SHOWN ON PLAT.
ORIGINAL SURVEY OF T-2, R-5.

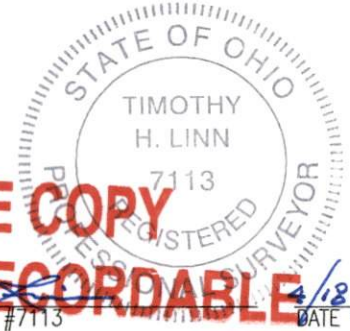

**OFFICE COPY
NOT RECORDABLE** 4/8/22
TIMOTHY H. LINN, PS #7113 DATE

- NOTES**
1. APPROXIMATE END OF TOWNSHIP MAINTAINED McCULLEY LANE.
 2. THE RIGHT OF WAY OF McCULLEY LANE (TR-488) RUNS THROUGH TO SWITZER LANE (TR-488). THE COUNTY HAS NO RECORD OF THE AREA BETWEEN THE ROADS AS BEING VACATED.
 3. AN INGRESS/EGRESS EASEMENT IS RESERVED WITHIN THE RIGHT OF WAY OF McCULLEY LANE.

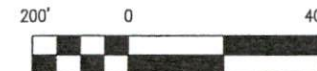

Linn Engineering, Inc. 740-452-7434
Civil Engineering Consultants
P.O. Box 2086 Zanesville, Ohio 43702-2086