

KEVIN CANNON SURVEYING
7945 TWP. RD. 114 NE
NEW LEXINGTON, OHIO 43764

Situated in the State of Ohio, County of Muskingum, Township of Hopewell, T- 1, R- 9, being a part of Verne B. & Dorothy A. Tom Vol. 1195 Pg. 425 & Vol. 419 Pg. 169, being a part of Sections 19 & 22 , and more particularly described as follows:

Beginning at a stone found at the Northwest Corner of the Southeast Quarter of Section 19; thence South 19 Degrees 23 Minutes 10 Seconds East 2281.55 feet to a point in the centerline of Co. Rd. 92 (Sand Ridge Rd.); thence leaving said centerline South 03 Degrees 24 Minutes 00 Seconds West 599.11 feet to an iron pin found, passing an iron pin set at 48.87 feet and the North Line of Section 22 at 532.11 feet; thence North 89 Degrees 27 Minutes 35 Seconds East 457.38 feet to an iron pin set and the place of beginning, thence North 03 Degrees 24 Minutes 00 Seconds East 574.84 feet to an iron pin set; thence North 44 Degrees 15 Minutes 37 Seconds East 208.71 feet to a iron pin found; thence North 45 Degrees 42 Minutes 03 Seconds West 25.00 feet to an axle found; thence North 44 Degrees 08 Minutes 21 Seconds East 208.67 feet to an axle found; thence North 45 Degrees 46 Minutes 11 Seconds West 208.70 feet to a point in the centerline of Co. Rd. 92, passing an axle found at 188.70 feet; thence along said centerline the next 3 courses to points: North 43 Degrees 54 Minutes 56 Seconds East 207.05 feet; thence North 54 Degrees 28 Minutes 59 Seconds East 134.54 feet; thence North 66 Degrees 01 Minutes 23 Seconds East 117.69 feet; thence leaving said centerline South 03 Degrees 21 Minutes 36 Seconds West 1709.75 feet to an iron pin set, passing an iron pin set at 19.65 feet and the North Line of Section 22 at 1302.82 feet; thence South 87 Degrees 06 Minutes 25 Seconds East 200.00 feet to an iron pin set; thence South 03 Degrees 21 Minutes 36 Seconds West 815.00 feet to an iron pin set; thence North 87 Degrees 06 Minutes 25 Seconds West 465.46 feet to an iron pin set; thence North 03 Degrees 21 Minutes 36 Seconds East 1199.50 feet to an iron pin set; thence South 89 Degrees 27 Minutes 35 Seconds West 175.50 feet to the place of beginning, passing an iron pin found at 112.40 feet , containing 21.344 acres Total, being 3.742 acres in Vol. 419 Pg. 169 (all of parcel # 25-55-22-02-000), being 7.574 acres in Vol. 1159 Pg. 425 (part of parcel # 25-55-22-03-000), being 10.028 acres in Vol. 419 Pg. 169 (part of parcel # 25-35-19-11-000), being 10.028 acres in Section 19 and 11.316 acres in Section 22, more or less, subject to all legal highways and easements.

DESCRIPTION
APPROVED
By:  6/30/2014

Excepting the following existing 25.00' easement, whose centerline is described as follows:

Beginning at a stone found at the Northwest Corner of the Southeast Quarter of Section 19; thence South 19 Degrees 23 Minutes 10 Seconds East 2281.55 feet to a point in the centerline of Co. Rd. 92 (Sand Ridge Rd.); thence leaving said centerline South 03 Degrees 24 Minutes 00 Seconds West 599.11 feet to an iron pin found, passing an iron pin set at 48.87 feet and the North Line of Section 22 at 532.11 feet; thence North 89 Degrees 27 Minutes 35 Seconds East 457.38 feet to an iron pin set, thence North 03 Degrees 24 Minutes 00 Seconds East 574.84 feet to an iron pin set; thence North 44 Degrees 15 Minutes 37 Seconds East 107.60 feet to a point in the centerline of an existing 25' easement and the place of beginning; thence along said easement the next 3 courses to points: South 02 Degrees 05 Minutes 12 Seconds West 224.74 feet; thence South 22 Degrees 13 Minutes 52 Seconds West 223.53 feet; thence South 03 Degrees 54 Minutes 00 Seconds West 219.88 feet.

See plat attached.

Subject to Co. Rd. 92 (Sand Ridge Rd.) R/W.

Iron pins set are 5/8 inch rebar 30 inches long, with plastic ID caps.

Bearings are based on the Ohio State Plane Coordinate System (South Zone).

This description was written from a survey made by Kevin Cannon PS 7224, May 29, 2014.

OFFICE COPY
NOT RECORDABLE

KEVIN CANNON
REG. NO. 7224



7945 TWP. RD. 114 NE
New Lexington, Ohio 43764
(740) 342 - 2835

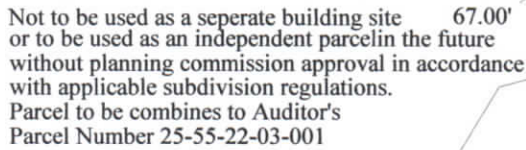

DESCRIPTION
APPROVED
By: *[Signature]* 6/30/2014
21.344 ac. only

- Iron Pin Set 5/8" Rebar, 30" Long
With Plastic ID Cap # 7224
- Iron Pin Found
- ▲ Railroad Spike Set
- △ Railroad Spike Found
- Stone Found
- ⊗ Post
- x—x— Fence
- Basis of Bearings

A circular professional seal for Kevin Cannon, a Registered Professional Surveyor in the State of Ohio. The seal features the text "STATE OF OHIO" at the top, "KEVIN CANNON" in the center, "7224" below the name, and "REGISTERED PROFESSIONAL SURVEYOR" at the bottom. Two stars are positioned on the left and right sides of the seal.