

Survey Split of Gregory A. Hilty Lands in Licking Township, Muskingum County

Situated in the State of Ohio, County of Muskingum, Township of Licking, and being part of Quarter Township 1, Township 2, Range 9, United States Military Lands, and being part of the lands presently owned by Gregory A. Hilty, as per Official Record 2927, Page 523, and being more particularly described as follows:

Beginning for reference at a point on the Southwest Corner of Section 6, Township 2, Range 8, United States Military Lands, from which an iron pin found bears North 88 degrees 04 minutes 04 seconds West, 20.67 feet;

Thence along the line between Muskingum, and Licking Township, the following three courses:

- 1.) North 02 degrees 02 minutes 30 seconds East, 340.13 feet to an iron pin found;
- 2.) North 01 degrees 54 minutes 52 seconds East, 339.99 feet to an iron pin found;
- 3.) North 01 degrees 54 minutes 52 seconds East, 419.88 feet to a point in Cranberry Lane, (Twp. Rd. 607, R\W 40'), and the northeast corner of lands presently owned by Christine A. Bradley, (OR 2352-890), and the principal place of beginning;

Thence along the north line of said Bradley lands, North 86 degrees 58 minutes 56 seconds West, 693.12 feet to an iron pin set, passing iron pins found at 3.42 feet, and 633.12 feet;

Thence through the lands presently owned by Gregory A. Hilty, (OR 2927-523), the following three courses:

- 1.) North 03 degrees 01 minutes 04 seconds East, 60.00 feet to an iron pin set;
- 2.) South 89 degrees 30 minutes 14 seconds East, 148.49 feet to an iron pin set;
- 3.) North 66 degrees 57 minutes 32 seconds East, 599.34 feet to a point on the township line, and in said Cranberry Lane, passing an iron pin set at 575.00 feet;

Thence along the township line, South 01 degrees 54 minutes 52 seconds West, 329.88 feet to the principal place of beginning, containing 2.69 acres, more or less, and being part of Auditor's Parcel Number 35-10-71-19-004.

Subject to all legal recorded easements and right of ways.

Iron pins set are 5/8 inch rebars, 30 inches long, with plastic identification caps.

Bearings are based on the Ohio State Plane Coordinate System, NAD 83, South Zone, Grid North as per GPS observations.

This description is written based on a field survey completed Sept. 19, 2022, by Jack D. Newcome, Reg. No. 7321.

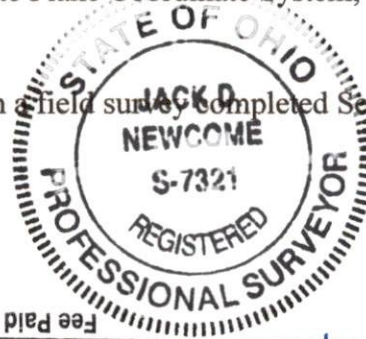

OFFICE COPY
NOT RECORDABLE

Jack D. Newcome, Reg. No. 7321

Fee Paid

Date 9-26-22

Date 9/27/22

APPROVED
MUSKINGUM COUNTY
PLANNING COMMISSION DIRECTOR

DESCRIPTION
APPROVED
By: [Signature] 9-28-2022