

SITUATED IN:

State of Ohio, County of Muskingum, Township of Monroe,
Being part of the Northeast Quarter of Section 22, Township
3, Range 5, United States Military Lands

BASIS OF BEARINGS

Bearings are based on the Ohio State Plane Coordinate System,
NAD 83(2011), South Zone, Grid North, as per GPS observations

Henry F. and Mable J.
Hershberger
OR 3139-13
Parcel No.
42-90-22-05-000

Henry F. and Mable J.
Hershberger
OR 3139-13
±4.70 Acres

David F. and Arlene A.
Hershberger
OR 3138-909

Part of Parcel No.
42-90-22-05-000
±4.70 Acres
(±0.05 Ac. in R/W Co Rd. 101)

APPROVED
MUSKINGUM COUNTY
PLANNING COMMISSION DIRECTOR

DATE

William C. and
Bobbi J. McCort
OR 2734-428
Parcel No.
42-90-22-05-001

LEGEND

- Iron Pin Set 5/8" rebar
- Iron Pin Found
- Stone Found
- ▲ Railroad Spike Found
- ⊗ PK Nail Found

REFERENCES

-www.mceo.org
-Survey by Dan Newcome
-Survey by Brian McPeck
-All deed Ref. shown on
this plat

DESCRIPTION

APPROVED

By: *[Signature]*

OFFICE COPY

[Signature] 3-19-24
Jack D. Newcome Date

Reg. Surveyor No. 7321

0 100 200



Graphic Scale in feet: 1" = 100'

Newcome Surveying Company
6515 Ballard Road
Nashport, Ohio 43830
740-452-5796

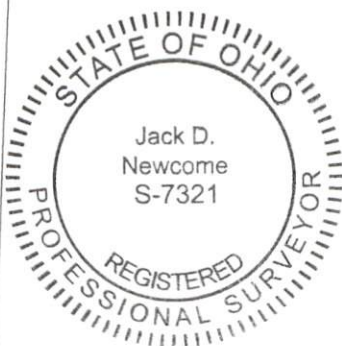

SW Cor., NE Qtr.,
Sec. 22, T-2 R-5,
U.S.M.L.

Lookout Road (Co. Rd. 101)
R/W 40'

P.O.B.

Qtr. Sec. Line