



www.mcpeeklandsurveying.com
 email: brian@mcpeeklandsurveying.com
 340 Robin Hood Ln., * Zanesville, Oh 43701 * 740.704.6073

Daniel A. Norris & Alecia K. Norris
DR 1071-607
+/- 1.129 Acres

Situated in the State of Ohio, County of Muskingum, Township of Muskingum, being part of the northwest quarter of Section 22, T2, R8 and being all of the lands now owned by Daniel A. Norris & Alecia K. Norris (DR 1071-607) and more particularly described as follows.

Beginning for reference at a point, the southeast corner of the northwest quarter of said Section 22, thence with the mid-section line, N 87°33'21" W a distance of 441.62 feet to a point in the road bed of Richvale Road (CR-3) and the principal place of beginning.

thence continuing with said mid-section line, N 87°33'21" W a distance of 103.40 feet to a point, said point being in the road bed of said Richvale Road and also being the southeast corner of the land now owned by Muskingum Valley Park District (OR 2125-802);

thence leaving said mid-section line and going with the common line of said Norris/Muskingum Valley Park District the following two (2) courses:

1. N 02°14'56" E a distance of 474.87 feet to a pipe found, passing an iron pin set at 15.00 feet;
2. S 88°21'31" E a distance of 103.41 feet to a pipe found on the northwest corner of the lands now owned by Donald F. Wagner (DR 1157-775);

thence with the common line of said Norris/Wagner, S 02°14'56" W a distance of 476.32 feet to the place of beginning, passing an axle found at 467.40 feet, containing a total of +/-1.129 acres more or less, subject to all legal highways and easements of record.

All bearings described herein are based on the Ohio State Plane Grid Coordinates, NAD83, Ohio South per GPS Observation.

All iron pins set are 5/8 inch by 30 inch steel rebar with plastic identification caps marked MCPEEK PS8517.

The above described 1.129 acre tract is based on a field survey made by McPeek Land Surveying, LLC on April 25th, 2018.

OFFICE COPY
NOT RECORDABLE
 Brian Kelly McPeek, PS 8517

4/26/18
 Date

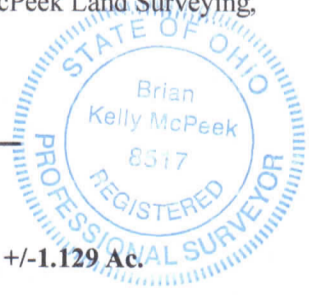

Parcel No.

All of: 44-48-01-14-000 (+/-0.646 Ac) & 44-48-01-13-000 (+/-0.483 ac.) **Totaling +/-1.129 Ac.**

DESCRIPTION
 APPROVED
 By: *[Signature]*

SITUATED IN

The State of Ohio, County of Muskingum, Township of Muskingum,
NW Quarter of Sec. 22, T2, R8, United States Military Lands

BASIS OF BEARING

Bearings are based on State Plane Grid Coordinates,
NAD83, Ohio South, per GPS Observation.



44-48-01-15-000
MUSKINGUM VALLEY PARK DISTRICT
OR 2125-802

S 88°21'31" E
103.41'

S 88°21'31" E 434.27'

DESCRIPTION
APPROVED
By: *[Signature]*

REFERENCES

* As Noted on Plat
www.muskingumcountyauditor.org
www.mceo.org
<http://recorder.muskingumcounty.org>

All of: 44-48-01-14-000
±0.646

Daniel A. Norris &
Alecia K. Norris
DR 1071-607
±1.129 Ac.

44-48-01-15-000
MUSKINGUM VALLEY PARK DISTRICT
OR 2125-802

N 02°14'56" E
474.87'

S 02°14'56" W
476.32'

44-48-01-12-000
DONALD F. WAGNER
DR 1157-775

LEGEND

- Iron Pin Set, 5/8" rebar
- Iron Pin Found
- Pipe Found
- Z— Property Hook
- Axle Found

All of: 44-48-01-13-000
±0.483

○ 15.00'

● 467.40'

N 87°33'21" W
103.40'

mid-section line
N 87°33'21" W 441.62'

RICHVALE ROAD (CR-3)



GRAPHIC SCALE

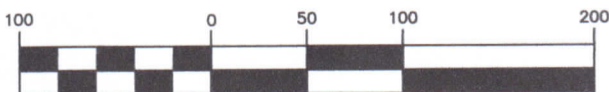

(IN FEET)

1 inch = 100 ft.

OFFICE COPY
NOT RECORDABLE
[Signature]
Date: 4/26/16
Reg. Surveyor No. 8517

This plat was prepared by McPeek Land Surveying, LLC
in accordance with Chapter 4733-37 of the Administrative Code,
and is intended to be used for the legal transfer of the property
described and does not intend to describe all or any easements of
record, nor encroachments unless otherwise intended.

**MCPEEK
LAND
SURVEYING** LLC

www.mcpeeklandsurveying.com
email: brian@mcpeeklandsurveying.com
340 Robin Hood Ln., * Zanesville, Oh 43701 * 740.704.6073