

47-70-20-15-002 B

Bearings are based on Ohio State Plane Coordinate System, NAD 83, South Zone, Grid North, as per GPS observations made on November 8, 2018.

This description is written based on a survey completed January 12, 2021 by Timothy H. Linn, Reg. No. 7113.

OFFICE COPY
NOT RECORDABLE

Timothy H. Linn, PS, Reg. No. 7113

1/15/21
Date

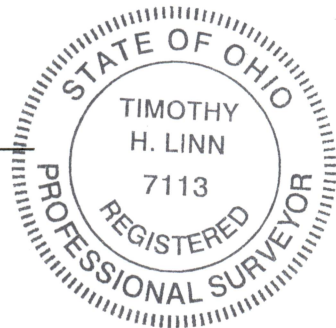

Parcel No.:

Part of: 47-70-20-15-000 +/- 137.500 ac.

DESCRIPTION
APPROVED
By: Mr. H. Linn

APPROVED
MUSKINGUM COUNTY
PLANNING COMMISSION DIRECTOR

1/20/21
Date

Fee Paid