

### Survey for M. Strokes

Being a part of land located in the State of Ohio, County of Muskingum, Township of Perry, and being part of the northwest quarter of quarter township 3, Township 1 North, Range 6 West, United States Military Lands, bounded and described as follows:

**Beginning** at an iron pin set 40.00 feet right of County Road 52 (Sonora Road) centerline station 46+00, (MUS-40-14.09, page 19), being on the right of way of Interstate 70;

thence along Interstate 70 right of way North 30 degrees 44 minutes 06 seconds West 59.08 feet to an iron pin set, being on the north line of M. Strokes (DR 463-584);

thence leaving the Interstate 70 right of way and along the north line of M. Strokes (DR 463-584) North 87 degrees 44 minutes 05 seconds East 309.73 feet to an iron pin set, being the southwest corner of Buckeye Supply (DR 824-17);

thence continuing along the north line of M. Strokes (DR 463-584) North 87 degrees 44 minutes 05 seconds East 757.17 feet to an iron pin set, being the northwest corner of Zanesville-Muskingum Port Authority (OR 1138-700);

thence leaving the north line of M. Strokes (DR 463-584) and along the west line of Zanesville-Muskingum Port Authority (OR 1138-700) South 04 degrees 34 minutes 58 seconds East 314.90 feet to a point on the Interstate 70 limited access right of way, said point being South 48 degrees 54 minutes 44 seconds East 3.05 feet from an iron pin found;

thence along the Interstate 70 limited access right of way South 88 degrees 41 minutes 36 seconds West 48.15 feet to an iron pin set;

thence along the Interstate 70 right of way the following five courses:

1. North 66 degrees 18 minutes 09 seconds West 291.03 feet to an iron pin set;
2. North 89 degrees 24 minutes 48 seconds West 186.21 feet to an iron pin set;
3. North 89 degrees 07 minutes 59 seconds West 303.71 feet to an iron pin set;
4. North 80 degrees 33 minutes 55 seconds West 146.66 feet to an iron pin set;
5. North 56 degrees 19 minutes 21 seconds West 134.40 feet to the principal place of beginning, containing 4.48 acres, more or less.

**SUBJECT TO** the following two roadway easements;

#### Roadway Easement #1

Commencing at an iron pin set 40.00 feet right of County Road 52 (Sonora Road) centerline station 46+00, (MUS-40-14.09, page 19), being on the right of way of Interstate 70;

thence along Interstate 70 right of way North 30 degrees 44 minutes 06 seconds West 59.08 feet to an iron pin set, being on the north line of M. Strokes (DR 463-584);

thence leaving the Interstate 70 right of way and along the north line of M. Strokes (DR 463-584) North 87 degrees 44 minutes 05 seconds East 309.73 feet to an iron pin set, being the southwest corner of Buckeye Supply (DR 824-17);

thence continuing along the north line of M. Strokes (DR 463-584) North 87 degrees 44 minutes 05 seconds East 406.02 feet to the place of beginning for this easement;

thence continuing along the north line of M. Strokes (DR 463-584) North 87 degrees 44 minutes 05 seconds East 118.83 feet;

thence South 15 degrees 58 minutes 45 seconds East 37.25 feet;

thence South 05 degrees 34 minutes 32 seconds West 176.02 feet to a point on the Interstate 70 right of way;

thence along the Interstate 70 right of way North 66 degrees 18 minutes 09 seconds West 55.14 feet to an iron pin set;

thence continuing along the Interstate 70 right of way North 89 degrees 24 minutes 48 seconds West 115.00 feet;

thence leaving the Interstate 70 right of way North 16 degrees 19 minutes 36 seconds East 190.65 feet to the place of beginning for this roadway easement, containing 0.65 acres, more or less.

#### Roadway Easement #2

Commencing at an iron pin set 40.00 feet right of County Road 52 (Sonoma Road) centerline station 46+00, (MUS-40-14.09, page 19), being on the right of way of Interstate 70;

thence along Interstate 70 right of way North 30 degrees 44 minutes 06 seconds West 59.08 feet to an iron pin set, being on the north line of M. Strokes (DR 463-584);

thence leaving the Interstate 70 right of way and along the north line of M. Strokes (DR 463-584) North 87 degrees 44 minutes 05 seconds East 309.73 feet to an iron pin set, being the southwest corner of Buckeye Supply (DR 824-17);

thence continuing along the north line of M. Strokes (DR 463-584) North 87 degrees 44 minutes 05 seconds East 675.96 feet to the place of beginning for this easement;

thence continuing along the north line of M. Strokes (DR 463-584) North 87 degrees 44 minutes 05 seconds East 81.21 feet to an iron pin set, being the northwest corner of Zanesville-Muskingum Port Authority (OR 1138-700);

thence leaving the north line of M. Strokes (DR 463-584) and along the west line of Zanesville-Muskingum Port Authority (OR 1138-700) South 04 degrees 34 minutes 58 seconds East 243.63 feet;

thence leaving the west line of Zanesville-Muskingum Port Authority (OR 1138-700) North 28 degrees 12 minutes 07 seconds West 17.68 feet;

thence North 24 degrees 12 minutes 54 seconds West 128.76 feet;

thence North 22 degrees 51 minutes 41 seconds West 50.19 feet;

thence North 18 degrees 16 minutes 36 seconds West 63.59 feet to the place of beginning for this **roadway easement**, containing 0.25 acres, more or less.

Iron pins set are 5/8 inch rebar 30 inches long with identification caps (SWIERZ 8062). This legal description was prepared by Denis P. Swierz Reg. Surv. No. 8062, based on a field survey made September 10, 2002.

Subject to all easements, right of ways, restrictions, reservations, etc.. of record and those that may be implied.

Part of Parcel No. 51-51-30-03-16-000 (+4.48 acres)

Denis P. Swierz  
Reg. Surv. No. 8062

\_\_\_\_\_  
Date

DESCRIPTION APPROVED  
FOR AUDITOR'S TRANSFER

BY A. L. Swiercz  
10-1-2002 KA

OFFICE COPY  
NOT RECORDABLE

SOMERS ROAD (CR 52)

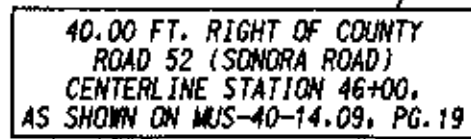

OFFICE COPY  
NOT RECORDABLE

DENIS P. S. ERZ  
P5# 6042

DATE:

## **All American Way and Coachmen Drive Road Dedication**

Being a part of land located in the State of Ohio, Muskingum County, Perry Township, and part of the northwest quarter of Quarter Township 3, Township 1 North, Range 6 West, United States Military Lands.

Being part of the lands conveyed to C.P.'s Lawncare, LLC. in Deed Record 2611, page 820 and NORMAR Enterprises, LLC. in Deed Record 2748, page 373, bounded and described as follows:

**Commencing** at a point 40.00 feet right of Sonora Road (County Road 52) centerline station 46+00 (MUS-40-14.09, Pg.19)  
thence North 26 degrees 13 minutes 10 seconds West 59.08 feet to a point;  
thence South 87 degrees 44 minutes 59 seconds East 309.84 feet to an iron pin found, being the southwest corner of NORMAR Enterprises (DR 2748-373);  
thence continuing South 87 degrees 44 minutes 59 seconds East along the south line of NORMAR Enterprises (DR 2748-373) 462.34 feet to an iron pin set, the **place of beginning** for this road dedication;

thence through NORMAR Enterprises (DR 2748-373) the following three courses:

1. North 11 degrees 02 minutes 00 seconds East 265.92 feet to an iron pin set;
2. On a curve to the right having a radius of 150.00 feet, a delta angle of 57 degrees 43 minutes 52 seconds, a chord bearing and distance of North 35 degrees 08 minutes 38 seconds East 151.14 feet to an iron pin set on the west line of Frueh Enterprises, Inc. (DR 2759-531);
3. Along the west line of Frueh Enterprises, Inc. (DR 2759-531) South 21 degrees 34 minutes 05 seconds East 426.00 feet to an iron pin found on the northeast corner of C.P.'s Lawncare, LLC., (DR 2611-820);

thence along the east line of C.P.'s Lawncare, LLC., (DR 2611-820) South 00 degrees 04 minutes 02 seconds East 243.63 feet to an iron pin set;

thence leaving the east line of C.P.'s Lawncare, LLC., (DR 2611-820) and through C.P.'s Lawncare, LLC., (DR 2611-820) the following four courses:

1. North 23 degrees 41 minutes 11 seconds West 17.68 feet to an iron pin set;
2. North 19 degrees 41 minutes 58 seconds West 128.76 feet to an iron pin set;
3. North 18 degrees 20 minutes 44 seconds West 50.19 feet to an iron pin set;
4. North 13 degrees 45 minutes 40 seconds West 63.59 feet to an iron pin found on the south line of NORMAR Enterprises (DR 2748-373);

thence along the south line of NORMAR Enterprises (DR 2748-373) North 87 degrees 44 minutes 59 seconds West 64.77 feet to an iron pin set;

thence leaving the south line of NORMAR Enterprises (DR 2748-373) and through C.P.'s Lawncare, LLC., (DR 2611-820) the following six courses:

1. South 11 degrees 02 minutes 00 seconds West 174.62 feet to an iron pin set;
2. South 31 degrees 23 minutes 31 seconds West 67.57 feet to an iron pin set on the north right-of-way of Sonora Road (County Road 52);
3. Along the north right-of-way of Sonora Road (County Road 52) North 61 degrees 44 minutes 17 seconds West 103.12 feet to an iron pin set;
4. Along the north right-of-way of Sonora Road (County Road 52) North 84 degrees 53 minutes 52 seconds West 49.10 feet to an iron pin set;
5. Leaving the north right-of-way of Sonora Road (County Road 52) North 29 degrees 41 minutes 08 seconds East 74.54 feet to an iron pin set;
6. North 11 degrees 02 minutes 00 seconds East 119.17 feet to the place of beginning, containing 2.496 acres, more or less.

Part of Parcel No.: 51-51-30-03-16-020 ( $\pm$  0.956 acres)

Part of Parcel No.: 51-51-30-03-17-000 (+ 1.540 acres)

TOTAL  $\pm$ 2.496 ACRES

This legal description was written by Denis P. Swierz based on a field survey completed December 2018 by Muskingum County Engineers' Office. The bearings in this description are based on Ohio South Zone, State Plane Coordinates, as per GPS Observations from NGS monument W 183 (JX 1424).

Subject to all easements, right of ways, restrictions, reservations, etc.. of record and those that may be implied.

Denis P. Swierz  
Reg. Surv. No. 8062

12/28/18  
Date



DESCRIPTION

APPROVED

By: 1/17/2019



1  
2

# ROAD DEDICATION PLAT FOR ALL AMERICAN WAY AND COACHMEN DRIVE

STATE OF OHIO, MUSKINGUM COUNTY, PERRY TOWNSHIP, PART OF THE NORTHWEST  
QUARTER OF QUARTER TOWNSHIP 3, TOWNSHIP 1 NORTH, RANGE 6 WEST,  
UNITED STATES MILITARY LANDS

PART OF PARCEL NOS.: 51-30-03-16-020 ±0.956 ACRES  
51-30-03-17-000 ±1.540 ACRES  
±2.496 ACRES

DESCRIPTION

APPROVED

By: M/S + JWH

## DEDICATION

NORMAR ENTERPRISES, LLC., HAS CAUSED ITS REAL ESTATE SHOWN  
TO BE SURVEYED AND PLATTED INTO THE ROAD AS SHOWN,  
AND HEREBY DEDICATES SUCH REAL ESTATE FOR ROAD PURPOSES,  
PURSUANT TO O.R.C. 5553.31.

NORMAR ENTERPRISES, LLC

BY \_\_\_\_\_  
MEMBER

## ACKNOWLEDGEMENT

STATE OF OHIO  
COUNTY OF MUSKINGUM

THE FOREGOING INSTRUMENT WAS ACKNOWLEDGED BEFORE ME THIS \_\_\_\_ DAY  
OF \_\_\_\_, 201\_\_ BY \_\_\_\_\_, MEMBER, ON BEHALF OF NORMAR  
ENTERPRISES, LLC., A LIMITED LIABILITY COMPANY.

## DEDICATION

C.P.'S LAWCARE, LLC., HAS CAUSED ITS REAL ESTATE SHOWN  
TO BE SURVEYED AND PLATTED INTO THE ROAD AS SHOWN,  
AND HEREBY DEDICATES SUCH REAL ESTATE FOR ROAD PURPOSES,  
PURSUANT TO O.R.C. 5553.31.

CP'S LAWCARE, LLC.

BY \_\_\_\_\_  
CHAD L. PARKER, MEMBER

## ACKNOWLEDGEMENT

STATE OF OHIO  
COUNTY OF MUSKINGUM

THE FOREGOING INSTRUMENT WAS ACKNOWLEDGED BEFORE ME THIS \_\_\_\_ DAY  
OF \_\_\_\_, 201\_\_ BY CHAD L. PARKER, MEMBER, ON BEHALF OF  
C.P.'S LAWCARE, LLC., A LIMITED LIABILITY COMPANY.

## DEDICATION

FRUEH ENTERPRISES, INC., AN OHIO CORPORATION, HAS CAUSED  
ITS REAL ESTATE SHOWN TO BE SURVEYED AND PLATTED INTO  
THE ROAD AS SHOWN, AND HEREBY DEDICATES SUCH REAL ESTATE  
FOR ROAD PURPOSES, PURSUANT TO O.R.C. 5553.31.

FRUEH ENTERPRISES, INC.

BY \_\_\_\_\_  
ADAM HOLMES, PRESIDENT

## ACKNOWLEDGEMENT

STATE OF OHIO  
COUNTY OF MUSKINGUM

THE FOREGOING INSTRUMENT WAS ACKNOWLEDGED BEFORE ME THIS \_\_\_\_ DAY  
OF \_\_\_\_, 201\_\_ BY ADAM HOLMES, PRESIDENT OF FRUEH  
ENTERPRISES, INC., AN OHIO CORPORATION, ON BEHALF OF THE  
CORPORATION.

## MUSKINGUM COUNTY AUDITOR'S OFFICE

TRANSFERRED DATE: \_\_\_\_\_

BY: \_\_\_\_\_

## MUSKINGUM COUNTY COMMISSIONERS

ACCEPTED AND APPROVED UNDER THE REVISED CODE OF THE  
STATE OF OHIO (O.R.C. 5553.31)

\_\_\_\_\_  
JAMES W. PORTER

\_\_\_\_\_  
CINDY S. CAMERON

\_\_\_\_\_  
MOLLIE CROOKS

DATE: \_\_\_\_\_

SUBMITTED FOR ACCEPTANCE AND APPROVAL

## MUSKINGUM COUNTY ENGINEER

ACCEPTED AND APPROVED UNDER THE REVISED CODE OF THE STATE OF OHIO  
(O.R.C. 5553.31)

\_\_\_\_\_  
MARK J. EICHER, P.E., P.S.  
COUNTY ENGINEER

\_\_\_\_\_  
DATE

\_\_\_\_\_  
CLERK OF COUNTY COMMISSIONERS

## CERTIFICATE OF SURVEYOR

DENIS P. SWIERZ, DOES HEREBY CERTIFY THAT THE WITHIN IS A CORRECT  
DEDICATION PLAT FOR ALL AMERICAN WAY AND COACHMEN DRIVE.,  
SAID ROADS BEING IN THE TOWNSHIP OF PERRY, COUNTY OF MUSKINGUM,  
STATE OF OHIO, AS SURVEYED BY HIM AND CONSISTS OF 2.496 ACRES,  
BEING A PART OF THE REAL ESTATE CONVEYED TO C.P.'S LAWCARE, LLC. IN  
DEED RECORD 2611, PAGES 820-823, NORMAR ENTERPRISES, LLC. IN  
DEED RECORD 2748, PAGES 373-374, AND FRUEH ENTERPRISES, INC. IN  
DEED RECORD 2759, PAGES 531-536.





# ROAD DEDICATION PLAT FOR ALL AMERICAN WAY AND COACHMEN DRIVE

2  
2

STATE OF OHIO, MUSKINGUM COUNTY, PERRY TOWNSHIP, PART OF THE  
NORTHWEST QUARTER OF QUARTER TOWNSHIP 3, TOWNSHIP 1 NORTH,  
RANGE 6 WEST, UNITED STATES MILITARY LANDS

RAD = 150.00 FT  
DELTA = 57°43'52"  
CHD BRG = N 35°08'38" E  
CHD = 151.14 FT

PART OF PARCEL NOS.:

51-30-03-16-020 ±0.956 ACRES  
51-30-03-17-000 ±1.540 ACRES  
±2.496 ACRES

NORMAR ENTERPRISES, LLC  
OR 2748-373  
51-30-03-17-000

FRUEH ENTERPRISES, INC.  
OR 2759-531  
51-30-03-17-001

DESCRIPTION  
APPROVED

By: *[Signature]*

40.00' RIGHT OF COUNTY  
ROAD 52 CENTERLINE  
STATION 46+00  
MUS-40-14.09, PG.19

CP'S LAWN CARE, LLC  
OR 2611-820  
51-30-03-16-020

## LINE TABLE

L1	N 26°13'10" W	59.08 FT
L2	S 87°44'59" E	309.84 FT
L3	S 87°44'59" E	462.34 FT
L4	N 23°41'11" W	17.68 FT
L5	N 18°20'44" W	50.19 FT
L6	N 13°45'40" W	63.59 FT
L7	N 87°44'59" W	64.77 FT
L8	S 31°23'31" W	67.57 FT
L9	N 61°44'17" W	103.12 FT
L10	N 84°53'52" W	49.10 FT
L11	N 29°41'08" E	74.54 FT
L12	N 11°02'00" E	119.17 FT
L13	S 87°44'59" E	23.30 FT
L14	S 87°44'59" E	125.44 FT
L15	S 87°44'59" E	81.21 FT

## BASIS OF BEARING:

BEARINGS SHOWN HEREON ARE BASED ON  
NAD83 (2011), OHIO SOUTH ZONE, STATE  
PLANE COORDINATES, AS PER GPS  
OBSERVATIONS FROM NGS  
MONUMENT W 183 (JX 1424).

## PERTINENT DOCUMENTS AND SURVEYS USED:

1. DEED REFERENCES SHOWN
2. TAX MAPS
3. SURVEY RECORDS FOUND IN THE MUSKINGUM  
COUNTY ENGINEERS OFFICE, ZANESVILLE, OHIO

MUSKINGUM COUNTY  
ENGINEER'S OFFICE  
155 REHL ROAD  
ZANESVILLE, OHIO 43701  
(740) 454-0155

I HERE BY CERTIFY THIS  
PLAT TO BE CORRECT

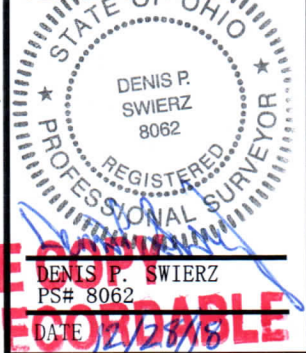

OFFICE COPY  
NOT RECORDABLE

100 0 100



Scale: 1" = 100'



ROAD DEDICATION PLAT FOR ALL AMERICAN WAY AND COACHMEN DRIVE

STATE OF OHIO, MUSKINGUM COUNTY, PERRY TOWNSHIP, PART OF THE NORTHWEST  
QUARTER OF QUARTER TOWNSHIP 3, TOWNSHIP 1 NORTH, RANGE 6 WEST,  
UNITED STATES MILITARY LANDS

PART OF PARCEL NOS.: 51-30-03-16-020 ±0.956 ACRES  
51-30-03-17-000 ±1.540 ACRES  
±2.496 ACRES

DEDICATION

NORMAR ENTERPRISES, LLC., HAS CAUSED ITS REAL ESTATE SHOWN TO BE SURVEYED AND PLATTED INTO THE ROAD AS SHOWN, AND HEREBY DEDICATES SUCH REAL ESTATE FOR ROAD PURPOSES, PURSUANT TO O.R.C. 5553.31.

NORMAR ENTERPRISES, LLC  
BY \_\_\_\_\_  
MEMBER

ACKNOWLEDGEMENT

STATE OF OHIO  
COUNTY OF MUSKINGUM  
THE FOREGOING INSTRUMENT WAS ACKNOWLEDGED BEFORE ME THIS \_\_\_\_ DAY OF \_\_\_\_\_, 201\_\_ BY \_\_\_\_\_, MEMBER, ON BEHALF OF NORMAR ENTERPRISES, LLC., A LIMITED LIABILITY COMPANY.

DEDICATION

C.P.'S LAWCARE, LLC., HAS CAUSED ITS REAL ESTATE SHOWN TO BE SURVEYED AND PLATTED INTO THE ROAD AS SHOWN, AND HEREBY DEDICATES SUCH REAL ESTATE FOR ROAD PURPOSES, PURSUANT TO O.R.C. 5553.31.

CP'S LAWCARE, LLC.  
BY \_\_\_\_\_  
CHAD L. PARKER, MEMBER

ACKNOWLEDGEMENT

STATE OF OHIO  
COUNTY OF MUSKINGUM  
THE FOREGOING INSTRUMENT WAS ACKNOWLEDGED BEFORE ME THIS \_\_\_\_ DAY OF \_\_\_\_\_, 201\_\_ BY CHAD L. PARKER, MEMBER, ON BEHALF OF C.P.'S LAWCARE, LLC., A LIMITED LIABILITY COMPANY.

DEDICATION

FRUEH ENTERPRISES, INC., AN OHIO CORPORATION, HAS CAUSED ITS REAL ESTATE SHOWN TO BE SURVEYED AND PLATTED INTO THE ROAD AS SHOWN, AND HEREBY DEDICATES SUCH REAL ESTATE FOR ROAD PURPOSES, PURSUANT TO O.R.C. 5553.31.

FRUEH ENTERPRISES, INC.  
BY \_\_\_\_\_  
ADAM HOLMES, PRESIDENT

ACKNOWLEDGEMENT

STATE OF OHIO  
COUNTY OF MUSKINGUM  
THE FOREGOING INSTRUMENT WAS ACKNOWLEDGED BEFORE ME THIS \_\_\_\_ DAY OF \_\_\_\_\_, 201\_\_ BY ADAM HOLMES, PRESIDENT OF FRUEH ENTERPRISES, INC., AN OHIO CORPORATION, ON BEHALF OF THE CORPORATION.

MUSKINGUM COUNTY AUDITOR'S OFFICE

TRANSFERRED DATE: \_\_\_\_\_  
BY: \_\_\_\_\_

MUSKINGUM COUNTY COMMISSIONERS

ACCEPTED AND APPROVED UNDER THE REVISED CODE OF THE  
STATE OF OHIO (O.R.C. 5553.31)

JAMES W. PORTER CINDY S. CAMERON MOLLIE CROOKS

DATE: \_\_\_\_\_  
SUBMITTED FOR ACCEPTANCE AND APPROVAL

CLERK OF COUNTY COMMISSIONERS

MUSKINGUM COUNTY ENGINEER

ACCEPTED AND APPROVED UNDER THE REVISED CODE OF THE STATE OF OHIO  
(O.R.C. 5553.31)

MARK J. EICHER, P.E., P.S.  
COUNTY ENGINEER

DATE: \_\_\_\_\_

CERTIFICATE OF SURVEYOR

DENIS P. SWIERZ, DOES HEREBY CERTIFY THAT THE WITHIN IS A CORRECT DEDICATION PLAT FOR ALL AMERICAN WAY AND COACHMEN DRIVE., SAID ROADS BEING IN THE TOWNSHIP OF PERRY, COUNTY OF MUSKINGUM, STATE OF OHIO, AS SURVEYED BY HIM AND CONSISTS OF 2.496 ACRES, BEING A PART OF THE REAL ESTATE CONVEYED TO C.P.'S LAWCARE, LLC. IN DEED RECORD 2611, PAGES 820-823, NORMAR ENTERPRISES, LLC. IN DEED RECORD 2748, PAGES 373-374, AND FRUEH ENTERPRISES, INC. IN DEED RECORD 2759, PAGES 531-536.

DESCRIPTION  
APPROVED  
By: \_\_\_\_\_

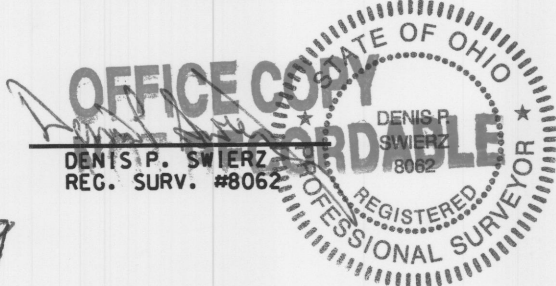

12/28/18  
DATE