

Baseline Surveying, Inc.

Land Surveying and Construction Layout

3010 East Pike
Zanesville, OH 43701

Email: bei@rohio.com
Telephone (740) 453-4850

THENCE LEAVING THE SAID RICHARDSON NORTH LINE AND TRAVERSING INTO THE ABOVE SAID JONES, MILLER, SMITH, KETTLEWELL, JONES AND JONES PARCEL, NORTH 12 DEGREES 14 MINUTES 30 SECONDS WEST 306.77 FEET TO THE PLACE OF BEGINNING;

CONTAINING 2.917 ACRES, SUBJECT TO ALL APPLICABLE EASEMENTS.

NOT TO BE USED AS A SEPARATE BUILDING SITE OR TRANSFERRED AS AN INDEPENDENT PARCEL IN THE FUTURE WITHOUT PLANNING COMMISSION APPROVAL IN ACCORDANCE WITH APPLICABLE SUBDIVISION REGULATIONS.

ALL IRON PINS SET ARE 5/8 INCH X 30 INCH REBAR WITH PLASTIC IDENTIFICATION CAPS (BASELINE PS6923-PS8536).

BEARINGS ARE BASED ON OHIO STATE PLANE COORDINATE SYSTEM 1983 (2011), OHIO SOUTH ZONE, GRID, DERIVED FROM A GPS OBSERVATION

I, JASON LEACHMAN, PS 8536, HEREBY CERTIFY TO THE BEST OF MY KNOWLEDGE AND BELIEF THE SURVEY AND DESCRIPTION TO BE CORRECT AS PREPARED BY ME, THIS 22ND DAY OF FEBRUARY 2022, FROM A FIELD SURVEY COMPLETED ON THE 21ST DAY OF FEBRUARY 2022.

**OFFICE COPY
NOT RECORDABLE**

JASON LEACHMAN
PROFESSIONAL SURVEYOR 8536

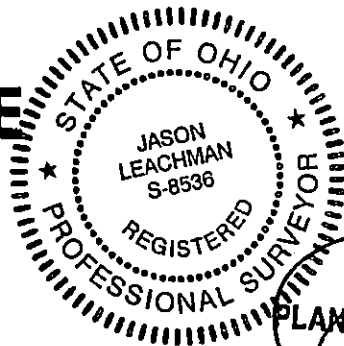

DESCRIPTION
APPROVED

By: As 3/4/22

