

Baseline Surveying, Inc.

Land Surveying and Construction Layout

3010 East Pike
Zanesville, OH 43701

Email: bei@rroho.com
Telephone (740) 453-4850

AUDREA R. & DENISE A. CRAWFORD
AUDITORS PARCEL NUMBER
66-20-09-37-000 (PART)

BEING A PART OF THE PARCEL CONVEYED TO AUDREA R. AND DENISE A. CRAWFORD IN O.R. VOLUME 3010, PAGE 840 OF THE MUSKINGUM COUNTY OFFICIAL RECORDS, SITUATED IN THE NORTHEAST QUARTER OF SECTION 9, TOWNSHIP 1, RANGE 5, OF THE UNITED STATES MILITARY LANDS, VILLAGE OF NEW CONCORD, UNION TOWNSHIP, MUSKINGUM COUNTY, OHIO AND BEING FURTHER DESCRIBED AS FOLLOWS:

COMMENCING AT THE NORTHEAST CORNER OF SECTION 9;

THENCE WITH THE EAST LINE OF THE SAID NORTHEAST QUARTER, SOUTH 01 DEGREES 50 MINUTES 41 SECONDS WEST 444.51 FEET (CALCULATED/PREVIOUS BIEDENBACH SURVEY) TO AN EXISTING IRON PIN (1/2 INCH PIPE) AT THE NORTHEAST CORNER OF THE ABOVE SAID CRAWFORD PARCEL (SOUTHEAST CORNER OF A PARCEL CONVEYED TO PAUL D. DAVIS IN O.R. VOLUME 2358, PAGE 412-TRACT 3), SAID IRON PIN BEING THE **PLACE OF BEGINNING** OF THE PARCEL HEREIN INTENDED TO BE DESCRIBED;

THENCE CONTINUING WITH THE SAID SECTION LINE (WEST LINE OF A PARCEL CONVEYED TO PAUL D. DAVIS IN O.R. VOLUME 2358, PAGE 412-TACT 6), SOUTH 01 DEGREES 50 MINUTES 41 SECONDS WEST 104.92 FEET TO AN EXISTING IRON PIN (3/4 INCH PIPE);

THENCE LEAVING THE SAID SECTION LINE AND TRAVERSING THROUGH THE ABOVE SAID CRAWFORD PARCEL, NORTH 57 DEGREES 13 MINUTES 07 SECONDS WEST 215.25 FEET TO AN EXISTING IRON PIN (3/4 INCH PIPE) ON THE EAST LINE OF RESERVOIR ROAD (FORMERLY TOWNSHIP ROAD 614-OLD RIX MILLS ROAD);

THENCE WITH THE EAST LINE OF THE SAID ROAD, NORTH 32 DEGREES 46 MINUTES 29 SECONDS EAST 90.00 FEET TO AN EXISTING IRON PIN (1/2 INCH PIPE), AT THE SOUTHWEST CORNER OF THE ABOVE SAID PAUL D. DAVIS PARCEL (O.R. VOLUME 2358, PAGE 412-TRACT 3);

THENCE WITH THE SOUTH LINE OF THE SAID DAVIS PARCEL, SOUTH 57 DEGREES 12 MINUTES 59 SECONDS EAST 161.32 FEET TO THE **PLACE OF BEGINNING**.

CONTAINING 0.389 ACRES FROM AUDITOR'S PARCEL NUMBER 66-20-09-37-000. SUBJECT TO ALL APPLICABLE EASEMENTS.

ALL IRON PINS SET ARE 5/8 INCH X 30 INCH REBAR WITH PLASTIC IDENTIFICATION CAPS (BASELINE PS6923-PS8536).

BEARINGS ARE BASED ON OHIO STATE PLANE COORDINATE SYSTEM 1983 (2011), OHIO SOUTH ZONE, GRID, DERIVED FROM A GPS OBSERVATION

I, MICHAEL D. NICHOLS, PS 6923, HEREBY CERTIFY TO THE BEST OF MY KNOWLEDGE AND BELIEF THE SURVEY AND DESCRIPTION TO BE CORRECT AS PREPARED BY ME, THIS 6TH DAY OF MAY 2022 FROM A FIELD SURVEY COMPLETED ON THE 28TH DAY OF APRIL 2022.

**OFFICE COPY
NOT RECORDABLE**

MICHAEL D. NICHOLS
PROFESSIONAL SURVEYOR 6923
6589 CRAWFORD

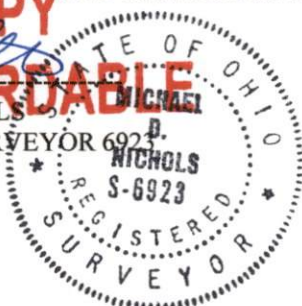

**DESCRIPTION
APPROVED**

By: DMP 5/16/2022